

# Product datasheet

Specifications



## Connection, PrismaSeT P, copper joint on profile Linergy vertical LGYE 2500A for connection NW

LVS04685

EAN Code: 3606481868091

**Price: 133,00 EUR**

### Main

Range	Linergy
Range of product	Linergy
Product or component type	Connection
Product name	Linergy LGYE
product name	PrismaSeT PrismaSeT P enclosure Masterpact MasterPact NW Linergy Linergy LGYE busbar
Accessory / separate part category	Coupling accessory
Standards	IEC 61439-2, inside enclosure IEC 61439-1, inside enclosure
Product certifications	ASTA

### Complementary

Cubicle-device connection	Linergy LGYE busbar
Poles description	1P
installation description	Cubicle - width 650 mm
Installed device	Masterpact: fixed NW20...25 vertical installation - bottom connection Masterpact: withdrawable NW20...25 vertical installation - bottom connection
[Ie] rated operational current	2500 A
Quantity per set	Set of 1

### Packing Units

Unit Type of Package 1	PCE
Number of Units in Package 1	1
Package 1 Height	9.5 cm
Package 1 Width	14.8 cm
Package 1 Length	23.0 cm
Package 1 Weight	2.01 kg
Unit Type of Package 2	P12
Number of Units in Package 2	50
Package 2 Height	40.0 cm
Package 2 Width	80.0 cm

Rates duty January 2016

---

Package 2 Length	120.0 cm
------------------	----------

---

Package 2 Weight	112.0 kg
------------------	----------

## Contractual warranty

---

Warranty (in months)	18
----------------------	----



## Environmental Data

Schneider Electric aims to achieve Net Zero status by 2050 through supply chain partnerships, lower impact materials, and circularity via our ongoing “Use Better, Use Longer, Use Again” campaign to extend product lifetimes and recyclability.

[Environmental Data explained >](#)

[How we assess product sustainability >](#)

### Environmental footprint

Total lifecycle Carbon footprint	50
Environmental Disclosure	<a href="#">Product Environmental Profile</a>

## Use Better

### Materials and Substances

Packaging made with recycled cardboard	Yes
Packaging without single use plastic	No
<a href="#">EU RoHS Directive</a>	Compliant
REACH Regulation	<a href="#">REACH Declaration</a>
Halogen-free status	Halogen free plastic parts product
PVC free	Yes
Silicone-free	Yes

## Use Again

### Repack and remanufacture

End of life manual availability	No need of specific recycling operations
Take-back	Yes
WEEE Label	 The product must be disposed on European Union markets following specific waste collection and never end up in rubbish bins

Technical Illustration

Dimensions

---

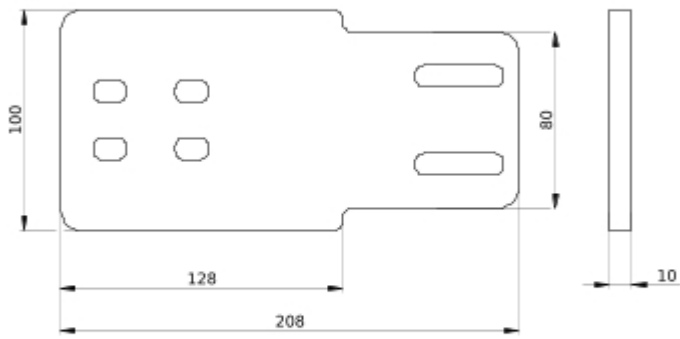

- All dimensions are approximate and are in mm  
- Also see technical documentation.