

Color: ■ black

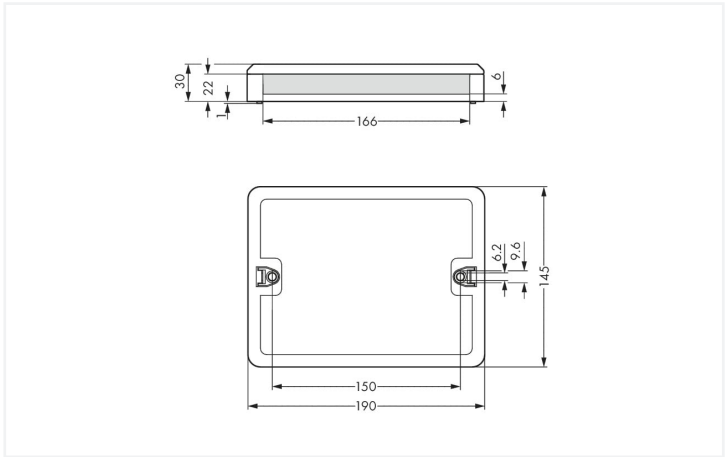

Dimensions in mm

Distribution box WINSTA® with protection against mismating

The distribution box from the WINSTA® product line with protection against mismating is the sophisticated solution for trouble-free electrical installation. An extensive range of accessories complements the WINSTA® product line from WAGO. For greater protection in electrical installations, the distribution box is provided with mechanical protection against mismating. The distribution box is protected against ingress by solid objects in accordance with protection type IP20 (When mated: IP2xC (These compact connectors are not designed for use in open, easily accessible areas!)). The WINSTA® distribution box with A coding in white or black is normally used for general mains applications in power distribution.

WINSTA® solutions for your electrical installation – protected against mismating and maintenance-free

The WINSTA® Pluggable Connection System is ideally tailored to the strict requirements of building installation. It makes electrical installation plug-gable, and consequently more efficient, more reliable, and error-free. Using this pre-assembled system decreases assembly times and errors during installation at the construction site. Now you can also reduce installation costs without compromising safety and quality: with protection against mismating eliminates the need for servicing and prevents unnecessary downtime.

- protection against mismating eliminates errors
- clear slot identification for easy commissioning
- products perfectly tailored to your requirements guarantee safe use
- suitable for any application
- rapid, structured electrical installation

Electrical data					General information	
Ratings per		IEC/EN 60664-1			Note on contact resistance	
Overvoltage category	III	III	II		approx. 1 mΩ contact resistance	
Pollution degree	3	2	2		approx. 0.25 mΩ contact transition (plug/ socket)	
Nominal voltage	250 V	-	-			
Rated surge voltage	4 kV	-	-			
Rated current	16 A	-	-			

Connection data				Connection 2	
Connection 1				Connection type	
Connection type 1		Input		Output	



Connection 3	
Connection type	Output

Physical data	
Width	190 mm / 7.48 inches
Height	30 mm / 1.181 inches
Depth	145 mm / 5.709 inches

Mechanical data	
Internal wiring	1.5 mm²
Use	Single-phase current (230 V)
Coding	A
Mounting type	Wall, screw mount Installation on mounting plate
Protection type	IP20; When mated: IP2xC (These compact connectors are not designed for use in open, easily accessible areas!)

Plug-in connection	
Mismating protection	Yes
Note on mismating protection	All WINSTA® components are 100% protected against mismating when: a.) plugging different numbers of poles b.) plugging while rotated 180 c.) plugging while laterally staggered d.) plugging one pole
Locking of plug-in connection	Locking lever

Material data	
Note (material data)	<a href="#">Information on material specifications can be found here</a>
Color	black
Insulation material (main housing)	Polyamide (PA66)
Flammability class per UL94	V0
Contact material	Copper or copper alloy; surface-treated
Contact Plating	Tin
Fire load	7.425 MJ
Weight	326.3 g

Environmental requirements	
Processing temperature	-5 ... +40 °C
Continuous operating temperature	-35 ... +85 °C
Note on continuous operating temperature	Insulating parts for temperatures ≤ 105 °C

Commercial data	
ETIM 9.0	EC002567
ETIM 8.0	EC002567
PU (SPU)	1 pcs
Packaging type	Box
Country of origin	DE
GTIN	4055143932097
Customs tariff number	85366990990

Environmental Product Compliance	
RoHS Compliance Status	Compliant,No Exemption

Downloads

Environmental Product Compliance

Compliance Search	
Environmental Product Compliance 899-631/477-000	

1 Compatible Products

1.1 System counterpart

1.1.1 Cable assembly

<a href="#">Item No.: 771-8992/006-101</a> pre-assembled interconnecting cable; Eca; Socket/plug; 2-pole; Cod. A; H05VV-F 2 x 1.5 mm²; 1 m; 1,50 mm²; black	<a href="#">Item No.: 771-9993/006-101</a> pre-assembled interconnecting cable; Eca; Socket/plug; 3-pole; Cod. A; H05VV-F 3G 1.5 mm²; 1 m; 1,50 mm²; black

1.1.2 Female connector/socket

<a href="#">Item No.: 770-203</a> Socket; 3-pole; Cod. A; 4,00 mm²; black	<a href="#">Item No.: 770-103</a> Socket; with strain relief housing; 3-pole; Cod. A; 4,00 mm²; black

1.1.3 Male connector/plug

<a href="#">Item No.: 770-212</a> Plug; 2-pole; Cod. A; 4,00 mm²; black	<a href="#">Item No.: 770-213</a> Plug; 3-pole; Cod. A; 4,00 mm²; black	<a href="#">Item No.: 770-112/041-000</a> Plug; with strain relief housing; 2-pole; Cod. A; 4,00 mm²; black	<a href="#">Item No.: 770-113</a> Plug; with strain relief housing; 3-pole; Cod. A; 4,00 mm²; black

1.2 Optional Accessories

1.2.1 Installation

1.2.1.1 Mounting accessories

<a href="#">Item No.: 899-680</a> Mounting plate; for distribution boxes; gray

## Installation Notes

### Installation

