

Color: white

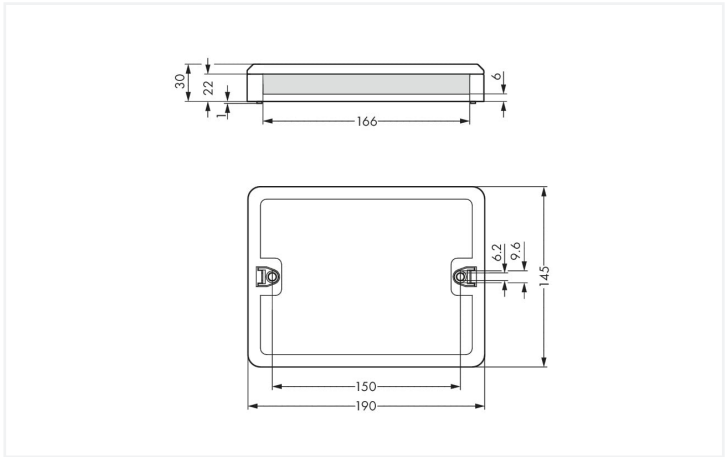

Dimensions in mm

Distribution box *WINSTA*® with protection type IP20

Realize your installation project with ease: The distribution box from the *WINSTA*® product line with a current rating of 25 A is the product of your choice for quick, straightforward installation. You can rely on the quality of *WINSTA*® components from WAGO for your electrical installation accessories too. The coding options reduce installation errors, allowing fast, maintenance-free wiring of all components. The distribution box is protected in accordance with protection type IP20 (When mated: IP2xC (These compact connectors are not designed for use in open, easily accessible areas!)). This means that users' fingers will never come into contact with live elements. This distribution box can be used for a current load of up to 25 A. As a result, it can also be used for high power loads.

Push-in *CAGE CLAMP*® spring pressure connection technology – pluggable installation instead of laborious screw connections!

WINSTA® is the pluggable connection system that is optimally tailored to the strict requirements of electrical installation. It ensures fast, secure and, above all, error-free installation of components and cables. Take advantage of the pluggable version of our maintenance-free spring pressure connection technology too! Plan your installation with with protection type IP20 from WAGO.

- distribution boxes with protection against mismating
- intuitive marking
- saves time, since no wiring is required at the construction site
- rapid, structured electrical installation

Electrical data					General information	
Ratings per		IEC/EN 60664-1			Note on contact resistance	
Overvoltage category	III	III	II		approx. 1 mΩ contact resistance	
Pollution degree	3	2	2		approx. 0.25 mΩ contact transition (plug/ socket)	
Nominal voltage	400 V	-	-			
Rated surge voltage	6 kV	-	-			
Rated current	25 A	-	-			

Connection data				Connection 2	
Connection 1				Connection type	
Connection type 1		Input		Output	



Connection 3	
Connection type	Input

Connection 4	
Connection type	Output

Physical data	
Width	190 mm / 7.48 inches
Height	30 mm / 1.181 inches
Depth	145 mm / 5.709 inches

Mechanical data	
Internal wiring	2.5 mm²
Use	Three-phase to single-phase current (400 V / 230 V)
Coding	A
Mounting type	Wall, screw mount Installation on mounting plate
Protection type	IP20; When mated: IP2xC (These compact connectors are not designed for use in open, easily accessible areas!)

Plug-in connection	
Mismating protection	Yes
Note on mismating protection	All WINSTA® components are 100% protected against mismating when: a.) plugging different numbers of poles b.) plugging while rotated 180 c.) plugging while laterally staggered d.) plugging one pole
Locking of plug-in connection	Locking lever

Material data	
Note (material data)	Information on material specifications can be found here
Color	white
Insulation material (main housing)	Polyamide (PA66)
Flammability class per UL94	V0
Contact material	Copper or copper alloy; surface-treated
Contact Plating	Tin
Fire load	7.348 MJ
Weight	367.7 g

Environmental requirements	
Processing temperature	-5 ... +40 °C
Continuous operating temperature	-35 ... +85 °C
Note on continuous operating temperature	Insulating parts for temperatures ≤ 105 °C

Commercial data	
ETIM 9.0	EC002567
ETIM 8.0	EC002567
PU (SPU)	1 pcs
Packaging type	Box
Country of origin	DE
GTIN	4055143933384
Customs tariff number	85366990990



Environmental Product Compliance	
RoHS Compliance Status	Compliant,No Exemption

Downloads

Environmental Product Compliance	
Compliance Search	
Environmental Product Compliance 899-681/144-000	

1 Compatible Products

1.1 System counterpart

1.1.1 Cable assembly



Item No.: 771-9993/006-102
pre-assembled interconnecting cable;
Eca; Socket/plug; 3-pole; Cod. A; H05VV-
F 3G 1.5 mm²; 1 m; 1,50 mm²; white

Item No.: 771-9995/006-102
pre-assembled interconnecting cable;
Eca; Socket/plug; 5-pole; Cod. A; H05VV-
F 5G 1.5 mm²; 1 m; 1,50 mm²; white

1.1.2 Female connector/socket



Item No.: 770-225
Socket; 5-pole; Cod. A; 4,00 mm²; white

Item No.: 770-125
Socket; with strain relief housing; 5-pole;
Cod. A; 4,00 mm²; white

1.1.3 Male connector/plug



Item No.: 770-233
Plug; 3-pole; Cod. A; 4,00 mm²; white

Item No.: 770-133
Plug; with strain relief housing; 3-pole;
Cod. A; 4,00 mm²; white

1.2 Optional Accessories

1.2.1 Installation

1.2.1.1 Mounting accessories



Item No.: 899-680
Mounting plate; for distribution boxes; gray

Installation Notes

Installation

