

—
INSTALLATION INSTRUCTION

Manual 6- and 8-pole switches

OT_D

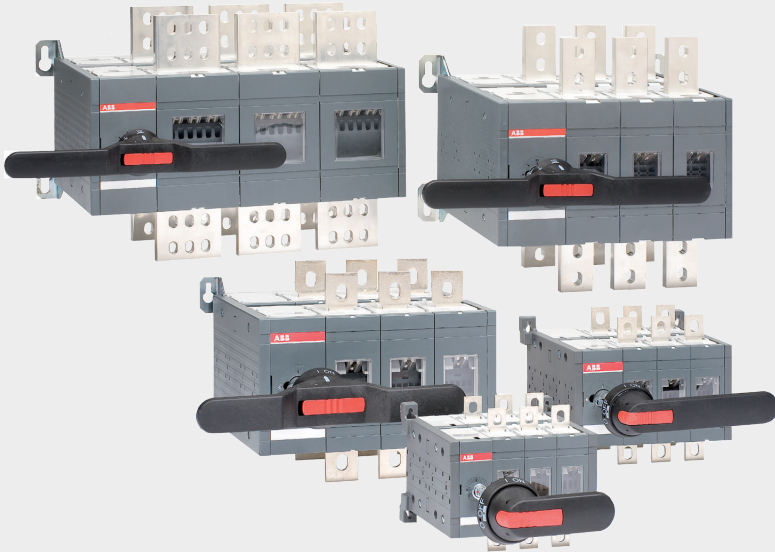
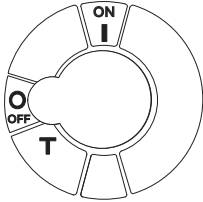

Table of contents

03	Operation
04 - 08	Installation
09	Mounting positions Labels
10	Terminal clamp sets, OZX_
11 - 12	Bridging bars, OTZC_
13 - 15	Auxiliary contact, OA_
16 - 17	Terminal shrouds, OTS_
18 - 20	Handles
21	Clearances per UL98
22	Phase barriers, OTB_
23 - 33	Dimension drawings

Operation

OT160-800_D_



Switch

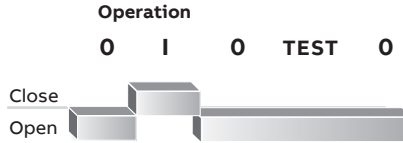

OT160-2500_DD_

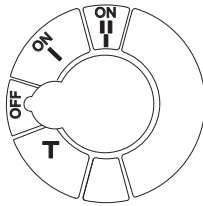

Switch II



Switch I



A06036

Installation

OT160-250_D_

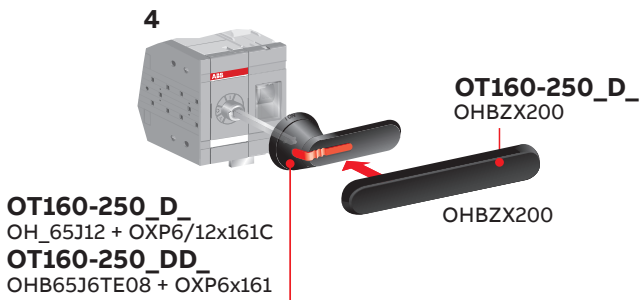
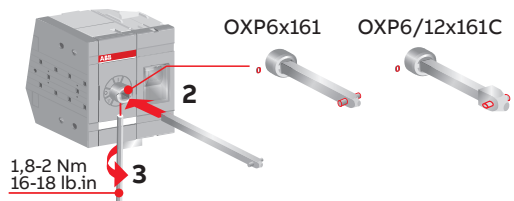
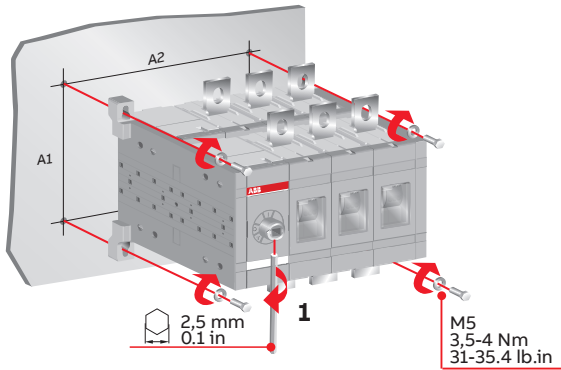

OT315-400_D_

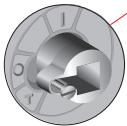
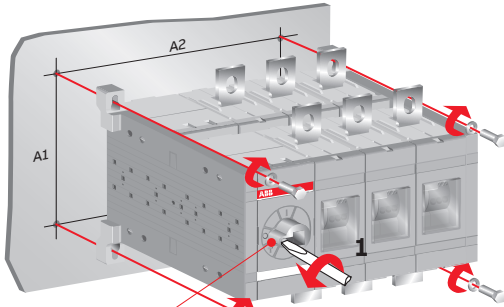

M5
3,5-4 Nm
31-35.4 lb.in

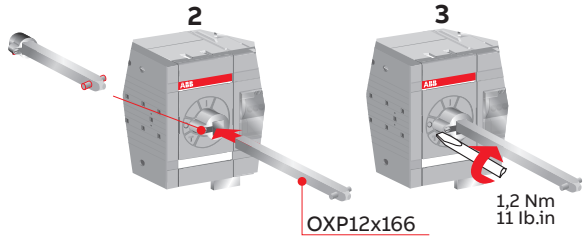

OXP12x166

1,2 Nm
11 lb.in

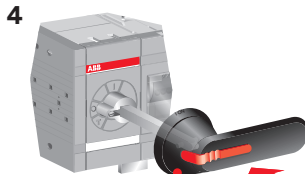

OT315-400_D_
OHB95J12
OT315-400_DD_
OHB95J12TE08

OT315-400_D_
OHBZX200

OHBZX200

OT600-800_D_

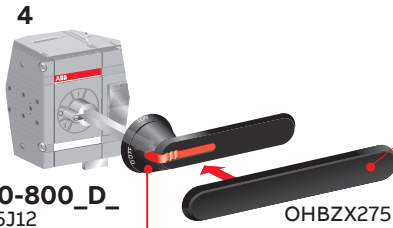
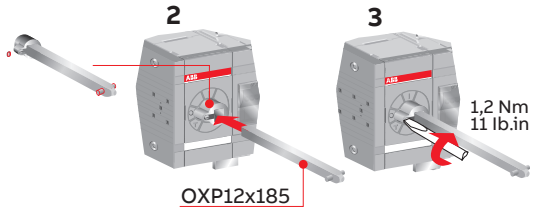
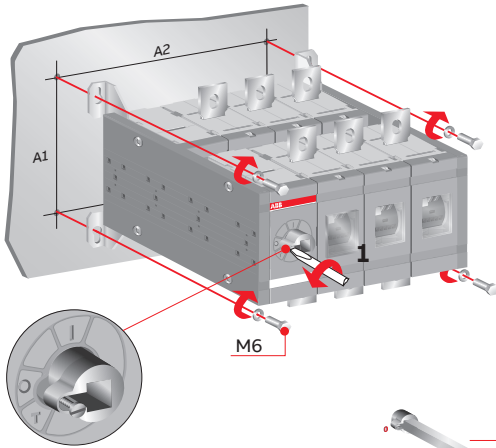

OT600-800_D_
OHB125J12
OT600-800_DD_
OHB145J12TE08

OT600-800_D_
OHBZX275

OT1000-1600_DD_

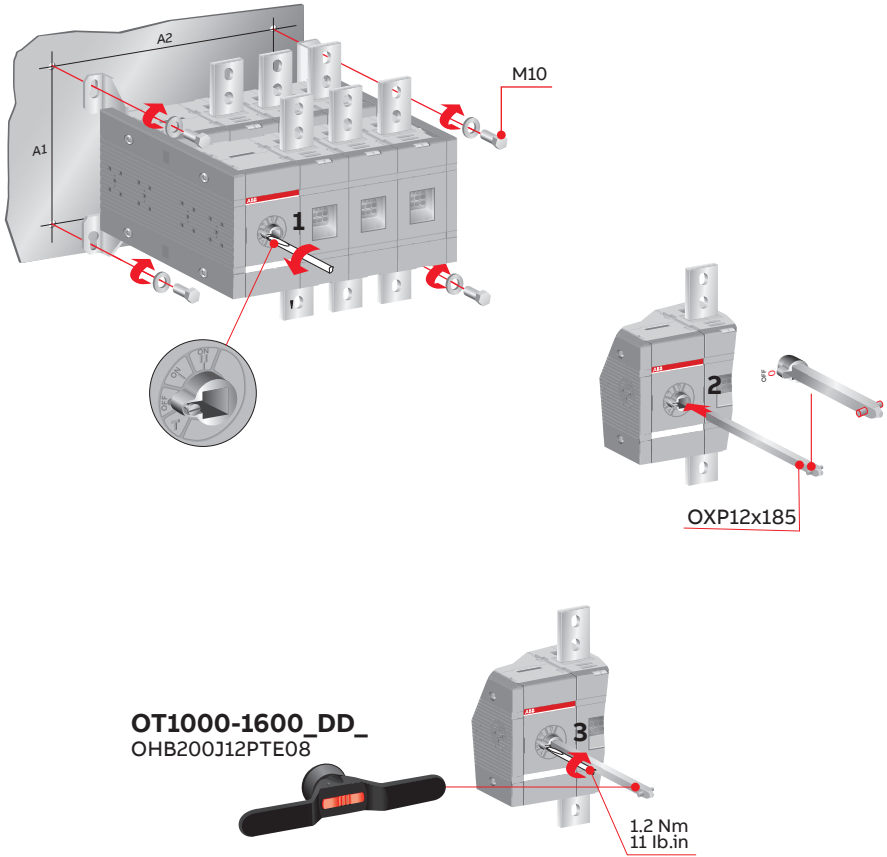

OT1000-1600_DD_
OHB200J12PTE08

OXP12x185

1.2 Nm
11 lb.in

OT2000-2500_DD_

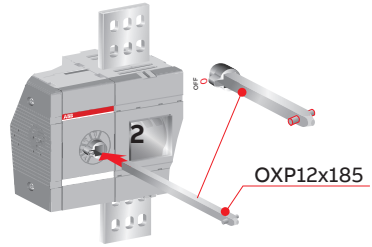
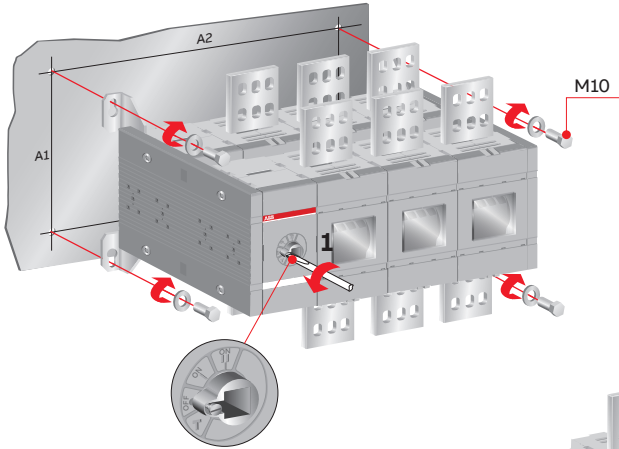

OT2000-2500_DD_
OHB200J12PTE08

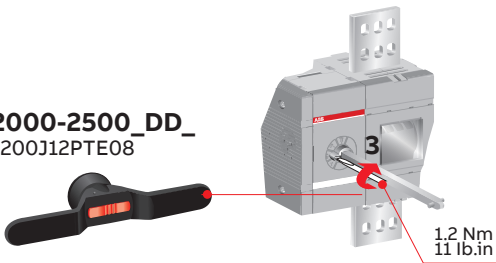

Mounting positions

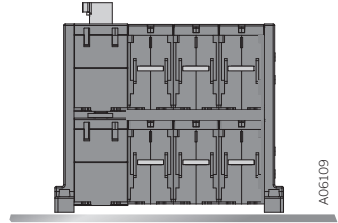
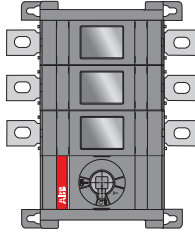
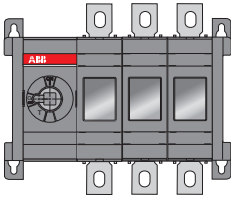

A06109

Labels

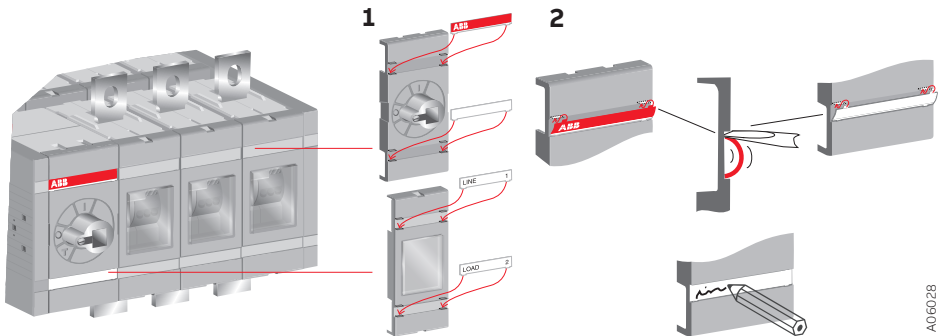

Terminal clamps sets

OZX_

OT2000-2500E_DD_
 OZXB3
 OZXB4
 OZXB5
 OZXB6
 OZXB7L

OT1000-1600E_DD_
 OZXB3
 OZXB4
 OZXB5
 OZXB6*
 OZXB7L

OT800-1200U_DD_
 OZXA-1200_
 OZXA-1206_
 * max. 1 pcs/side

OT630-OT800E_D_
 OZXB3
 OZXB4
 OZXB5
 OZXB6*
 OZXB7L

OT600U_D_
 OZXA-800_
 OZXA-806_
 * max. 1 pcs/side

OT315-OT400E_D_
 OZXB2L
 OZXB3
 OZXB7
 OZXB7L
 OZXB8
 OZXB9

OT400U_D_
 OZXA-400_
 OZXA-406_

OT160-OT250E_D_
 OZXB1L
 OZXB2
 OZXB2L
 OZXB8
 OZXB9

OT200U_D_
 OZXA-200_
 OZXA-206_

Bridging bars

OTZC_

OT160-250_D_
OT315-400_D_
OT600-800_D_

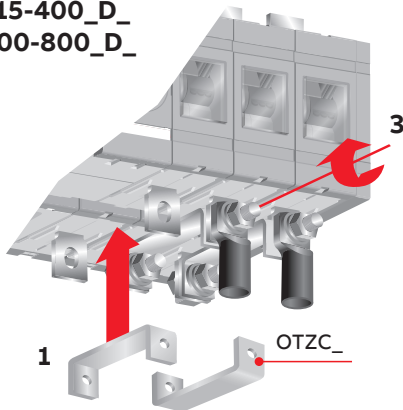

2 OT160-250_D_ OTZC13, OTZC14
OT315-400_D_ OTZC23, OTZC24
OT600-800_D_ OTZC33, OTZC34

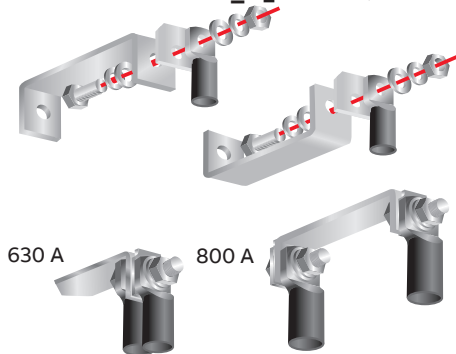

OT1000-1600_DD_

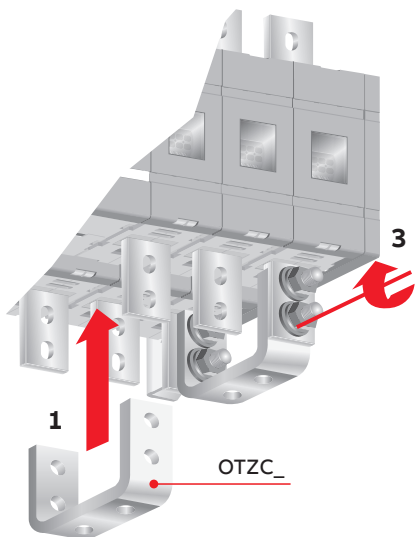

OT1000-1250E_DD_ OTZC43, OTZC44

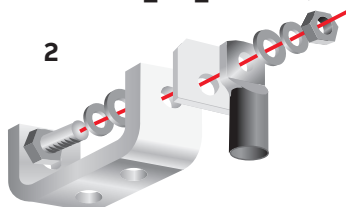

OT1600E_DD_
OT800-1200U_DD_ OTZC53, OTZC54

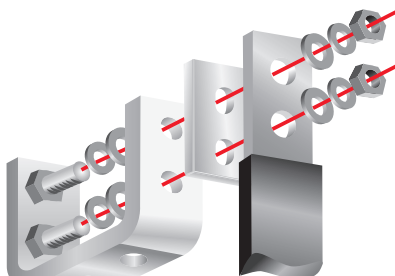

OTZC_

OT2000-2500_DD_

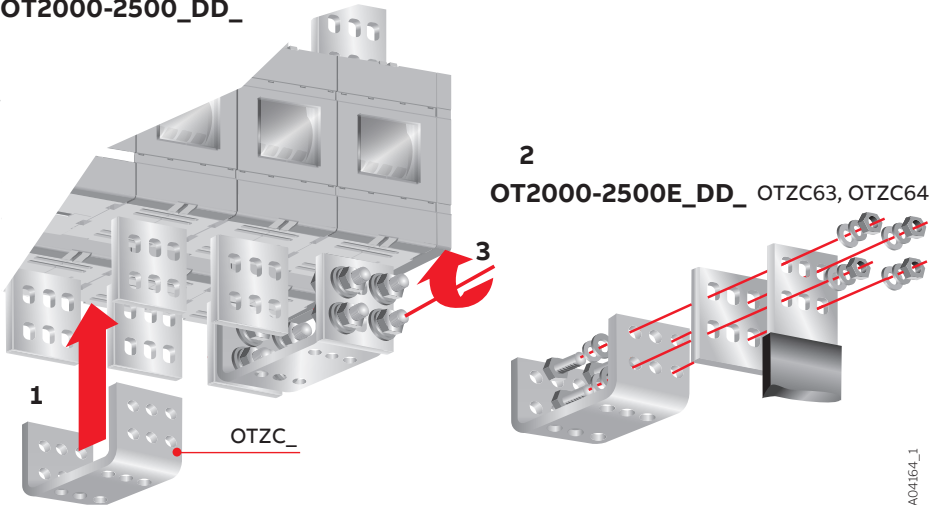

Auxiliary contacts

OA_

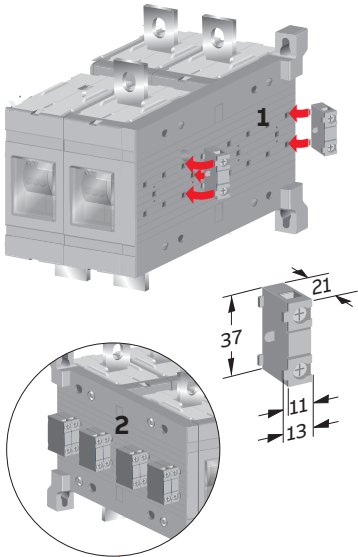

OT160-800_D_

max 2+2

	OA 1G10	OA 3G01
I		
O		
TEST		

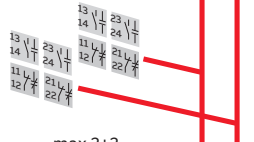

max 2+2

	OA 1G10	OA 3G01
I		
O		
TEST		

OT160-2500_DD_

I max 2+2

	OA 1G10	OA 3G01
I+II		
I		
O		
TEST		

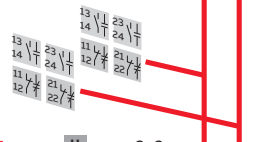

II max 2+2

	OA 1G10	OA 3G01
I+II		
I		
O		
TEST		

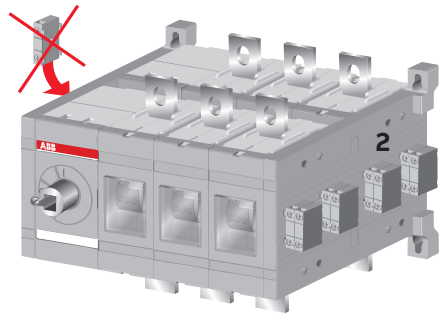
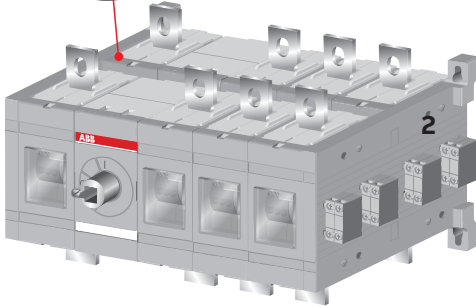

OA_

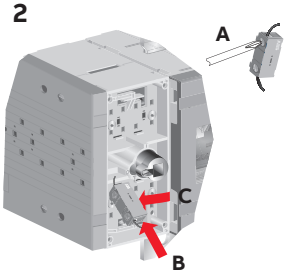
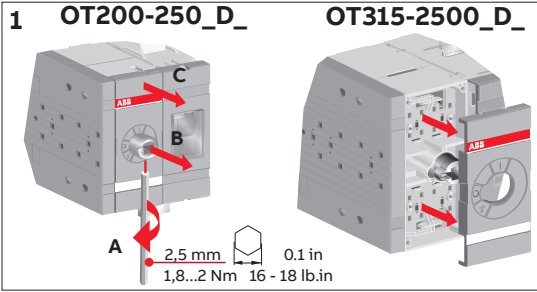

OT160-800_D_

0 I 0 Test 0

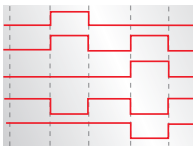

Main contact
Test contact (NO)
Test indication contact (NO)
Test contact (NC)
Test indication contact (NC)

OT160-2500_DD_

0 I I+II I 0 Test 0

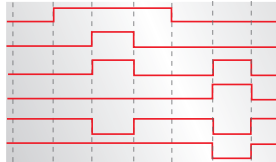

Main contact SWITCH I
Main contact SWITCH II
Test contact (NO)
Test indication contact (NO)
Test contact (NC)
Test indication contact (NC)

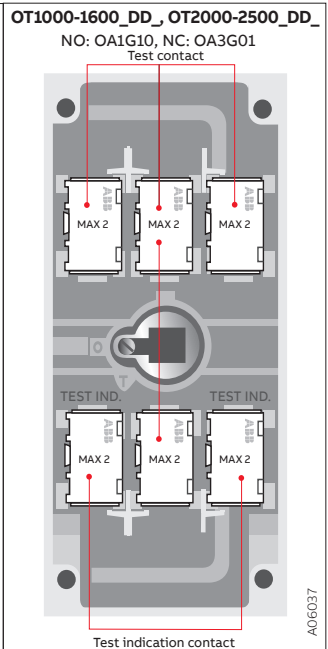
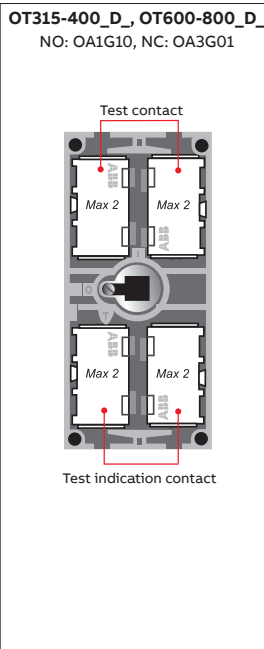
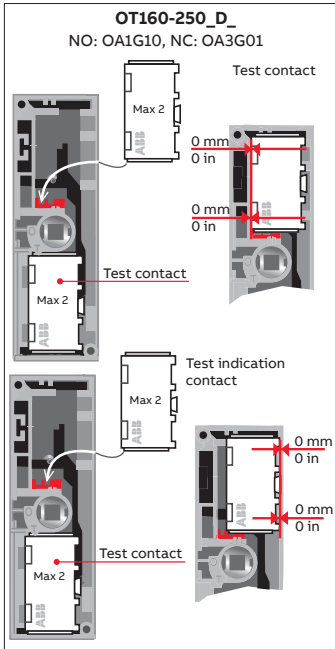

TEST OA_

3 OT200-250_D_

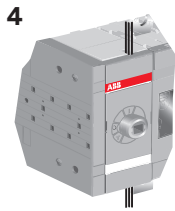
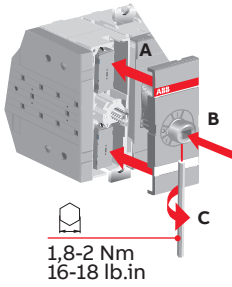

3 OT315-400_D_

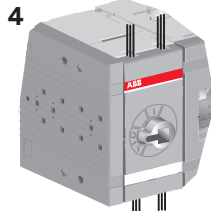
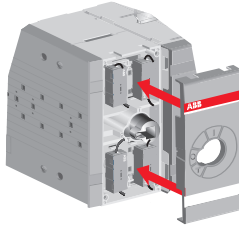

3 OT600-800_D_

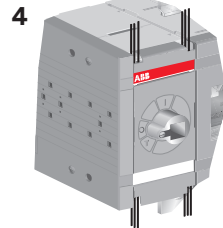
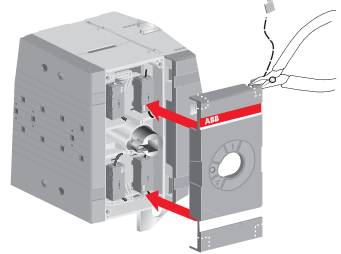

3 OT1000-1600_DD_ OT2000-2500_DD_

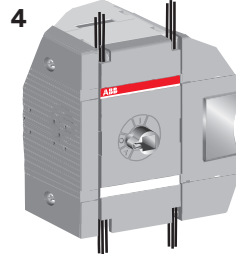
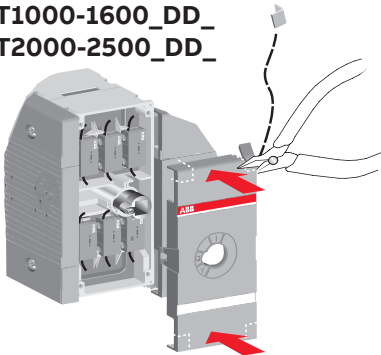

Remove

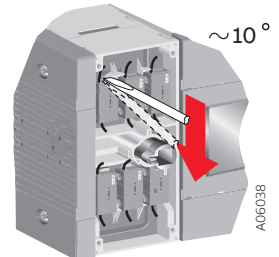

A06038

Terminal shrouds

OTS_

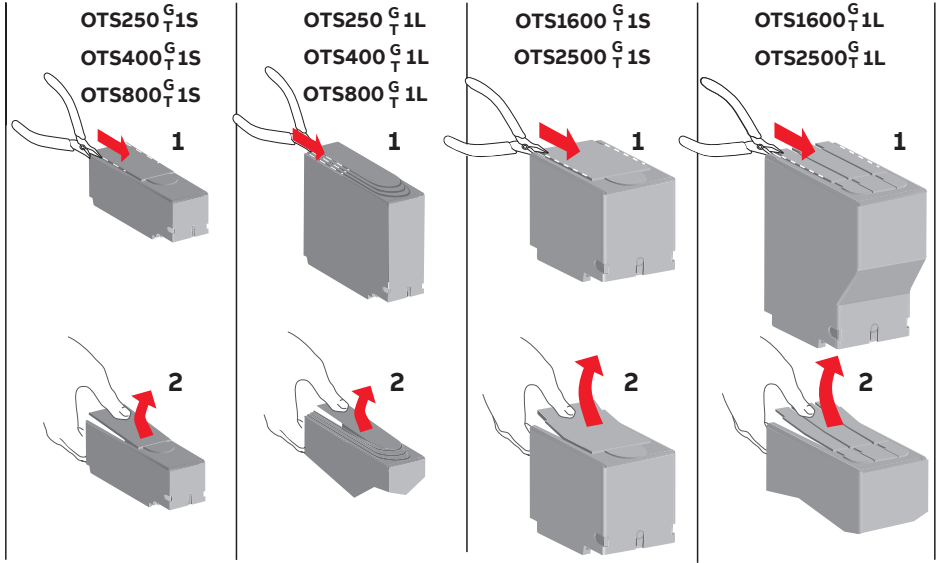

OT160-250_D_
OT315-400_D_
OT600-800_D_

		M	M	M
OT160-250_D_	OTS250_	M8	15...22 Nm	5/6DIA IN. 133-195 lb.in
OT315-400_D_	OTS400_	M10	30...44 Nm	266-390 lb.in
OT600-800_D_	OTS800_	M12	50...75 Nm	433-664 lb.in

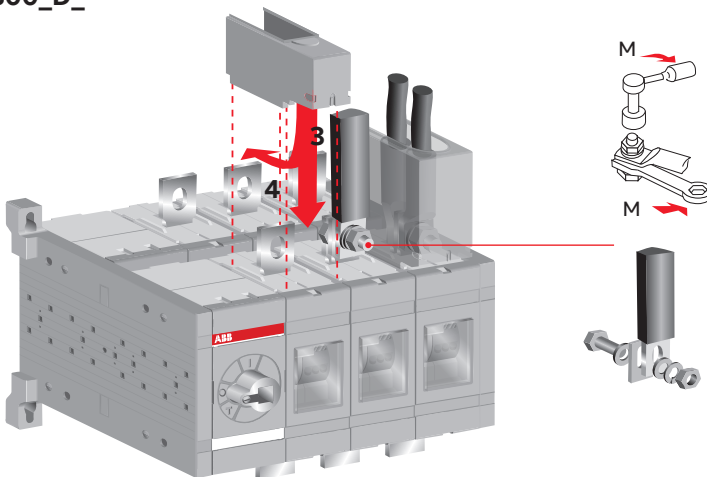

OTS_

OT1000-1600_DD_

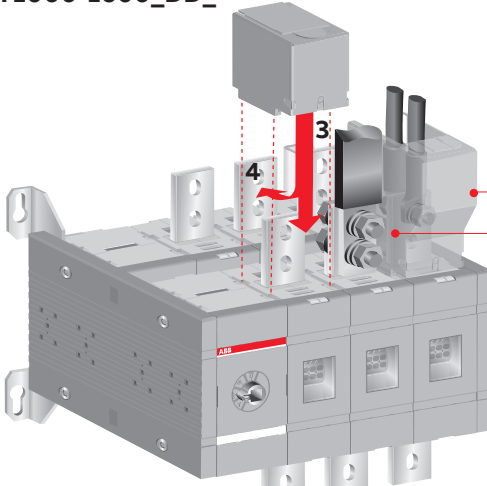

06030_1

OT1000-1600E_DD_ OT800-1200U_DD_

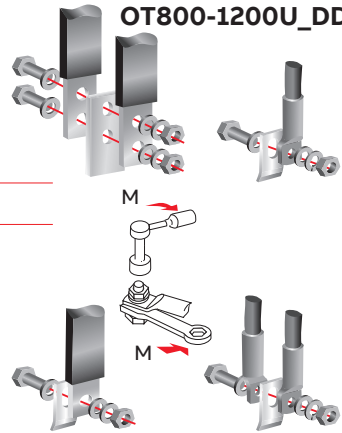

M12 | 50...75Nm | 443-664 lb.in

OT2000-2500_DD_

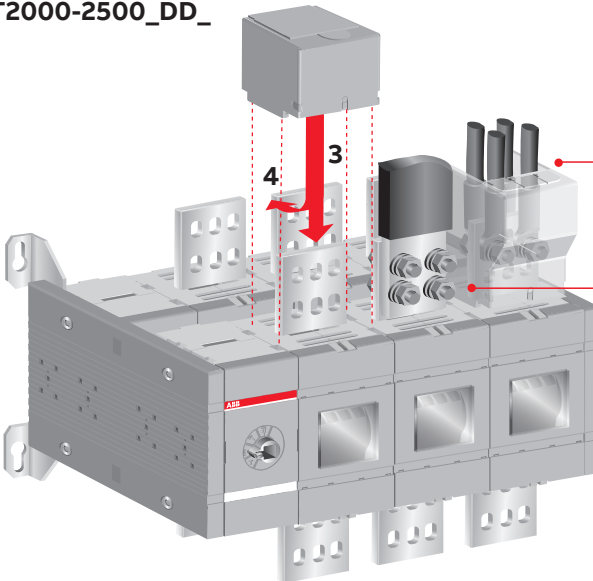

A06030_2

OT2000-2500E_DD_

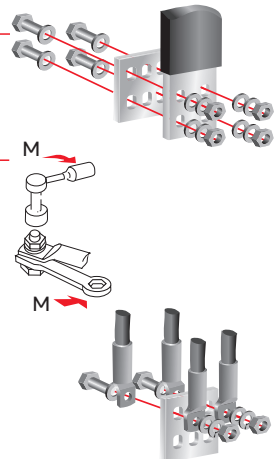

M12 | 50...75Nm | 443-664 lb.in

Handles

Handle for manual operation, OH_ZVX

OHBZX200-275	OHBZX200 OT160-250_DP OT315-400_DP	OHBZX275 OT630-800_DP
---------------------	---	---------------------------------

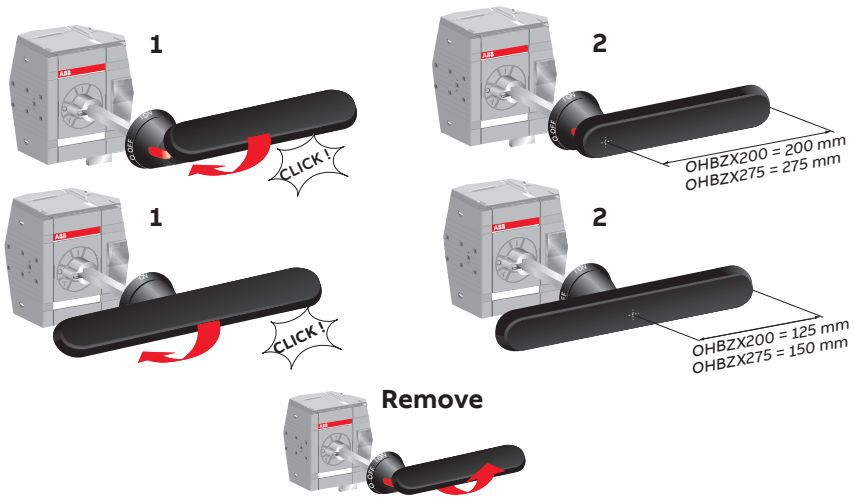

OHBZV95-125	OHBZV95, OHBZV125 OT160-250_DK
--------------------	--

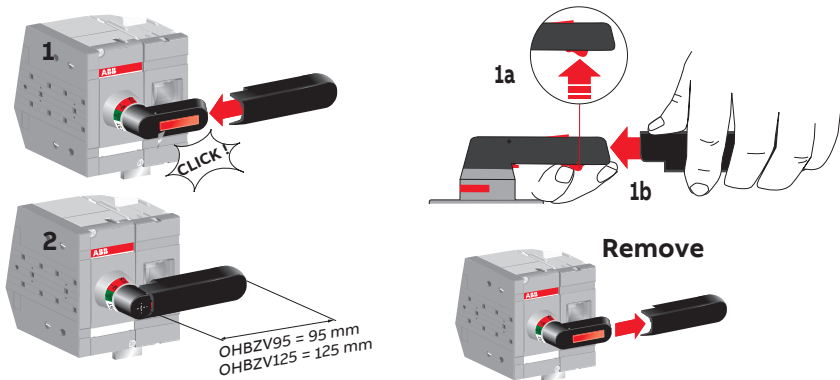

Handle for direct mounting, OH_ZVX

OT200-250_D_



OTV250EDDK
OTV250EK (_EDK)

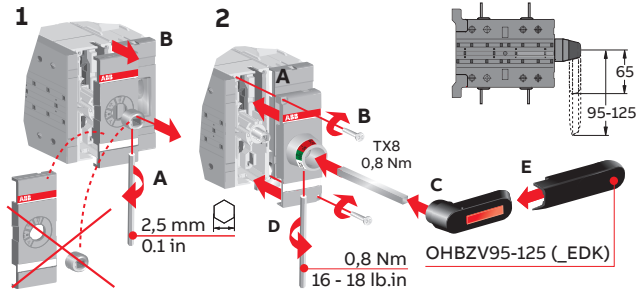

OT315-800_D_

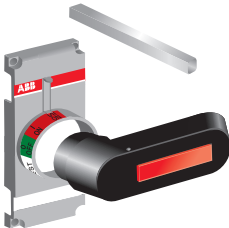

OTV400EDDK
OTV800EDDK
OTV400EK (_EDK)
OTV800EK (_EDK)

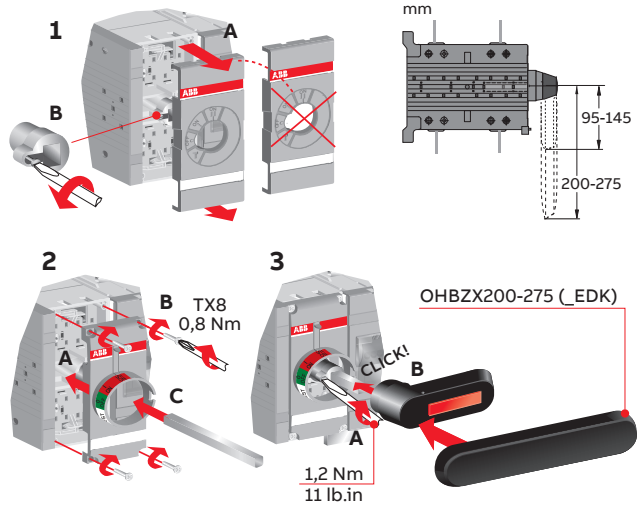

Remove

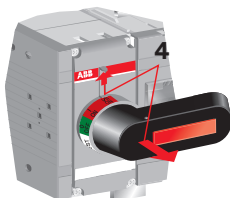

Locking

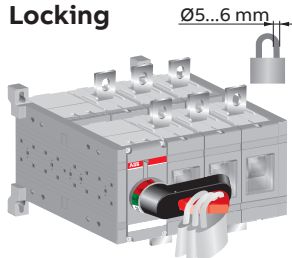

Note: Use protection against direct contact. For example:

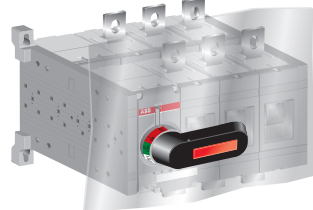

Handles for direct mounting, OTV_

OT1000-1600_DD_
OT2000-2500_DD_



OTV1000EDDK

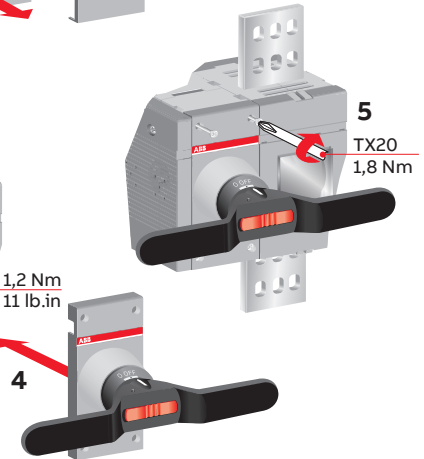
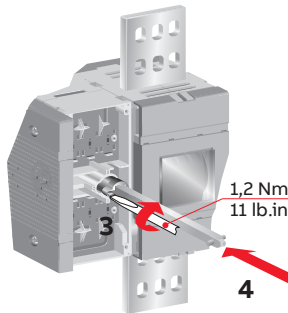
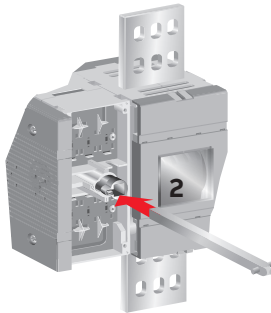
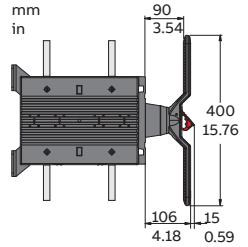
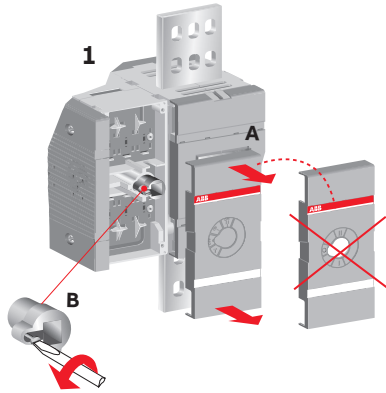

Locking

Ø5...10 mm

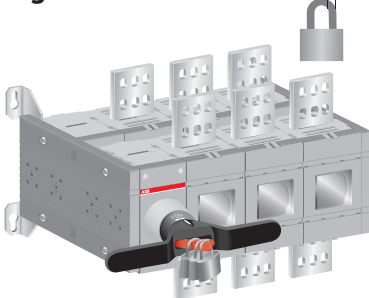

Note: Use protection against direct contact. For example:

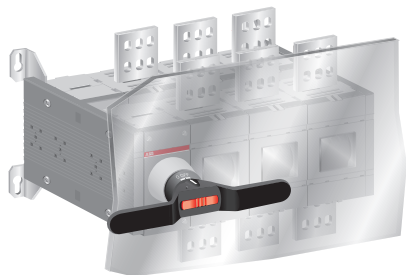

Clearances per UL98

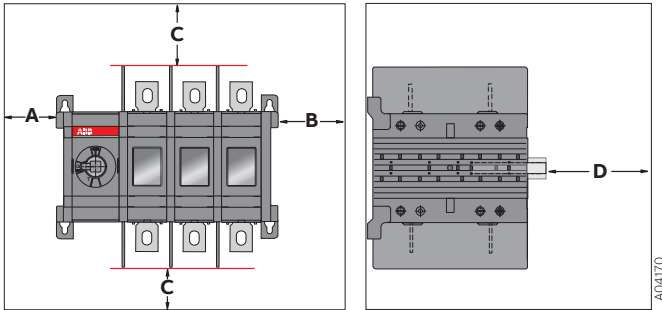

	Height	Width	Depth
OT200U_D_	406 mm/16 in	305 mm/12 in	203 mm/8 in
OT400U_D_	610 mm/24 in	356 mm/14 in	254 mm/10 in
OT600U_D_	610 mm/24 in	700 mm/28 in	400 mm/16 in
OT800-1200U_DD_			

	A	B	C
OT800-1200U_DD_	0	13 mm/0.5 in	13 mm/0.5 in

OT200U_D_				
Cable size		Cable size		
AWG	C	MCM	C	
4-3	100 mm/4 in	250	200 mm/8 in	
2	100 mm/4 in	300	250 mm/10 in	
1	100 mm/4 in			
1/0	125 mm/5 in			
2/0	150 mm/6 in			
3/0-4/0	175 mm/7 in			

OT400U_D_				
Cable size		Cable size		
AWG	C	MCM	C	
2	100 mm/4 in	250	250 mm/8 in	
1	100 mm/4 in	300	250 mm/10 in	
1/0	125 mm/5 in	350	300 mm/12 in	
2/0	150 mm/6 in			
3/0-4/0	175 mm/7 in			

OT1600-1200U_DD_				
Cable size		Cable size		
AWG	C	MCM	C	
2	100 mm/4 in	250	200 mm/8 in	
1	100 mm/4 in	300	250 mm/10 in	
1/0	125 mm/5 in	350	300 mm/12 in	
2/0	150 mm/6 in	400	330 mm/13 in	
3/0-4/0	175 mm/7 in	500	356 mm/14 in	
		600	381 mm/15 in	

Phase barriers

OTB_

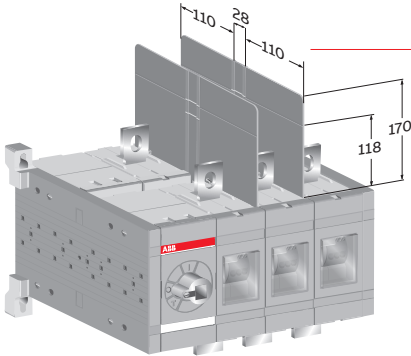
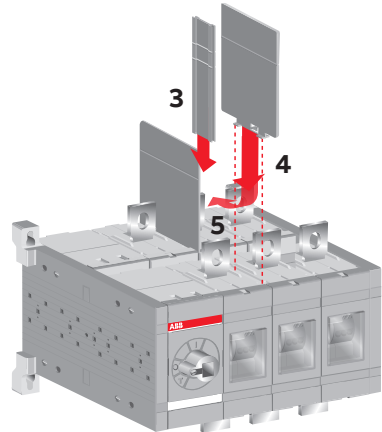
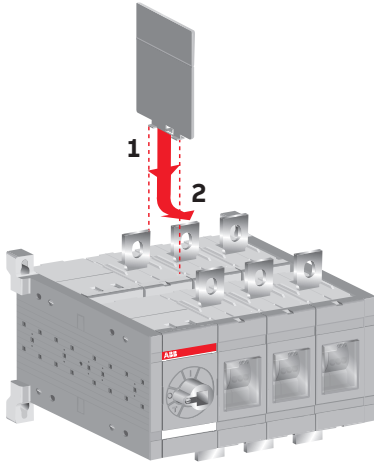

Phase barrier type 68838 on:

OT600U_D_

Phase barriers 68838 or shrouds must be used to maintain a clearance of 1 inch on OT600U_D_, if lugs are wider than 39 mm/1.54 in.

The Type for the package of 6 barriers is OTB800/6D.

Phase barrier type 68912 on:

OT800-1200U_DD_
OT1000-1600E_DD_
OT2000-2500E_DD_

Phase barriers 68912 must be used on OT1000-2500E_DD_ if the voltage is > 415 V.

Phase barriers 68912 or shrouds must be used to maintain a clearance of 1 inch on OT800U_DD_ and OT1200U_DD_, if lugs are wider than 54 mm/2.13 in.

The type for package of 6 barriers is OTB1600/6D.

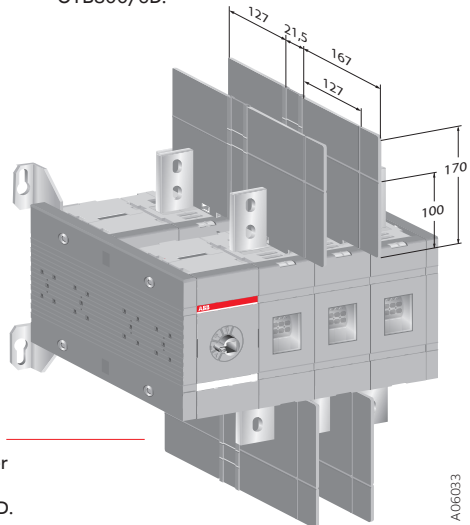

Dimension drawings

OT160-250_D_

OT160-250E02-04D_

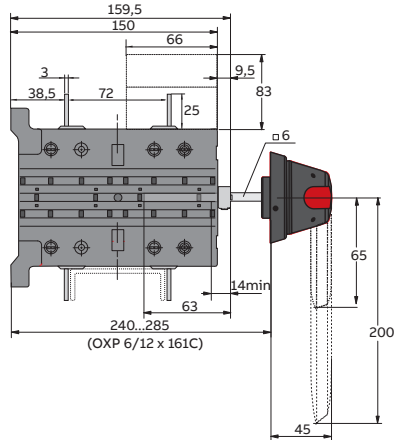
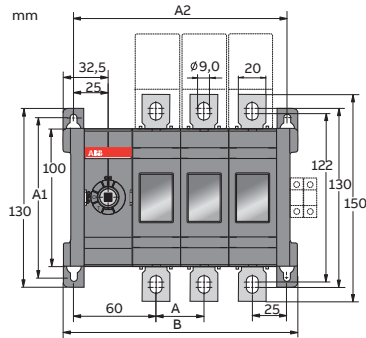

OT160-250_D_

	E02	E03	E04
A	35	35	35
A1	116	116	116
A2	120	155	190
B	135	170	205

A06020_2 / OT160-250E02-04D_ C

OT160-250E12-33D_

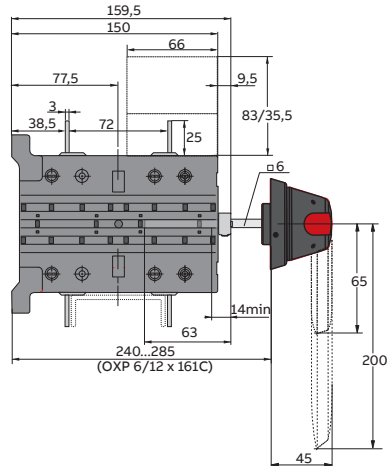
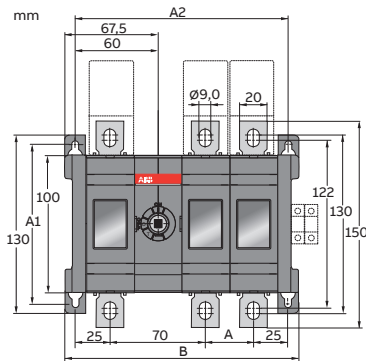

OT160-250_D_

	E12	E13	E22	E23	E33
A	35	35	35	35	35
A1	116	116	116	116	116
A2	155	190	190	225	260
B	170	205	205	240	277

A06020_3 / OT160-250E12-33D_ C

OT160-250_D_

OT200U02-04D_

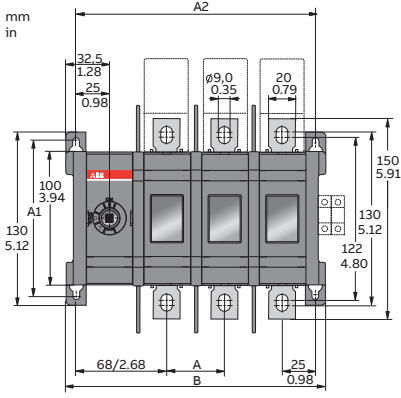

OT200_D_			
	U02	U03	U04
A	43 / 1.69	43 / 1.69	43 / 1.69
A1	116 / 4.57	116 / 4.57	116 / 4.57
A2	136 / 5.35	179 / 7.05	222 / 8.74
B	151 / 5.94	194 / 7.64	237 / 9.33

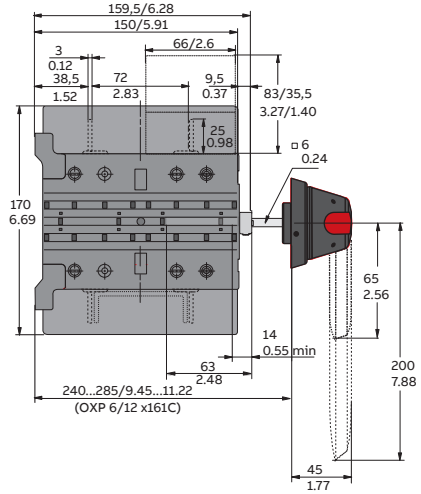

A06021_1/ OT200U02-04D_ C

OT200U12-22D_

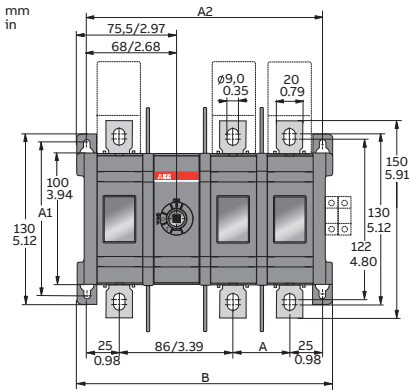

OT200_D_					
	U12	U13	U22	U23	U33
A	43 / 1.69	43 / 1.69	43 / 1.69	43 / 1.69	43 / 1.69
A1	116 / 4.57	116 / 4.57	116 / 4.57	116 / 4.57	116 / 4.57
A2	179 / 7.05	222 / 8.75	222 / 8.74	265 / 10.43	308 / 12.13
B	194 / 7.64	237 / 9.34	237 / 9.33	280 / 11.02	323 / 12.72

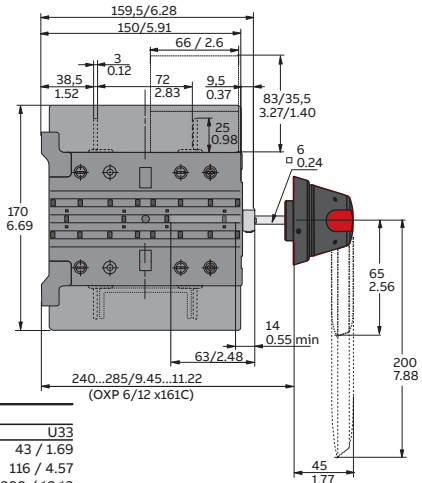

A06021_2/ OT200U12-33D_ C

OT315-400_D_

OT315-400E02-04D_

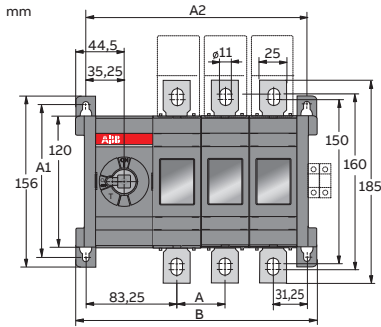

OT315-400_D_			
	E02	E03	E04
A	44	44	44
A1	142	142	142
A2	158,5	202,5	246,5
B	177	221	265

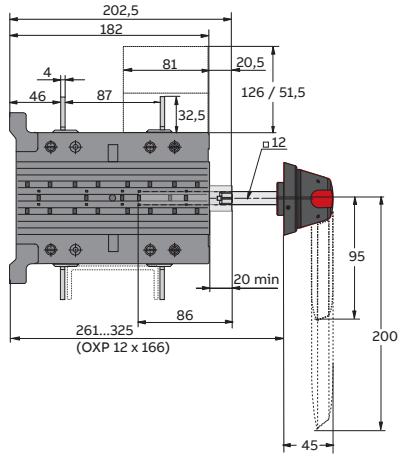

A06022_2 / 315-400E02-04D_ C

OT315-400E12-33D_

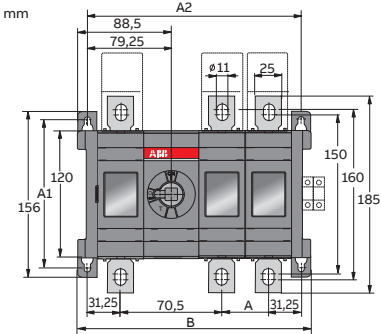

OT315-400_D_					
	E12	E13	E22	E23	E33
A	44	44	44	44	44
A1	142	142	142	142	142
A2	202,5	246,5	246,5	290,5	334,5
B	221	265	265	309	353

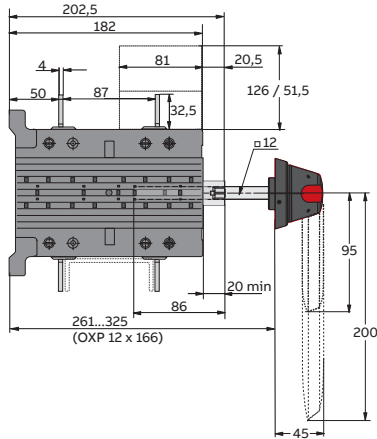

A06022_3 / 315-400E12-33D_ C

OT315-400_D_

OT315-400E02-04D_

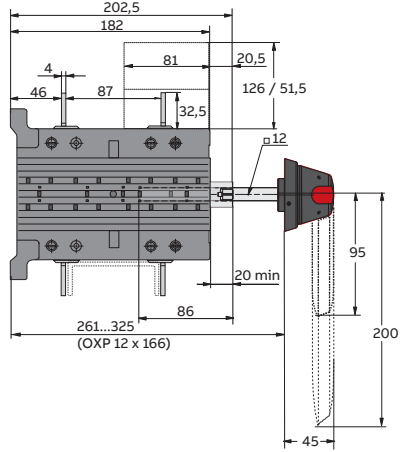
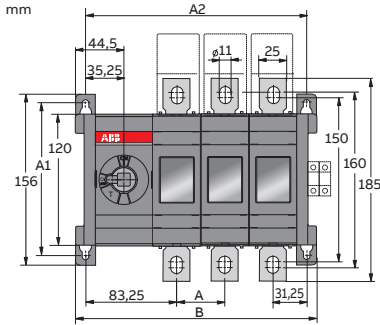

OT315-400_D_			
	E02	E03	E04
A	44	44	44
A1	142	142	142
A2	158,5	202,5	246,5
B	177	221	265

A06022_2 / 315-400E02-04D_ C

OT315-400E12-33D_

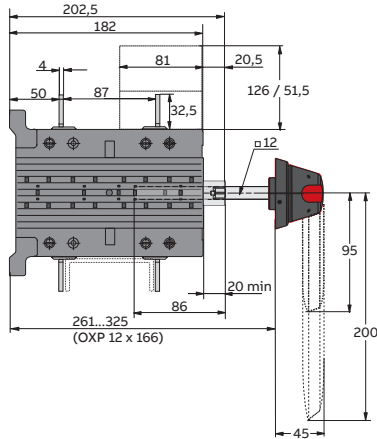
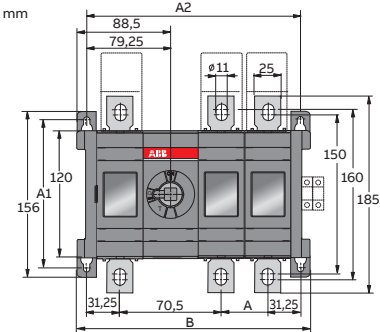

OT315-400_D_					
	E12	E13	E22	E23	E33
A	44	44	44	44	44
A1	142	142	142	142	142
A2	202,5	246,5	246,5	290,5	334,5
B	221	265	265	309	353

A06022_3 / 315-400E12-33D_ C

OT315-400_D_

OT400U02-04D_

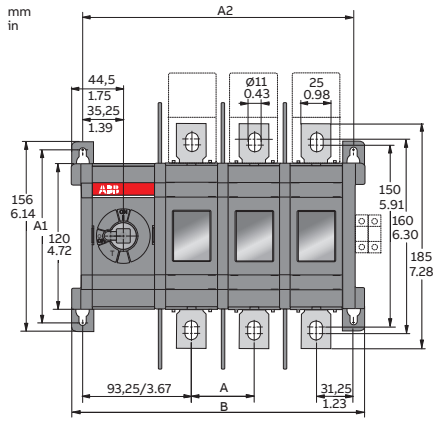

OT400_D_

	U02	U03	U04
A	54 / 2.13	54 / 2.13	54 / 2.13
A1	142 / 5.59	142 / 5.59	142 / 5.59
A2	178,5 / 7.03	232,5 / 9.15	286,5 / 11.28
B	197 / 7.76	251 / 9.88	305 / 12.01

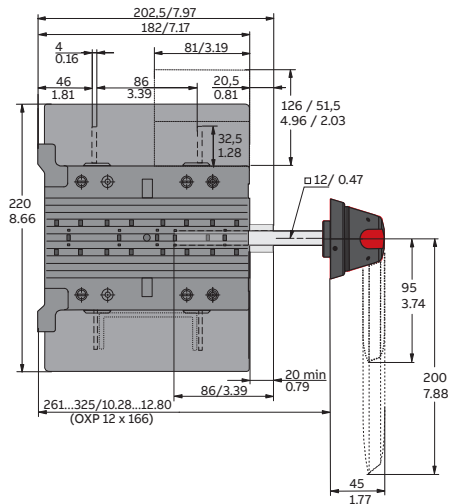

A06023_1 / 400U02-04D_C

OT400U12-33D_

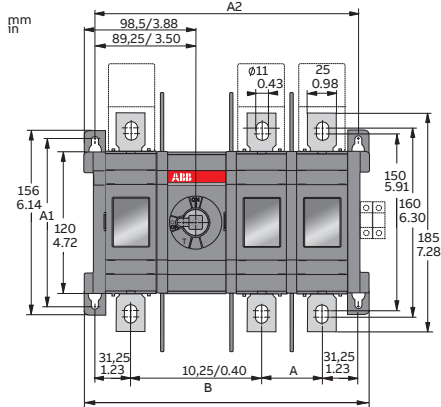

OT400U_D_

	U12	U13	U22	U23	U33
A	54 / 2.13	54 / 2.13	54 / 2.13	54 / 2.13	54 / 2.13
A1	142 / 5.59	142 / 5.59	142 / 5.59	142 / 5.59	142 / 5.59
A2	232,5 / 9.15	286,5 / 11.28	286,5 / 11.28	340,5 / 13.41	394,5 / 15.53
B	251 / 9.88	305 / 12.01	305 / 12.01	359 / 14.13	413 / 16.26

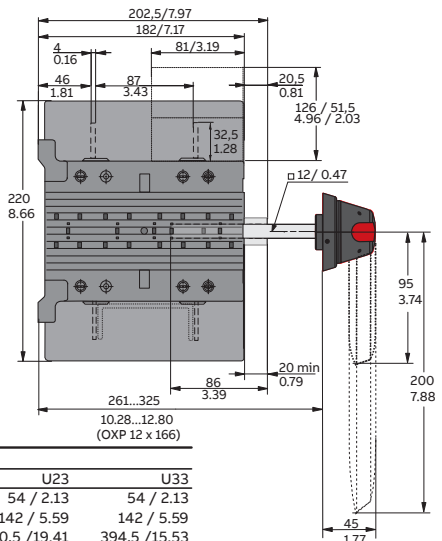

A06023_2 / OT400U12-33D_C

OT600-800_D_

OT630-800E02-04D_

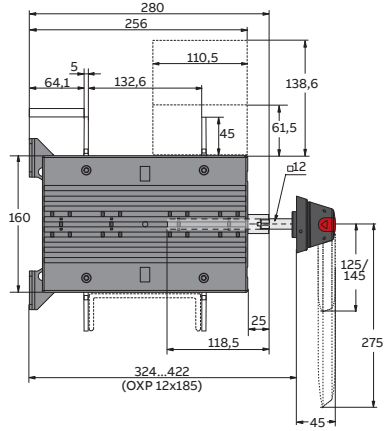
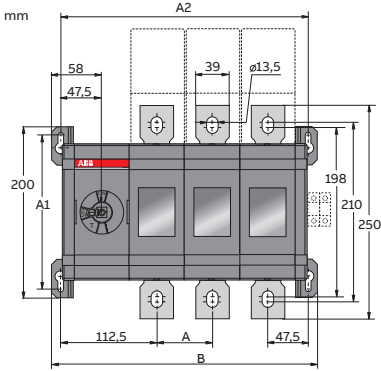

OT630-800_D_			
	E02	E03	E04
A	65	65	65
A1	180	180	180
A2	225	290	355
B	246	311	376

A06024_2

OT630-800E12-33D_

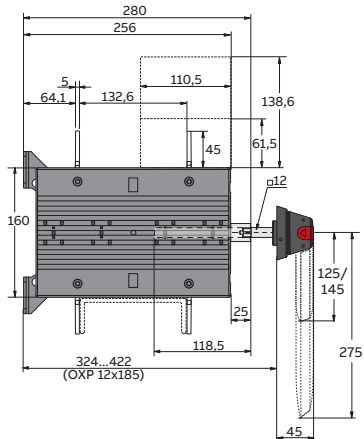
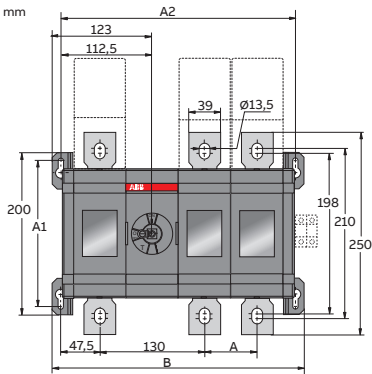

OT630-800_D_					
	E12	E13	E22	E23	E33
A	65	65	65	65	65
A1	180	180	180	180	180
A2	290	355	355	420	485
B	311	376	376	441	506

A06024_3/OT630-800E12-33D_ C

OT160-800_D_

OT600U02-04D_

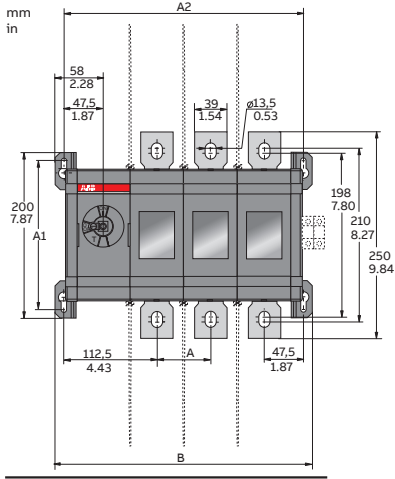

OT600_D

	U02	U03	U04
A	65/2.56	65/2.56	65/2.56
A1	180/7.09	180/7.09	180/7.09
A2	225/8.86	290/11.42	355/13.98
B	246/9.69	311/12.24	376/14.80

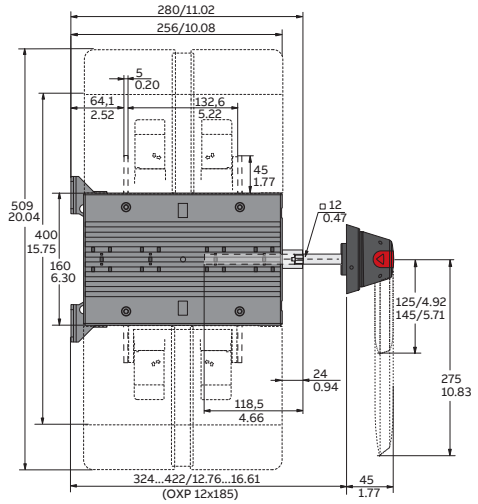

OT160-800_D_

OT600U12-33D_

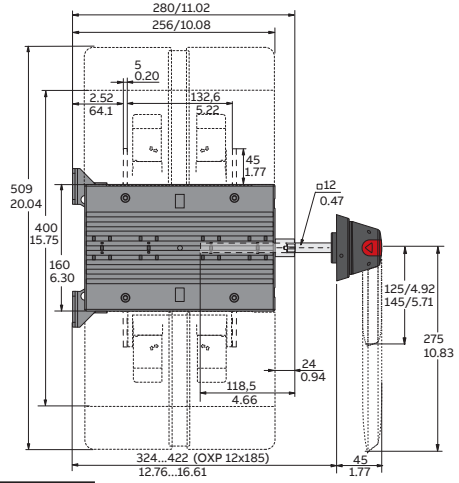
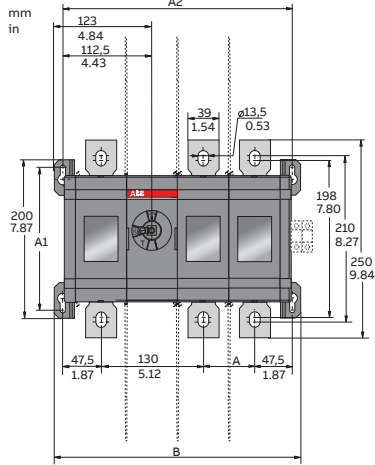

OT600_D_

	U12	U13	U22	U23	U33
A	65 / 2.56	65 / 2.56	65 / 2.56	65 / 2.56	65 / 2.56
A1	180 / 7.09	180 / 7.09	180 / 7.09	180 / 7.09	180 / 7.09
A2	290 / 11.42	355 / 13.99	355 / 13.98	420 / 6.54	485 / 19.10
B	311 / 12.25	376 / 14.81	376 / 14.80	441 / 17.36	506 / 19.92

OT1000-1600_DD_

OT1000-1600E02-04DD_

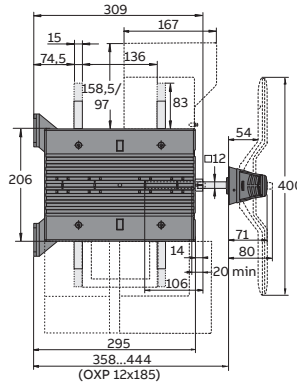
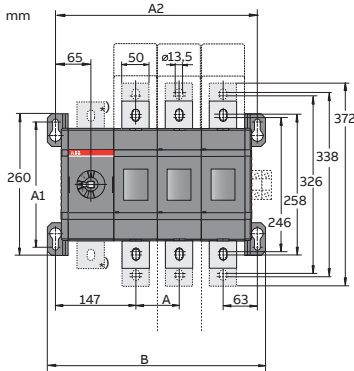

OT1000-1250_DD_ OT1600_DD_

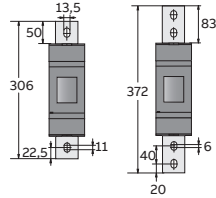

→N3 types

OT1000-1600_DD_			
	E02	E03	E04
A	80	80	80
A1	230	230	230
A2	290	370	450
B	320	400	480

A06017_2/OT1000E02_04DD_A

OT1000-1600E12-22DD_

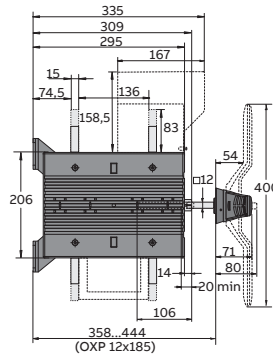
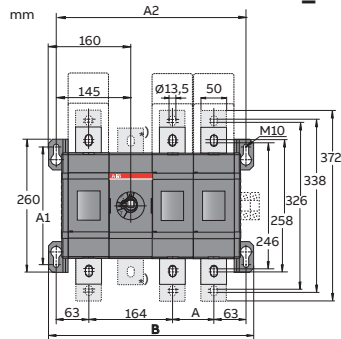

OT1000-1250_DD_ OT1600_DD_

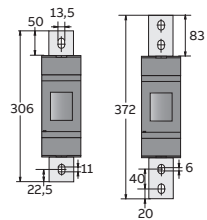

→ N3 types

OT1000-1600_DD_			
	E12	E13	E22
A	80	80	80
A1	230	230	230
A2	370	450	450
B	400	480	480

A06017_3/OT1000-1600E12-22DD_B

OT1000-1600_DD_

OT800-1200U02-04DD_

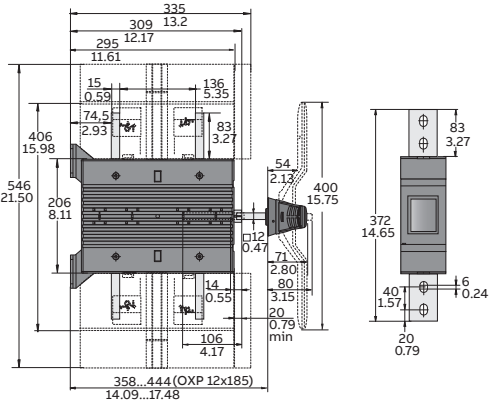
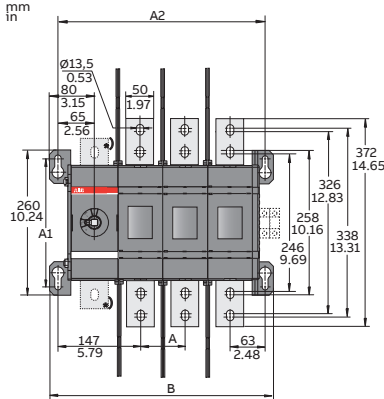

↳ N3 types

OT800-1200_DD_			
	U02	U03	U04
A	80 / 3.15	80 / 3.15	80 / 3.15
A1	230 / 9.06	230 / 9.06	230 / 9.06
A2	290 / 11.42	370 / 14.56	450 / 17.72
B	320 / 12.60	400 / 15.75	480 / 18.90

A066018_1/OT800-1200U02-04DD_ B

OT800-1200U12-22DD_

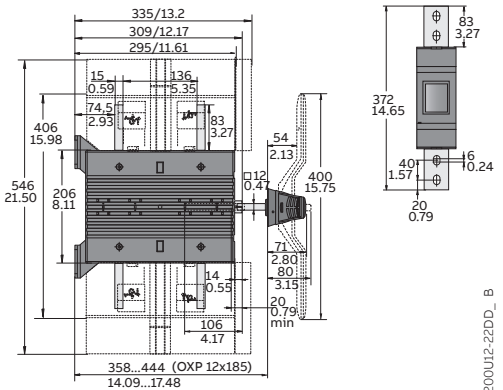
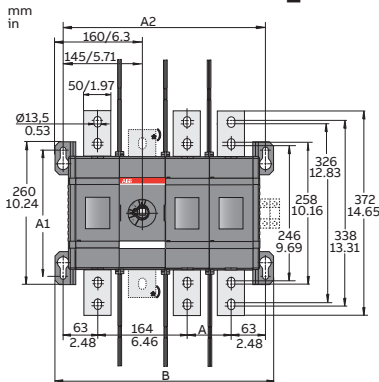

↳ N3 types

OT800-1200_DD_			
	U12	U13	U22
A	80 / 3.15	80 / 3.15	80 / 3.15
A1	230 / 9.06	230 / 9.06	230 / 9.06
A2	370 / 14.56	450 / 17.72	450 / 17.72
B	400 / 15.75	480 / 18.90	480 / 18.90

A066018_2/OT800-1200U12-22DD_ B

OT2000-2500_DD_

OT2000-2500E02-04DD_

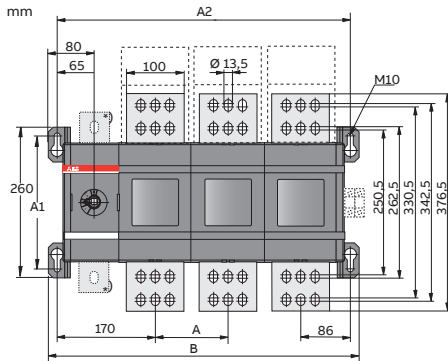

.) N3 types

OT2000-2500_DD_			
	E02	E03	E04
A	126	126	126
A1	230	230	230
A2	382	508	634
B	412	538	664

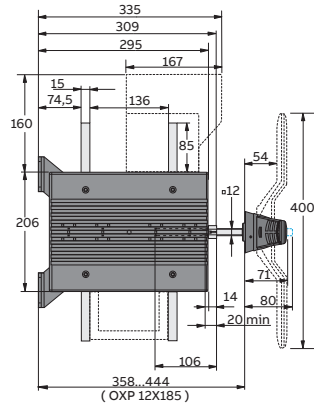

A06016_2/OT2000-2500E02-04DD_ B

OT2000-2500E12-22DD_

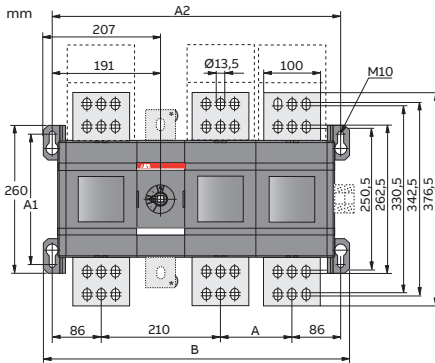

.) N3 types

OT2000-2500_DD_			
	E12	E13	E22
A	126	126	126
A1	230	230	230
A2	508	634	634
B	538	664	664

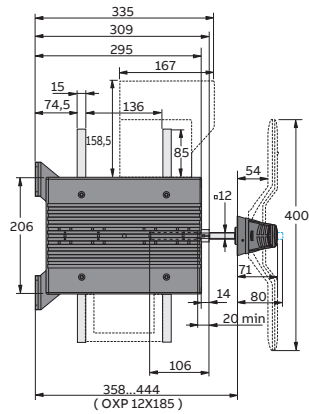

A06016_3/OT2000-2500E12-22DD_ B



BG	Внимание! Опасно напряжение! Да се монтира само от лице с електротехническа квалификация.
CN	警告！电压危险！只能由专业电工进行安装。
CZ	Varován! Nebezpečné napětí! Montáž smí provádět výhradně elektrotechnik!
DA	Advarsel! Farlig elektrisk spænding! Installation må kun foretages af personer med elektroteknisk ekspertise.
DE	Warnung! Gefährliche Spannung! Installation nur durch elektrotechnische Fachkraft.
EL	Προειδοποίηση! Υψηλή τάση! Η εγκατάσταση πρέπει να γίνεται μόνο από εξειδικευμένους ηλεκτροτεχνικούς.
EN	Warning! Hazardous voltage! Installation by person with electrotechnical expertise only.
ES	¡Advertencia! ¡Tensión peligrosa! La instalación deberá ser realizada únicamente por electricistas especializados.
ET	Hoiatus! Ohtlik pinge. Paigaldada võib ainult elektrotehnika-alane ekspert.
FI	Varoitus! Vaarallinen jännite! Asennuksen voi tehdä vain sähköalan ammattihenkilö.
FR	Avertissement! Tension électrique dangereuse! Installation uniquement par des personnes qualifiées en électrotechnique.
HR	Upozoreenje! Opasan napon! Postavljati smije samo elektrotehnički stručnjak.
HU	Figyelmeztetés! Veszélyes feszültség! Csak elektrotechnikai tapasztalattal rendelkező szakember helyezheti üzembe.
IE	Rabhadh! Voltas guaiseach! Ba chóir do dhuine ag a bhfuil saineolas leictreicniúil, agus an té sin amháin, é seo a shuiteáil.
IT	Avvertenza! Tensione pericolosa! Fare installare solo da un elettricista qualificato.
LT	Dėmesio! Pavojinga įtampa! Dirbti leidžiama tik elektrotechniko patirties turintiems asmenims.
LV	Uzmanību! Bīstami - elektrība! Montāžas darbus drīkst veikt tikai personas, kurām ir atbilstošas elektrotehniskās zināšanas.
MT	Twissija! Vultaġġ perikoluż! Għandu jiġi installat biss minn persuna b'kompetenza elettroteknika.
NL	Waarschuwing! Gevaarlijke spanning! Mag alleen geïnstalleerd worden door een deskundige elektrotechnicus.
NO	Advarsel! Farlig spenning! Montering skal kun utføres av kvalifiserte personer med elektrokompetanse.
PL	Ostrzeżenie! Niebezpieczne napięcie! Instalacji może dokonać wyłącznie osoba z fachową wiedzą w dziedzinie elektrotechniki.
PT	Aviso! Tensão perigosa! A instalação só deve ser realizada por um eletricista especializado.
RO	Avertizare! Tensiune periculoasă! Instalarea trebuie efectuată numai de către o persoană cu experiență în electrotehnică.
RU	Осторожно! Опасное напряжение! Монтаж должен выполняться только специалистом-электриком.
SE	Varning! Farlig spänning! Installation får endast utföras av en elektriker.
SK	Varovanie! Nebezpečné napätie! Montáž môže vykonávať iba skúsený elektrotechnik.



Contact us

ABB Oy

Muottitie 2A 65320

Vaasa, Finland

abb.com/lowvoltage