

28 012 979 Product version from 4/1/2024



- spray head Ø 120mm
- Four settings: COMPACT RAIN, COMPACT SOFT FLOW, COMPACT AQUAPRESSURE FLOW, COMPACT CASCADE, max. flow rate 6.8 l/min (at 3 bar)
- Function from: 6 l/min
- 1/2" connection
- inherently safe from back flow
- with anti-scale system

Notes:

- This product can help a building meet the requirements of Green Building Rating Systems, e.g. LEED®, BREEAM®, DGNB

| | | |
|---|-------------------------------|--------------------|
|  | Brushed Durabrand (23kt Gold) | 28 012 979-28 0010 |
|  | Chrome | 28 012 979-00 0010 |
|  | Brushed Platinum | 28 012 979-06 0010 |
|  | Platinum | 28 012 979-08 0010 |
|  | Dark Chrome | 28 012 979-19 0010 |
|  | Light Gold (PVD) | 28 012 979-26 0010 |
|  | Brushed Light Gold (PVD) | 28 012 979-27 0010 |
|  | Matte Black | 28 012 979-33 0010 |
|  | Brushed Gold (PVD) | 28 012 979-37 0010 |
|  | Brushed Dark Brass (PVD) | 28 012 979-39 0010 |
|  | Brushed Bronze (PVD) | 28 012 979-42 0010 |
|  | Brushed Dark Bronze (PVD) | 28 012 979-43 0010 |
|  | Brushed Champagne (22kt Gold) | 28 012 979-46 0010 |
|  | Champagne (22kt Gold) | 28 012 979-47 0010 |
|  | Brushed Chrome | 28 012 979-93 0010 |
|  | Brushed Dark Platinum | 28 012 979-99 0010 |

28 012 979 Product version from 4/1/2024

mm [inches]

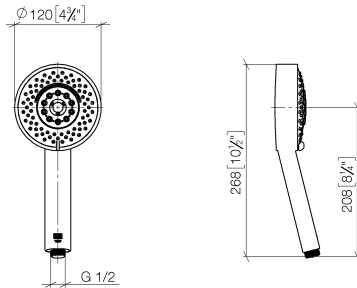

Codes & Standards

| | | | |
|----------------|-----------|----------|---------|
| ASME A112.18.1 | cUPC | DIN 4109 | EN 1112 |
| ISO 3822 | Ü-Zeichen | | |

Certificates and sustainability

| | | |
|-----------------|--------|--------------|
| DVGW_DW-6517DN0 | LGA_29 | IAPMO_4976 (|
|-----------------|--------|--------------|

28 012 979 Product version from 4/1/2024

Parts for other finishes can be found here: [Chrome](#)

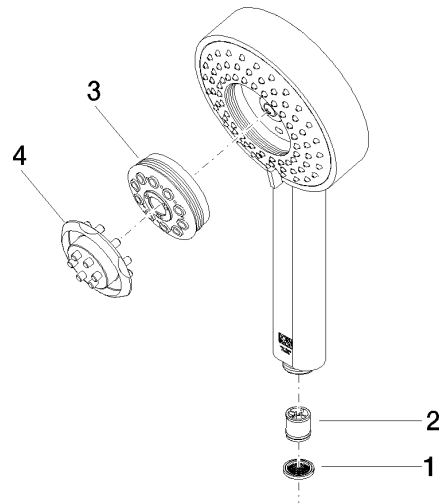

Spare parts list

| No. | Item Number | Name | Quantity used | Delivery time |
|-----|--------------------|---|---------------|---------------|
| 2 | 09 23 01 166 90 | Back-flow preventer 7 l/min. - | 1.00 | 14 |
| 3 | 04 12 11 071 00 90 | Regulating insert Hand shower adjuster 31 x 191 x 50 mm - | 1.00 | 14 |
| 1 | 09 23 01 039 90 | Sieve seal Ø 19 x 5,5 mm - | 1.00 | 14 |
| 4 | 09 30 09 022 90 | Spanner - | 1.00 | 14 |