

Wall-mounted basin spout without pop-up waste - Chrome

SERIES SPECIFIC

13 800 882 Product version from 3/13/2017



- 190mm projection
- fixed spout
- circular, air-enriched flow
- hole diameter 40 mm
- rosette Ø 60 mm
- 1/2" connection
- plug-link mounting
- max. flow 7 l/min
- lead-free
- This product can help a building meet the requirements of Green Building Rating Systems, e.g. LEED®, BREEAM®, DGNB
- WRAS

For Touchfree control please order eSet Touchfree with temperature adjustment

	Chrome	13 800 882-00
	Dark Chrome	13 800 882-19
	Brushed Light Gold (PVD)	13 800 882-27
	Brushed Durabrass (23kt Gold)	13 800 882-28
	Brushed Gold (PVD)	13 800 882-37
	Brushed Bronze (PVD)	13 800 882-42
	Brushed Dark Bronze (PVD)	13 800 882-43
	Brushed Champagne (22kt Gold)	13 800 882-46
	Champagne (22kt Gold)	13 800 882-47
	Brushed Chrome	13 800 882-93
	Brushed Dark Platinum	13 800 882-99

Recommended miscellaneous

- Concealed wall elbow -** 35 085 970 90
- min. recess depth 90 mm
 - max. recess depth 163 mm



13 800 882 Product version from 3/13/2017

mm [inches]

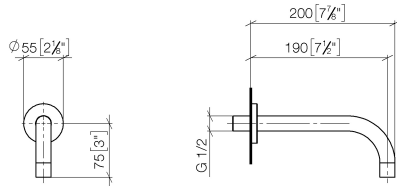

Flow rate chart



Codes & Standards

DIN 4109

ISO 3822

Scottish Water
Byelaws

UK Water Supply
Regulations

Ü-Zeichen



Wall-mounted basin spout without pop-up waste - Chrome

SERIES SPECIFIC

13 800 882 Product version from 3/13/2017

Certificates and sustainability

LGA_29	WRAS_240602	EPD-DOR-20230287 -IBA1-EN Environmental.prod uct-declarat
--------	-------------	--

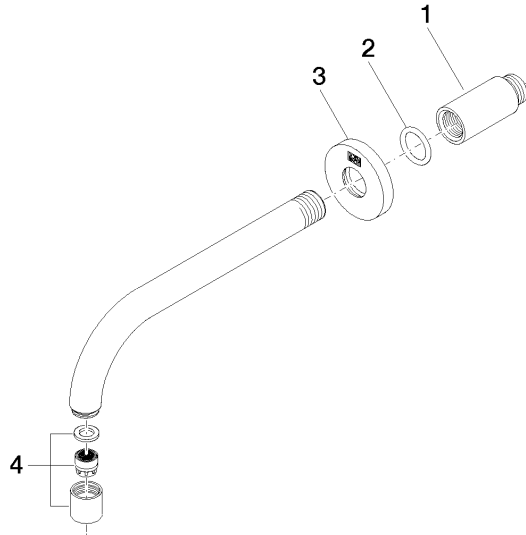

Spare parts list

No.	Item Number	Name	Quantity used	Delivery time
3	09 27 22 503-00	Rosette DB logo Ø 55 x Ø 22 x 9 mm - Chrome	1.00	20
2	90 14 10 026 00 90	O-Ring 20,5 x 3,5 mm -	1.00	14
1	09 24 03 081 10 90	Extension 1/2" x 50 mm -	1.00	14
4	90 23 01 019 00-00	Aerator M18x1-IG 7,0 l/min. - Chrome	1.00	20