

## Data Sheet | Item Number: 787-1007

Switched-mode power supply; for DALI module (753-647); 1-phase; 18 VDC output voltage; 1.1 A output current; 2,50 mm<sup>2</sup>

<https://www.wago.com/787-1007>

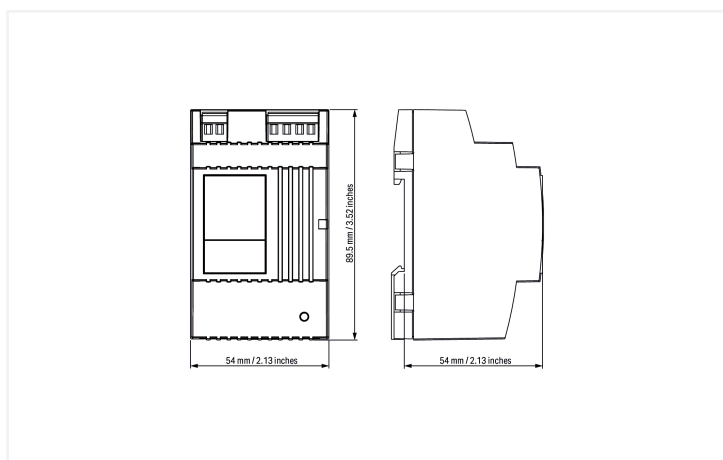
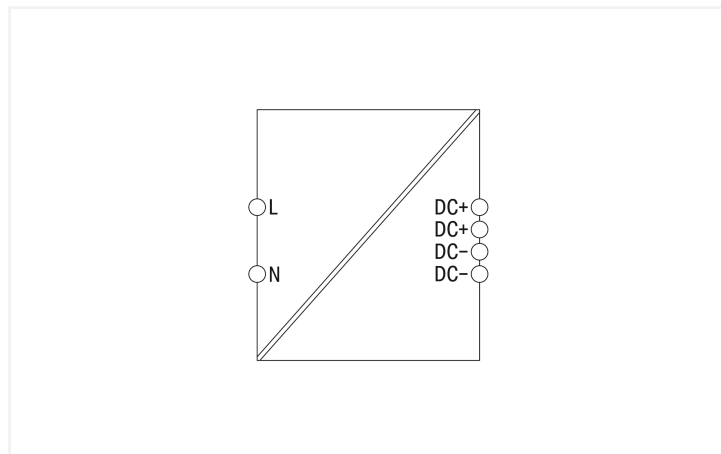

### Short description:

WAGO's 787-1007 Switched-Mode Power Supply is specially designed to supply the 753-647 DALI Multi-Master Module. This unit features a 54 mm wide DIN-rail-mount enclosure with an input voltage range of 85 to 264 VAC (120 ... 300 VDC). The power supply provides an output voltage of 18 VDC and a maximum output current of 1100 mA – enough to supply up to five parallel modules. The maximum current per DALI line is limited to 200 mA in each DALI Multi-Master Module.

### Features:

- Supplies up to five 753-647 DALI Multi-Master Modules\*
- Suitable for protection class II equipment
- Natural convection cooling when horizontally mounted
- Stepped profile, ideal for distribution boards/boxes

### Technical data

#### Input

Phases	1
Nominal input voltage $U_{i, nom}$	1 x 100 ... 240 VAC
Input voltage range	1 x 85 ... 264 VAC; 120 ... 300 VDC
Nominal mains frequency range	44 ... 66 Hz; 0 Hz
Input current $I_i$	$\leq 0.4$ A (230 VAC); $\leq 0.6$ A (110 VAC)
Inrush current	$\leq 30$ A (NTC)
Mains failure hold-up time	$\geq 80$ ms (230 VAC); $\geq 10$ ms (110 VAC)

#### Output

Nominal output voltage $U_{o, nom}$	18 VDC (SELV)
Default Setting	18 VDC
Nominal output current $I_{o, nom}$	1.1 A (18 VDC); 0.8 A (18 VDC; in any mounting position)
Nominal output power	19.8 W
Deviation	$\leq 2$ %
Residual ripple	$\leq 100$ mV (peak-to-peak)
Current limitation	$1.1 \times I_{o, nom}$ (typ.)

### Output

Overload behavior	Constant current
-------------------	------------------

### Signaling and Communication

Signaling	1 x Status indication LED (green)
Operation status indicator	Green LED (U <sub>o</sub> )

### Efficiency/Power Losses

Power loss P <sub>l</sub>	≤ 3 W; ≤ 6 W (nominal load)
Efficiency (typ.)	80 %

### Circuit Protection

Internal fuse	T 2 A / 250 VAC
Pre-fuse (required)	An external DC fuse is required for the DC input voltage.
Backup fuse (recommended)	Circuit breaker: 6 A (C characteristic), 10 A (B characteristic) or higher

### Safety and protection

Isolation voltage (pri.-sec.)	4.242 kVDC
Protection class	II
Protection type	IP20; per EN 60529
Resistance to reverse feed	≤ 20 VDC
Overvoltage category	II
Pollution degree	2
Short-circuit-protected	Yes
Open-circuit-proof	Yes
MTBF	> 500,000 h (per IEC 61709)

### Connection Data

#### Connection 1

Connection type	Input/output
Connection technology	CAGE CLAMP®
WAGO connector	WAGO 740 Series
Solid conductor	0.08 ... 2.5 mm <sup>2</sup> / 28 ... 12 AWG
Fine-stranded conductor	0.08 ... 2.5 mm <sup>2</sup> / 28 ... 12 AWG
Strip length	6 ... 7 mm / 0.24 ... 0.28 inches

### Physical data

Width	54 mm / 2.126 inches
Height	89 mm / 3.504 inches
Depth	59 mm / 2.323 inches
Depth from upper-edge of DIN-rail	55 mm / 2.165 inches

### Mechanical data

Housing design	DIN-rail-mount enclosure
Mounting type	DIN-35 rail

### Material data

Flammability class per UL94	V0
Fire load	0 MJ
Weight	170 g

### Environmental requirements

Ambient temperature (operation)	-25 ... +60 °C
Ambient temperature (storage)	-25 ... +80 °C
Relative humidity	5 ... 96 % (no condensation permissible)
Climatic category	3K3 (per EN 60721)

### Standards and Specifications

Conformity marking	CE
Standards/specifications	EN 61010-1 EN 61010-2-201 EN 61204-3 UL 60950-1 UL 508 DNV

### Commercial data

Product Group	6 (INTERFACE ELECTRONIC)
PU (SPU)	1 pcs
Packaging type	Box
Country of origin	CN
GTIN	4050821430575
Customs tariff number	85044083900

### Product Classification

UNSPSC	39121004
eCl@ss 10.0	27-04-07-01
eCl@ss 9.0	27-04-07-01
ETIM 9.0	EC002540
ETIM 10.0	EC002540
ECCN	NO US CLASSIFICATION

### Environmental Product Compliance

RoHS Compliance Status	Compliant, No Exemption
------------------------	-------------------------

### Approvals / Certificates

#### General approvals



Approval	Standard	Certificate Name
EAC GZO Almaty Standart	TP TC 004/2011	EAC CoC 03078
EAC GZO Almaty Standart	TP TC 020/2011	EAC CoC 03081
UR Underwriters Laboratories Inc.	UL 60950-1	E255815

## Downloads

### Environmental Product Compliance

#### Compliance Search

Environmental Product Compliance 787-1007



## Documentation

### Bid Text

787-1007	19.02.2019	xml 7.47 KB	
787-1007	23.11.2015	doc 31.50 KB	
ausschreiben.de 787-1007			

### Instruction Leaflet

Stromversorgung f. DA-LI-Multi-Master-Klemme 753-647	pdf 161.65 KB	
--	------------------	--

## CAD/CAE-Data

### CAD data

2D/3D Models 787-1007	
--------------------------	--

### CAE data

EPLAN Data Portal 787-1007	
WSCAD Universe 787-1007	
ZUKEN Portal 787-1007	

## 1 Compatible Products

### 1.1 Optional Accessories

#### 1.1.1 Marking

##### 1.1.1.1 Marking strip



**Item No.: 210-831**

Marking strips; on reel; 2.3 mm wide; plain; Self-adhesive; white

**Item No.: 210-832**

Marking strips; on reel; 3 mm wide; plain; Self-adhesive; white

### 1.1.2 Tool

#### 1.1.2.1 Operating tool



**Item No.: 210-720**

Operating tool; Blade: 3.5 x 0.5 mm; with a partially insulated shaft; multicoloured

**Item No.: 210-769**

SCREWDRIVER; green

Subject to changes. Please also observe the further product documentation!

Current addresses can be found at: [www.wago.com](http://www.wago.com)