

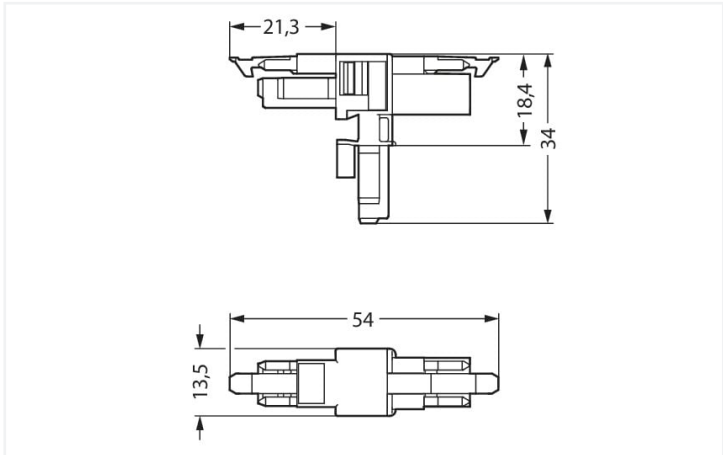

Color: ■ black



Dimensions in mm

Distribution connector *WINSTA*® MINI with protection against mismatching

Use effective pluggable connections instead of laborious screw connections: With the *WINSTA*® MINI distribution connector rated current 16 A. The pluggable installation connectors with spring pressure connection technology work without screw connections. They allow fast, efficient, error-free installation in a large number of possible uses. The coding options reduce installation errors, allowing fast, maintenance-free wiring of all components. The *WINSTA*® MINI pluggable installation connector with A coding in white or black is normally used for general mains applications in power distribution. Due to its particularly minimal dimensions, our *WINSTA*® MINI Pluggable Connection System with Push-in CAGE CLAMP® spring pressure connection technology is especially suitable in very restricted spaces, i.e., for installations when very little room is available.

Push-in CAGE CLAMP® spring pressure connection technology – pluggable installation instead of laborious screw connections!

*WINSTA*® is the pluggable connection system that is optimally tailored to the strict requirements of electrical installation. It ensures error-free installation of cables and components, quickly and reliably. Choose durability and quality – with protection type IP20 from WAGO makes the installation of electrical components visibly easier.

- pluggable installation connectors with protection against mismatching
- easy tool-free operation, a wide range of coding options
- for any mains application
- custom-engineered solutions
- rapid, structured electrical installation

Electrical data				
Ratings per		IEC/EN 60664-1		
Overvoltage category		III	III	II
Pollution degree		3	2	2
Nominal voltage		250 V	-	-
Rated surge voltage		4 kV	-	-
Rated current		16 A	-	-
Approvals per		UL 1977		
Rated voltage		600 V		
Rated current		14 A		
General information				
Note on contact resistance		approx. 1 mΩ of contact resistance approx. 0.25 mΩ contact transition plug/ socket		



Connection data		
Total number of potentials	2	
Connection 1		
Pole number	2	

Physical data		
Pin spacing		4.4 mm / 0.173 inches
Width		13.5 mm / 0.531 inches
Height		34 mm / 1.339 inches
Depth		54 mm / 2.122 inches

Mechanical data		
Use		General mains applications
Coding		A
Variable coding		No
Marking		L N
Potential marking		L N
Mating force of a plug-in connection		Approx. 20 ... 70 N (depending on pole number)
Retention force of a plug-in connection		When locked: > 80 N
Unmating force of a plug-in connection		Unlocked: approx. 20 ... 70 N (depending on pole number)
Number of mating cycles		200, without resistive load
Type of distribution box		T-distribution connector
Protection type		IP20; IP40 when mated

Plug-in connection		
Mismating protection		Yes
Note on mismating protection		All WINSTA® components are 100% protected against mismating when: a.) plugging different numbers of poles b.) plugging while rotated 180 c.) plugging while laterally staggered d.) plugging one pole
Locking lever		Yes
Locking of plug-in connection		Locking lever
Note on locking system		All connectors for mounted installations (snap-in versions for lighting fixtures or devices, all types of PCB and distribution connectors) are factory-equipped with locking levers to ensure plugs and sockets are securely locked. Additional locking levers are only required for flying leads (plug/socket).
Number of locking levers		2

Material data		
Note (material data)		<a href="#">Information on material specifications can be found here</a>
Color		black
Material group		I
Insulation material (main housing)		Polyamide (PA66)
Flammability class per UL94		V0
Contact material		Copper or copper alloy; surface-treated
Contact Plating		Tin
Fire load		0.201 MJ
Weight		6 g



Environmental requirements	
Processing temperature	-5 ... +40 °C
Continuous operating temperature	-35 ... +85 °C
Note on continuous operating temperature	Insulating parts for temperatures ≤ 105 °C

Commercial data	
Product Group	20 (Winsta)
eCl@ss 10.0	27-44-06-03
eCl@ss 9.0	27-44-06-03
ETIM 9.0	EC002567
ETIM 8.0	EC002567
PU (SPU)	25 pcs
Packaging type	Box
Country of origin	DE
GTIN	4045454547615
Customs tariff number	85366990990

Environmental Product Compliance	
RoHS Compliance Status	Compliant, No Exemption

Approvals / Certificates

General approvals			Declarations of conformity and manufacturer's declarations		
					
Approval	Standard	Certificate Name	Approval	Standard	Certificate Name
CCA DEKRA Certification B.V.	EN 61535	71-123231	EU-Declaration of Confor- mity WAGO GmbH & Co. KG	-	-
CCA DEKRA Certification B.V.	IEC 61535	NL-85020	UK-Declaration of Confor- mity WAGO GmbH & Co. KG	-	-
cURus Underwriters Laboratories Inc.	UL 1977	E45171			

Approvals for marine applications

		
Approval	Standard	Certificate Name
ABS American Bureau of Ship- ping	Steel Vessel Rules	19-HG1869855-PDA
DNV GL Det Norske Veritas, Ger- manischer Lloyd	-	TAE00001Z6





Downloads

Environmental Product Compliance



Compliance Search			
Environmental Product Compliance 890-1606			

Documentation

Bid Text			
890-1606	19.02.2019	xml 2.74 KB	
890-1606	03.12.2014	doc 22.50 KB	

CAD/CAE-Data

CAD data	
2D/3D Models 890-1606	

CAE data	
EPLAN Data Portal 890-1606	
WSCAD Universe 890-1606	
ZUKEN Portal 890-1606	

Installation Notes

Installation



Secure the mounting plate via pins.