







CL.1 Wall valve anti-clockwise closing hot 1/2" - Brushed Dark Platinum

CL.1

36 617 707 Product version up to 10/14/2020



- with WAVES structure
- rosette 60 x 60 mm
- with hot marking
- head part with cut-to-length spindle and sleeve
- WRAS

	Brushed Dark Platinum	36 617 707-99
	Chrome	36 617 707-00
	Brushed Platinum	36 617 707-06
	Dark Chrome	36 617 707-19
	Brushed Light Gold (PVD)	36 617 707-27
	Brushed Champagne (22kt Gold)	36 617 707-46
	Champagne (22kt Gold)	36 617 707-47

Required miscellaneous



- Wall valve 1/2" -** 35 607 970 90
- min. recess depth 105 mm
 - max. recess depth 150 mm

36 617 707 Product version up to 10/14/2020

mm [inches]

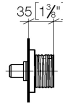
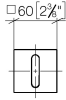

Codes & Standards

ASME A112.18.1	cUPC	DIN 4109	EN 200
ISO 3822	Scottish Water Byelaws	UK Water Supply Regulations	Ü-Zeichen

Certificates and sustainability

DVGW_DW-6501DN0	LGA_29	WRAS_2010	LGA_29	IAPMO_4976 (
EPD-DOR-20230287 -IBA1-EN Environmental.prod uct-declarat				

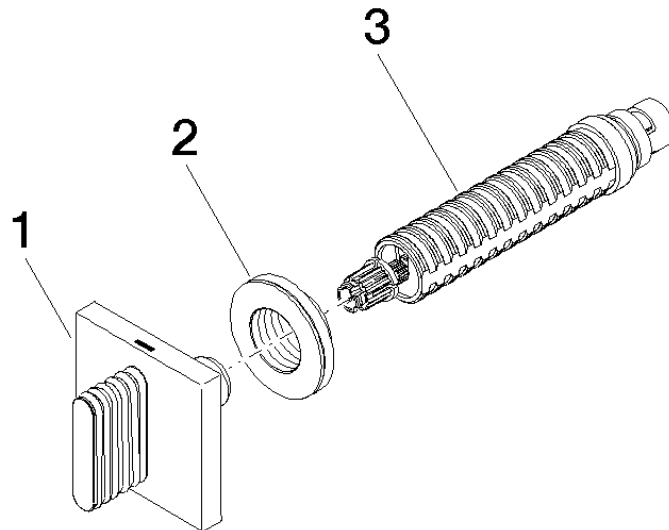

Spare parts list

No.	Item Number	Name	Quantity used	Delivery time
2	09 21 02 108 90	Sleeve Ø 43,1 x 13 mm -	1.00	-
Spare part can no longer be ordered, please order the replacement item				
	9021021080090	Wall disc complete -		
3	90 90 03 142 00 90	Head part anti-clockwise closing 1/2" -	1.00	14
1	90 20 70 055 03-99	Handle for concealed wall mounting Hot oval wave 60 x 60 x 40 mm - Brushed Dark Platinum	1.00	40