

8P-1604: Sanitary adapter female 16x1/2"

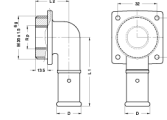

Commercial information

The body of the fitting is made from CW617N brass. These fittings offer great advantages with regard to corrosion and they are also better for the environment.

- The fitting has a buffer ring that prevents direct galvanic contact between the aluminium of the pipe and the brass of the fitting.
- This excludes the possibility of electrolysis occurring.
- The fitting is equipped with O-rings made from EPDM and RVS pressure sleeves with 3 inspection windows.
- In order to prevent assembly errors, the dimensions and type of press profile which can be pressed are shown on the RVS sleeves

Basic unit dimensions

Height	38 mm
Length	82 mm
Width	47 mm
Net weight	0.200 kg

Certificates

ATG, DVGW Wasser, ETA, KIWA, ÖVGW Wasser, WRAS, KOMO, STF, ÖN EN 21003-2/-3, GOST-R, ITC, TSU, QB (CSTBat), AFNOR, ACS, PZH, DNV-GL, Sans 21003, Kontrol Biro, EMI

Applications

Potable water, Heating, Compressed air, Cooling, Sanitary

Solutions

Building installations, Industry, Utility, Shipbuilding

Technical characteristics

Material connection 1	Brass	Bend radius	16 Millimetre
Material quality connection 1	CuZn40Pb2 (CW617N)	Outer pipe diameter connection 1	16 Millimetre
Surface protection connection 1	Untreated	Length	82 Millimetre
Surface treatment connection 1	Untreated	Length of connection 1	61 Millimetre
Material connection 2	Brass	Working length connection 1	0 Millimetre
Material quality connection 2	CuZn40Pb2 (CW617N)	Length of connection 2	31 Millimetre
Surface protection connection 2	Untreated	Working length connection 2	31 Millimetre
Surface treatment connection 2	Untreated	Wrench width	0 Millimetre
Shape	Bend	Wrench width union nut	0 Millimetre
Reducing	✗	Medium temperature (continuous)	-10 70 Degrees celsius
Eccentric	✗	Max. operating pressure at 20 °C	16 Bar
System specific	✓	Standard Dimension Ratio (SDR)	0
Connection 1	Press sleeve		
Contour code connection 1	TH		
Nominal diameter connection 2	1/2 inch (15)		
Connection 2	External thread conical BSPT-R (ISO 7-1 / EN 10226-1)		
Main colour fitting	Brass		
Material sealing	Ethylene-propylene diene monomer rubber (EPDM)		
With buffer stud	✓		
High tensile strength	✗		
With thermal insulation	✗		
Ring stiffness class	Other		
With sealing rings/gaskets	✓		
Capped	✗		
With drain valve	✗		
With de-aerator	✗		
FM quality mark	✗		
LPCB quality mark	✗		
ULC quality mark	✗		
UL quality mark	✗		
DIN-CERTCO certificate	✗		
VdS quality mark	✗		
With approval for TÜV	✗		
DVGW quality mark for gas	✗		
DVGW quality mark for water	✓		
KIWA certified	✓		
Gastec QA mark	✗		
KOMO certified	✓		
Type approval according to BBR/EKS	✗		