

Product data sheet Spirotech

Product name

SpiroCross -DN50 -Magnet -Flange

Product properties

A steel hydraulic separator with (microbubble) deaerator and dirt separator with magnet with a DN50 - DN300 PN16 flange connection

- Three functions in a single component
- Just four connections instead of eight
- Optimal hydraulic balance between primary and secondary pumps
- SpiroTube guarantees minimal fluid mixing and thus the best temperature differential
- Applicable with 50/50 Ethylene Glycol / Water (Volume)
- Real, active deaeration and dirt separation
- Very small particles, from 5 μm (= 0.005 mm), are separated and removed
- Including a magnet for extra protection and highly efficient removal of magnetite
- The rotating outlet makes installation and maintenance easy
- Temperature sensors (not included) can be added in the in- and outlets
- Constant low pressure drop
- Compact design and limited build height
- PN16 flange connections
- Connection diameters from DN50 - DN300, larger connection diameters on request
- Exceptional guarantee

Article number

XC050FM

Product image



Product dimensions

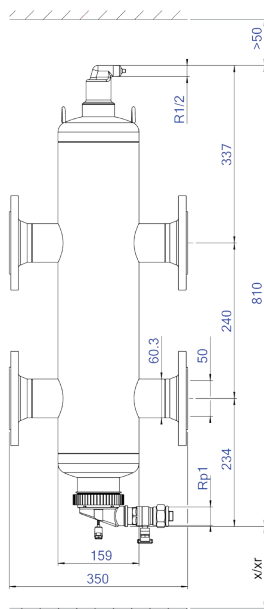

Product data sheet Spirotech

ETIM product data

Max. operating pressure	10 bar
Material	Steel
Max. medium temperature (continuous)	110 °C
Suitable for cooling	Yes
Surface protection	Lacquered
Primary connection	Flange
Nominal diameter primary connection	DN 50
Secondary connection	Flange
Nominal diameter secondary connection	DN 50
With drain connection	Yes
With thermal insulation	No
Nominal diameter drain connection	1 inch
With thermometer	None
With pressure gauge	None

With shut of valve	None
With dirt separator	At the primary return pipe
With magnetite separator	At the primary return pipe
Dosing point for solid or liquid cleaning additives	No
Suitable for heating	Yes
Suitable for glycol	Yes
Suitable for ethanol	Yes
Number of boiler connections	2
Nominal diameter boiler connections	DN 50
Boiler connection model	Flange
Number of air-release connections	1
Nominal diameter air-release	1/2 inch internal thread
Installation side connection model	Flange

Disclaimer

This product sheet has been compiled with the greatest possible care. Nevertheless, it may contain errors or omissions. For the most current and correct information we refer you to our website.

