

### Features

• Simple and slick integral design with no driver box and without any visible screws  
New technology utilization for improved performance  
Invisible in-track adaptor for an impressive architectural look  
Extremely precise light beams due to the high-quality lens  
#80mm die-cast aluminium body, Adjustable beam angle: between 8° - 55° , Textured white finishing colour  
Light color temperature: 3000K, warm light  
System power: 18W, Fixture lumen output: 980lm, efficacy: 55lm/W, Ra97 typical, LED chromacity: 2 step MacAdam ellipse LED source (SDCM2), IR/UV free light source without heat radiation  
Operating voltage 220-240V / 50-60Hz, dimmable via on-board potentiometer, suitable for installation on 3-circuit tracks, please check compatibility list on the instruction sheet.  
Compatible with OneTrack  
Electrical protection: Class II. Degree of protection: IP20, suitable for indoor environment only  
Horizontal rotation: 355°, vertical tilt: 90°  
Nominal product dimensions: D.80mmx215mm  
5 years warranty. Suitable for track mounting

### Product Overview

Product name	CONCORD BEACON MUSE 3000K O/B DIM WHITE
Technology	LED
Cap/Base	N/A
Housing	Aluminium
Mount	Track mounting
Fixture rating	Enclosed
General application	Museums & Galleries, Retail, Hospitality
ETIM Class	EC001744
E-number FI	4170386
Fixture luminous flux (lm)	980
Luminaire efficacy (lm/W)	55

## CONCORD BEACON MUSE 3000K O/B DIM WHITE 2062560

LOR (%)	100
Correlated colour temperature (k)	3000
Light colour	Warm White
CRI (Ra)	97
Colour Variation Initial (SDCM)	2
Photobiological Risk Group	RG1
Total power consumption (W)	18
Electrical protection	Class II
Control gear type	LED driver constant current
Dimmable	Yes
Minimum dimming level (%)	1
Housing colour	RAL9016
IP rating	IP20
IK rating	IK02
Product EAN number	5025768625604
Warranty	5 years
Dimming method	Onboard pot

### Photometry

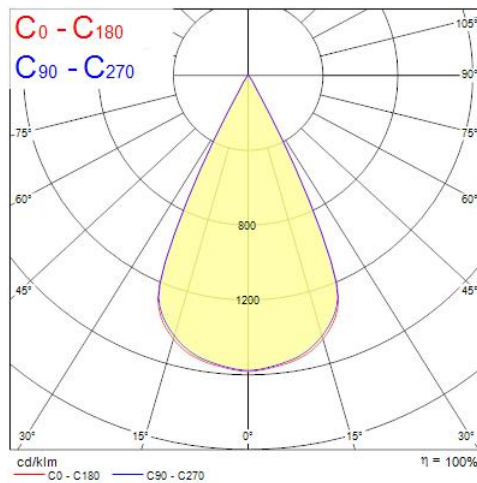
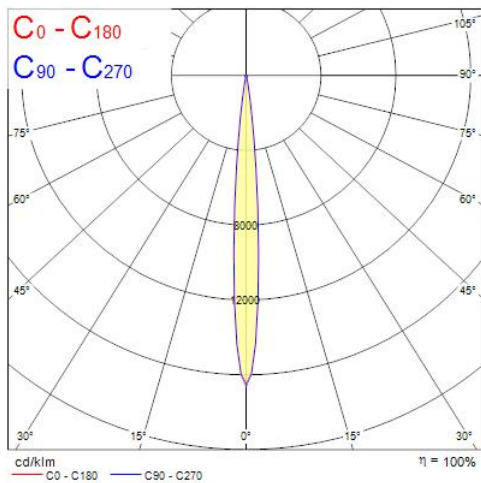

Distance [m]	Cone diameter [m]	Beam diameter [m]	Beam angle [°]	Beam angle [°]	Illuminance [lx]
0.5	0.08	0.08	4.4°	4.5°	33996
1.0	0.15	0.16	4.4°	4.5°	8399
1.5	0.23	0.24	4.4°	4.5°	1914
2.0	0.31	0.31	4.4°	4.5°	1077
2.5	0.38	0.39	4.4°	4.5°	673
3.0	0.46	0.47	4.4°	4.5°	487

Distance [m] Cone diameter [m] Illuminance [lx]

— C0 - C180 (Half beam angle: 9.0°) — C90 - C270 (Half beam angle: 8.8°)

## CONCORD BEACON MUSE 3000K O/B DIM WHITE 2062560

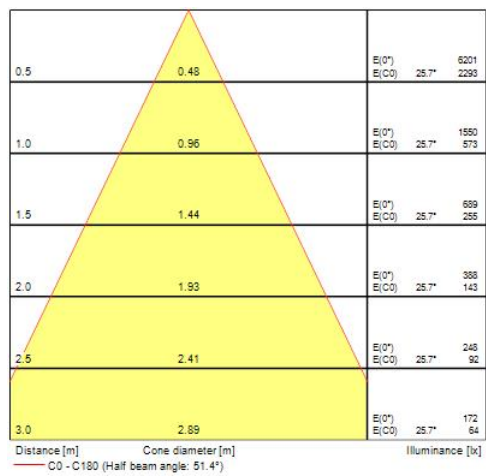

### Technical drawings

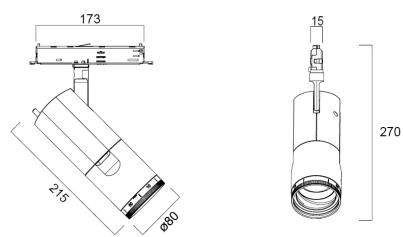

### Data table

#### GENERAL DATA

Product name	CONCORD BEACON MUSE 3000K O/B DIM WHITE
Technology	LED
Cap/Base	N/A
Housing	Aluminium
Mount	Track mounting
Fixture rating	Enclosed
General application	Museums & Galleries, Retail, Hospitality
Operating temperature range (°C)	-10°C...+35°C
ETIM Class	EC001744

## CONCORD BEACON MUSE 3000K O/B DIM WHITE 2062560

E-number FI	4170386
Warranty	5 years

### OPTICAL DATA

Fixture luminous flux (lm)	980
Luminaire efficacy (lm/W)	55
LOR (%)	100
Correlated colour temperature (k)	3000
Light colour	Warm White
CRI (Ra)	97
Colour Variation Initial (SDCM)	2
Luminous Intensity (cd)	980
Distribution type	Symmetric
Photobiological Risk Group	RG1

### ELECTRICAL DATA

Total power consumption (W)	18
Current (A)	0.082
Primary Supply/Product voltage - min (V)	220.0
Primary Supply/Product voltage - max (V)	240.0
Lamp power factor	0.9
THD (at 230 V, 50 Hz, full load, at 100% dimming level) ≤ xx.x %	7.9
Electrical protection	Class II
Control gear required	No
Control gear type	LED driver constant current
Dimmable	Yes
Dimming method	Onboard pot
Minimum dimming level (%)	1
Drive current (mA)	500
Inrush Current (A)	5
Inrush Duration (µs)	50
Energy Efficiency Class (A->G) of contained light source	F

## CONCORD BEACON MUSE 3000K O/B DIM WHITE 2062560

Nominal Frequency (Hz)	50/60Hz
Max. products per 10A C Breaker	31
Max. products per 13A C Breaker	65
Max. products per 16A C Breaker	85
Max. products per 20A C Breaker	104
Max. products per 10A B Breaker	31
Max. products per 13A B Breaker	39
Max. products per 16A B Breaker	50
Max. products per 20A B Breaker	62

### LIFETIME DATA

Lifespan L70 B50	100000
Lifespan L80 B50	100000
Lifespan L90 B50	49000

### PHYSICAL DATA

Housing colour	RAL9016
IP rating	IP20
IK rating	IK02
Diffuser finish	Frosted
Diffuser material	Other
Reflector finish	Matt
Nominal Product Length (mm)	215
Nominal Product Width (mm)	80
Nominal Product Height (mm)	270
Nominal Product Diameter (mm)	80
Weight (kg)	0.94

### PACKAGING

Product EAN number	5025768625604
Packaging single length / height (cm)	30.5
Packaging single width (cm)	13.5
Packaging single depth (cm)	20.5
DUN14 (inner)	05025768625604

## CONCORD BEACON MUSE 3000K O/B DIM WHITE 2062560

Units per outer package	1
Packaging outer length / height (cm)	30.5
Packaging outer width (cm)	13.5
Packaging outer depth (cm)	20.5

### SAFETY DATA

Glow Wire Test (°C)	650
Optimal operating condition (°C)	-10-35
Special purpose lamp	No
Dry applications use only	Yes
Suitable for household illumination	No