

OVA53130  
OVA53131 + OVA53119







Tabella di compatibilità / Compatibility table

	OVA53120	OVA53130	OVA53131	OVA53119
			 x3 cod.OVA53119	
EXIWAY EASYLED	✓			✓
EXIWAY TREND	✓			✓
EXIWAY ESI		✓		✓
 <b>Rispettare modalità installazione prodotto/ Respect the product installation procedure</b>				

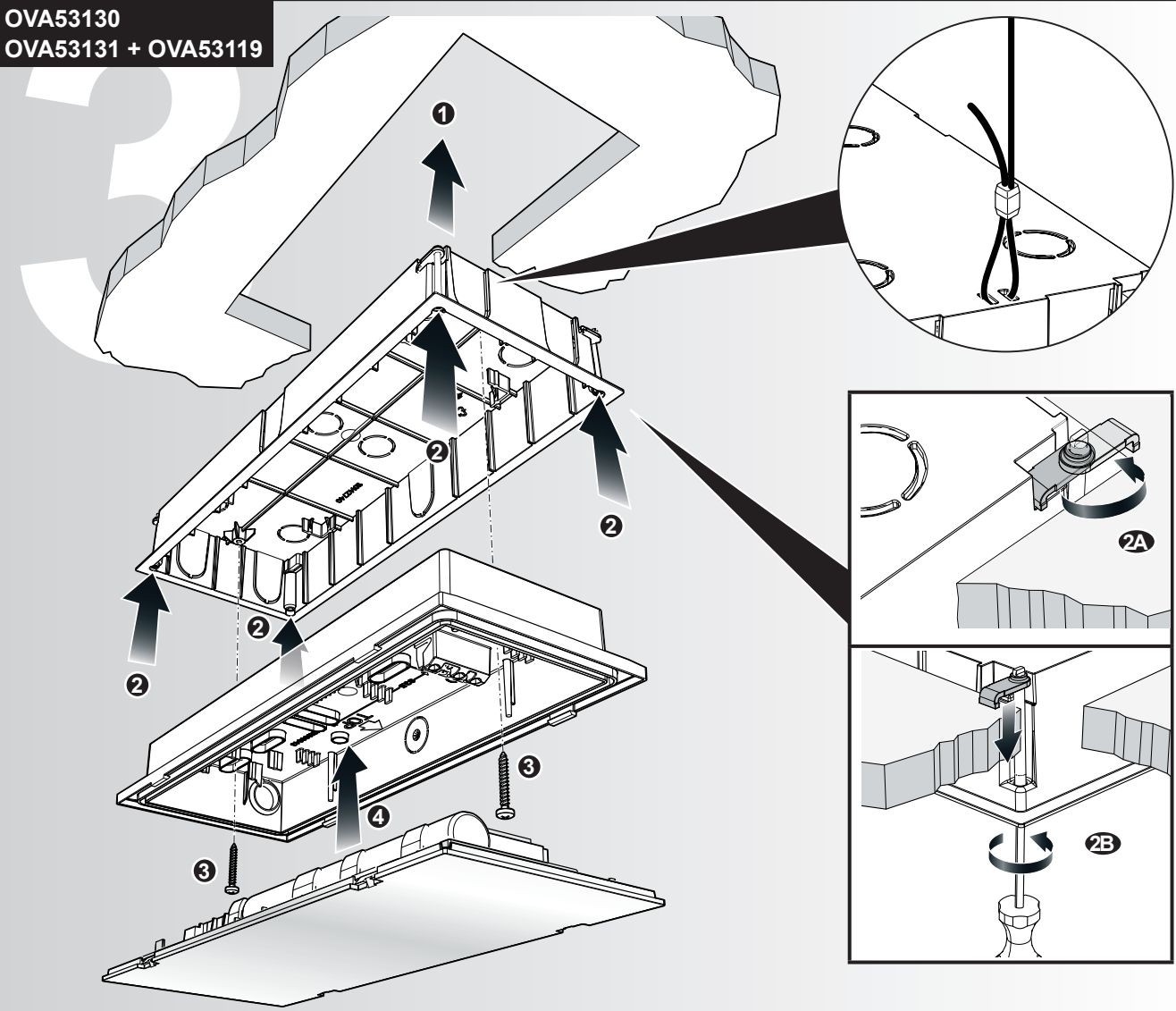
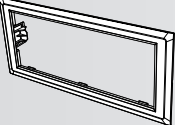
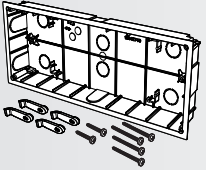
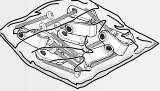
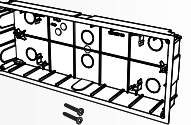
 **SMALTIMENTO**  
Il cassonetto barrato riportato sull'apparecchio specifica che il prodotto alla fine della propria vita utile deve essere consegnato ai centri di raccolta autorizzati o in alternativa riconsegnato al distributore/rivenditore all'atto dell'acquisto di uno nuovo (i prodotti con dimensioni inferiori a 25cm possono essere riconsegnati gratuitamente senza l'acquisto di uno nuovo presso i rivenditori con superficie di vendita di almeno 400m2). L'adeguata raccolta differenziata e il riciclaggio dell'apparecchio dismesso durante la fase di smaltimento favoriscono la conservazione delle risorse naturali e assicurano che venga riciclato in maniera tale da ridurre i possibili effetti negativi sulla salute e sull'ambiente. Per maggiori informazioni sui centri di raccolta, modalità e sui termini della Legge in vigore, rivolgersi all'ufficio competente del proprio ente locale.

 **DISPOSAL**  
The crossed out wheelie bin symbol on the product indicates that at the end of its life the product shall be returned to authorized waste collection centers or to whom has the right to manage it. The proper separate collection and recycling of waste equipment at the time of disposal will help to protect natural resources and ensure that it is recycled in a manner that reduces possible negative effects on human health and the environment. For more information regarding waste collection centers, modalities and terms of law in force, please contact your local waste disposal authority.





Schneider Electric Industries SAS  
35 Rue Joseph Monier  
92500 Rueil Malmaison (France)  
Tél : +33 (0)1 41 29 70 00  
Fax : +33 (0)1 41 29 71 00  
<http://www.se.com>

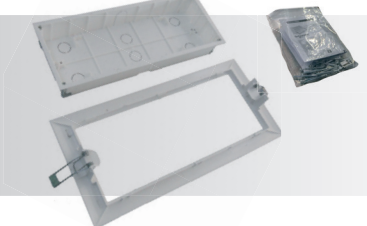

Questo prodotto deve essere installato, collegato ed utilizzato in conformità alle norme in vigore e/o norme di installazione. Per quanto riguarda le normative, specifiche e sviluppo di progetti vogliate di volta in volta chiedere sempre conferma delle informazioni riportate in questa pubblicazione. This product must be installed, connected up and used in accordance with current legislation and/or installation standards. The information regarding standards, specifications and design developments contained in this publication may not be up to date. Always contact us to obtain the latest information.

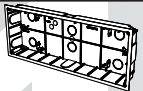
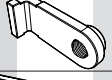
ACCESSORIES

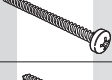
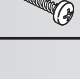

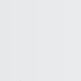
OVA53119  
OVA53120  
OVA53130  
OVA53131

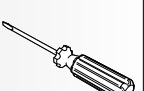
	x 1	OVA53130 OVA53119
	x 4	OVA53130
	x 12	OVA53131
	x 1	OVA53120
	x 4	OVA53130
	x 12	OVA53131
	x 2	OVA53130 OVA53119



Dimensioni / Dimensions

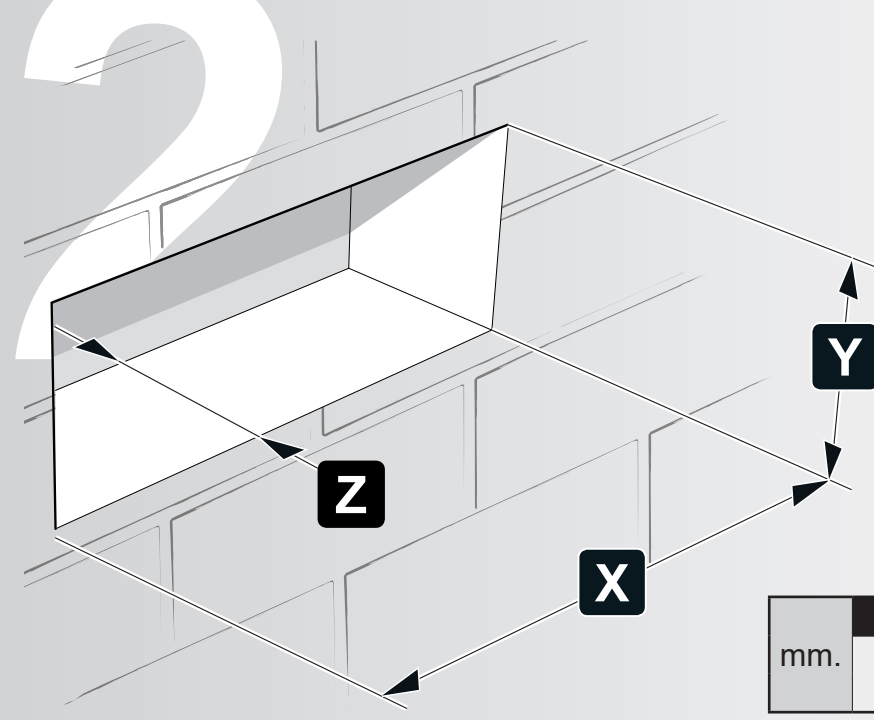

X  
Y  
Z

mm.	X	Y	Z	
	282	106	39	OVA53119
				OVA53130

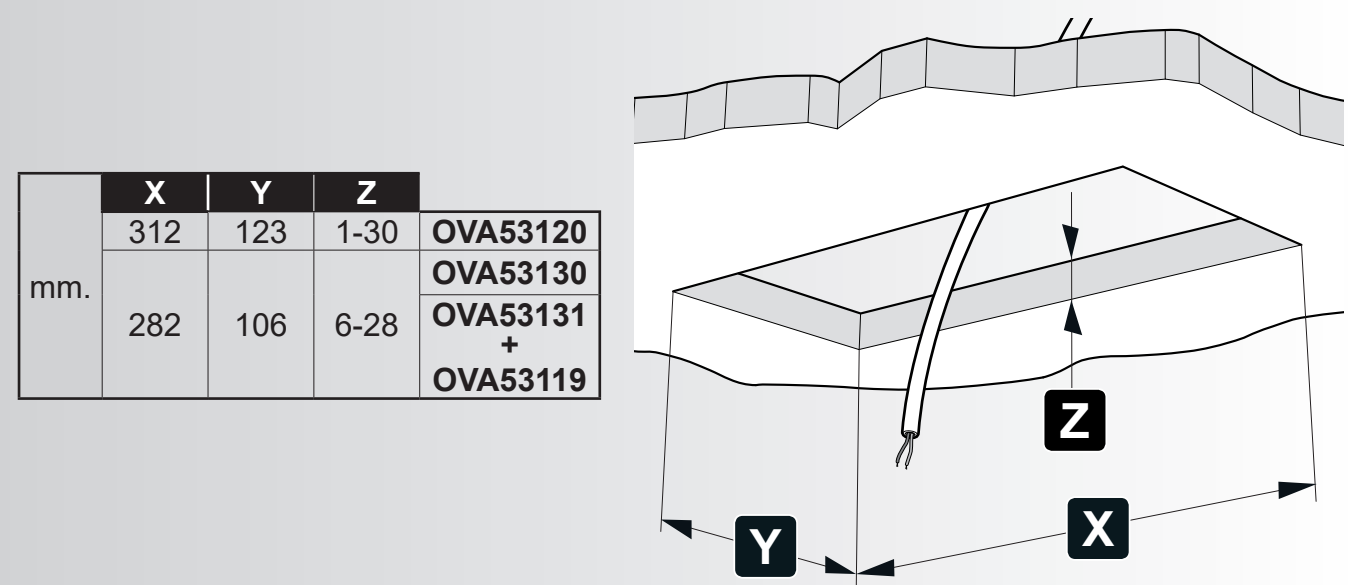

X  
Y  
Z

mm.	X	Y	Z	
	312	123	1-30	OVA53120
	282	106	6-28	OVA53130
				OVA53131 + OVA53119

OVA53120

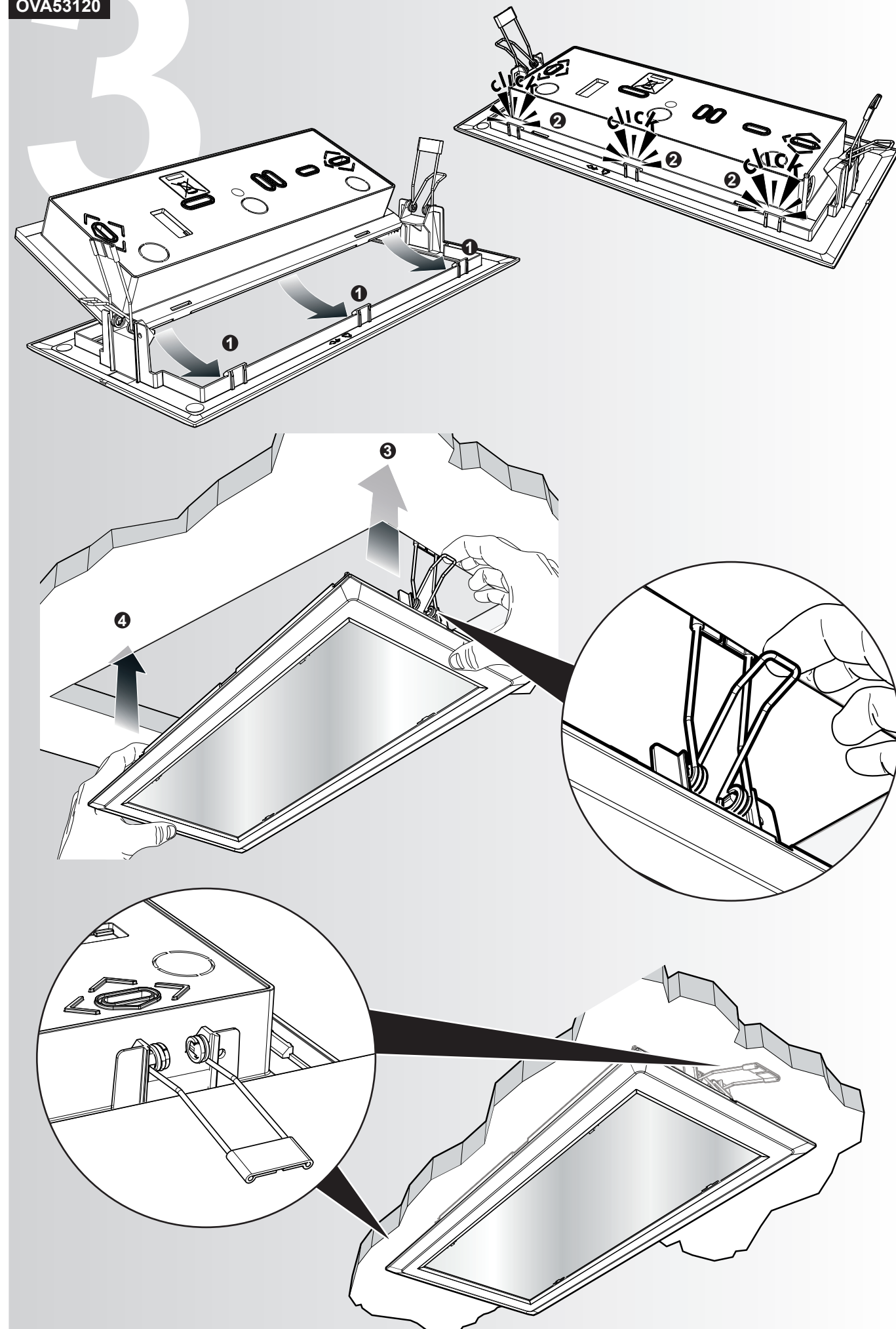

OVA53119

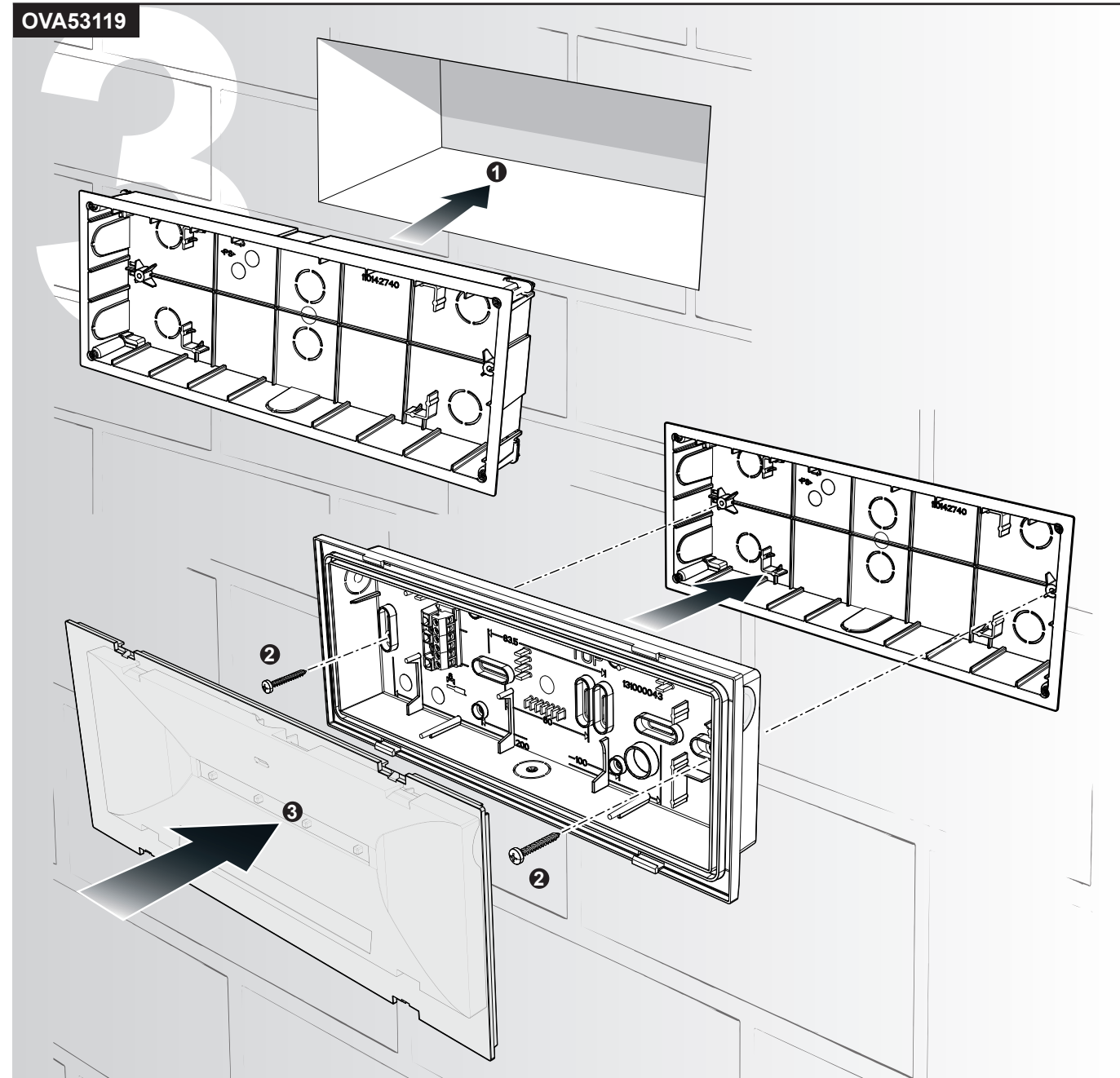

OVA53131

