

Data Sheet | Item Number: 726-632

Common potential matrix patchboard; Marking 1-24; with 2 input modules incl. end plate; Color of modules: blue; Numbering of modules arranged vertically; for 19" racks; Slimline version; blue/dark gray



<https://www.wago.com/726-632>



Color: blue/dark gray

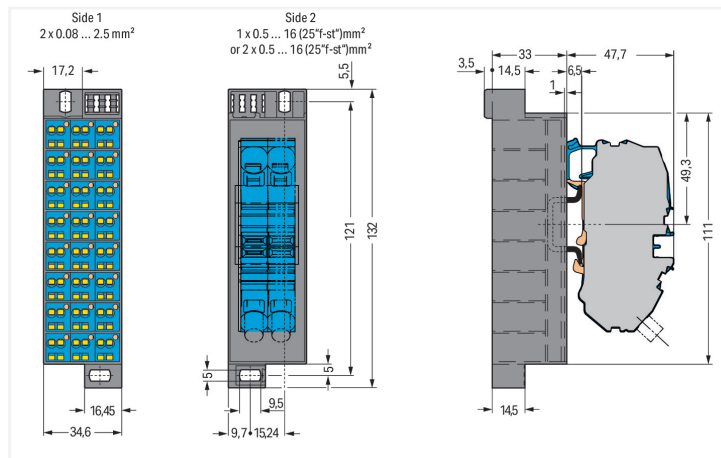

Dimensions in mm

Common potential matrix patchboard, 726 Series, operating tool

This common potential matrix patchboard (item number 726-632) is designed for fault-free electrical installations. Ensure that the strip lengths are between 8 and 10 mm when connecting conductors to this common potential matrix patchboard. This product incorporates conductor terminals and utilizes CAGE CLAMP® and Push-in CAGE CLAMP®. Push-in CAGE CLAMP® connection technology is ideal for connecting all conductor types. Both solid and fine-stranded conductors with ferrules can be pushed in without needing to use any tools—all thanks to its pluggable design. Our celebrated universal connection known as CAGE CLAMP® is the industry standard for connection technology and electrical interconnections. The item's dimensions are (34.6 x 132 x 84.2) mm (width x height x depth). This common potential matrix patchboard is suitable for conductor cross sections ranging from 0.08 mm² to 2.5 mm² on one side and for conductor cross sections ranging from 0.2 mm² to 16 mm² on the other side.

Electrical data

Ratings per IEC/EN

Rated current 24 A

Ratings per IEC/EN 2

Rated current 76 A

General information

Wiring direction Front-entry wiring

Connection Data

Connection 1

Connection type	Page 1
Connection technology	CAGE CLAMP®
Number of connection points	2
Actuation type	Operating tool
Connectable conductor materials	Copper
Solid conductor	0.08 ... 2.5 mm ² / 28 ... 14 AWG
Fine-stranded conductor	0.08 ... 2.5 mm ² / 28 ... 14 AWG
Strip length	8 ... 10 mm / 0.31 ... 0.39 inches
Wiring direction	Front-entry wiring

Connection 2

Connection type	Side 2
Connection technology	Push-in CAGE CLAMP®
Number of connection points	2
Solid conductor	0.2 ... 16 mm ² / 24 ... 6 AWG
Fine-stranded conductor	0.2 ... 16 mm ² / 24 ... 6 AWG
Strip length	16 ... 17 mm / 0.63 ... 0.67 inches

Physical data

Width	34.6 mm / 1.362 inches
Height	132 mm / 5.197 inches
Depth	84.2 mm / 3.315 inches

Mechanical data

Marking	1 ... 24
Design	slimline

Material data

Note (material data)	Information on material specifications can be found here
Color	blue/dark gray
Module color	blue
Material group	I
Insulation material (main housing)	Polyamide (PA66)
Flammability class per UL94	V0
Fire load	0.903 MJ
Weight	250.6 g

Commercial data

PU (SPU)	10 (1) pcs
Packaging type	Box
Country of origin	DE
GTIN	4055143608480
Customs tariff number	85369010000

Product Classification

UNSPSC	39121410
eCl@ss 10.0	27-24-26-08
eCl@ss 9.0	27-24-26-08
ETIM 9.0	EC001604
ETIM 10.0	EC001604
ECCN	NO US CLASSIFICATION

Environmental Product Compliance

CAS-No.	7439-92-1
REACH Candidate List Substance	Lead
RoHS Compliance Status	Compliant, No Exemption
SCIP notification number (Austria)	d6049c93-c568-41db-9554-d841126b9f0b
SCIP notification number (Belgium)	29696fab-7542-4744-b2cb-c20e2ba203ba
SCIP notification number (Bulgaria)	7bf9dcaa-79c7-4b3e-850a-b527a505e977
SCIP notification number (Czech Republic)	e5870353-01c3-4df2-a01e-220fa4ab7f57
SCIP notification number (Denmark)	081483b8-ed64-4ac3-ac14-8392c77b26eb
SCIP notification number (Finland)	74b482fb-15f2-4e4d-a35a-ccceb5604d20
SCIP notification number (France)	bf8f11f7-7491-41a1-8d05-c44332621575
SCIP notification number (Germany)	d3e17094-bba0-4c7c-a43d-f00acbd4f302
SCIP notification number (Hungary)	763bcd9b-4224-4c1d-8961-cf267e9c1efc
SCIP notification number (Italy)	1fd39b00-6854-45d6-bcba-382883c5bcd6
SCIP notification number (Netherlands)	4cc63cf4-e7c3-4a7a-b5f4-2f0733b271cc
SCIP notification number (Poland)	d8d5b507-993b-49d1-b1c7-58b34ccdd74e
SCIP notification number (Romania)	1a6f4331-b5db-4223-b77a-12ffed3cc351
SCIP notification number (Sweden)	39324c07-9316-4b4d-bc69-3495a69fb81a

Approvals / Certificates

General approvals



Approval	Standard	Certificate Name
CCA DEKRA Certification B.V.	EN 60998	NTR NL-7986
KEMA/KEUR DEKRA Certification B.V.	EN 60998	71-127356

Declarations of conformity and manufacturer's declarations

Approval	Standard	Certificate Name
EU-Declaration of Confor- mity WAGO GmbH & Co. KG	-	-
UK-Declaration of Confor- mity WAGO GmbH & Co. KG	-	-

Downloads

Environmental Product Compliance

Compliance Search

Environmental Product
Compliance 726-632



CAD/CAE-Data

CAD data

2D/3D Models 726-632



1 Compatible Products

1.1 Optional Accessories

1.1.1 Jumper

1.1.1.1 Jumper



Item No.: 709-107

Wire commoning chain; 0.5 mm²; insula-
ted; gray

1.1.2 Marking

1.1.2.1 Marker



Item No.: 793-5501/000-006

WMB marking card; as card; for terminal
block width 5 - 17.5 mm; stretchable 5 -
5.2 mm; plain; snap-on type; blue



Item No.: 793-5501/000-014

WMB marking card; as card; for terminal
block width 5 - 17.5 mm; stretchable 5 -
5.2 mm; plain; snap-on type; brown



Item No.: 793-5501/000-007

WMB marking card; as card; for terminal
block width 5 - 17.5 mm; stretchable 5 -
5.2 mm; plain; snap-on type; gray



Item No.: 793-5501/000-023

WMB marking card; as card; for terminal
block width 5 - 17.5 mm; stretchable 5 -
5.2 mm; plain; snap-on type; green



Item No.: 793-5501/000-017

WMB marking card; as card; for terminal
block width 5 - 17.5 mm; stretchable 5 -
5.2 mm; plain; snap-on type; light green



Item No.: 793-5501/000-012

WMB marking card; as card; for terminal
block width 5 - 17.5 mm; stretchable 5 -
5.2 mm; plain; snap-on type; orange



Item No.: 793-5501/000-005

WMB marking card; as card; for terminal
block width 5 - 17.5 mm; stretchable 5 -
5.2 mm; plain; snap-on type; red



Item No.: 793-5501/000-024

WMB marking card; as card; for terminal
block width 5 - 17.5 mm; stretchable 5 -
5.2 mm; plain; snap-on type; violet

1.1.2.1 Marker



Item No.: 793-5501

WMB marking card; as card; for terminal block width 5 - 17.5 mm; stretchable 5 - 5.2 mm; plain; snap-on type; white

Item No.: 793-5501/000-002

WMB marking card; as card; for terminal block width 5 - 17.5 mm; stretchable 5 - 5.2 mm; plain; snap-on type; yellow

Item No.: 2009-115

WMB-Inline; for Smart Printer; 1500 pieces on roll; stretchable 5 - 5.2 mm; plain; snap-on type; white

1.1.2.3 Marking strip



Item No.: 2009-110

Marking strips; for Smart Printer; on reel; not stretchable; plain; snap-on type; white

1.1.3 Terminal blocks

1.1.3.1 Supply module



Item No.: 2016-7614

Spare supply terminal block; 16 mm²; 12 mm; Push-in CAGE CLAMP®; 16,00 mm²; blue

Installation Notes

Conductor termination

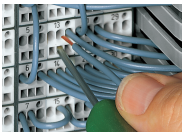

CAGE CLAMP® connection

Inserting a conductor via 210-719 Operating Tool (2.5 x 0.4 mm blade).

Testing



Testing with a 2.3 mm Ø test plug (210-137).

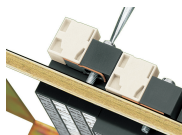

Snapping on an additional module with contact to mounting frame.

Assembling a matrix patchboard with additional module – direct connection to the mounting frame.

Marking



Factory-marked modules (Side 1: 1, 2, 3, 4 ...)

Individual group marking via WMB Multi Marking System