

# Technical data sheet

## T piece 110 FT

Item number: 6225352



T piece, horizontal, with welded rung for all cable ladder types of 110 mm side height.  
Connectors should be ordered separately and in the appropriate quantity.

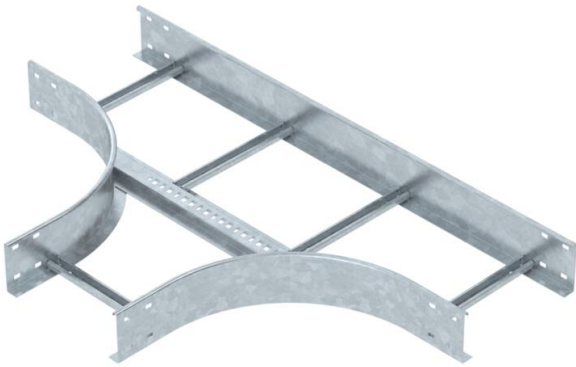

- St** Steel
- FT** Hot-dip galvanised

### Master data

Item number	6225352
Type	SLT 1130 R3 FT
Description 1	T piece
Description 2	for cable ladder
Manufacturer	OBO
Dimension	110x300
Colour	zinc
Material	Steel
Surface	Hot-dip galvanised
Surface standard	DIN EN ISO 1461
Smallest sales unit	1
Unit of quantity	Piece
Weight	969.8 kg
Weight unit	kg/100 pc.
CO2 Footprint (GWP) Cradle-to-Gate	20,7504 kg CO2e / 1 Piece

# Technical data sheet

T piece 110 FT

Item number: 6225352



## Dimensions

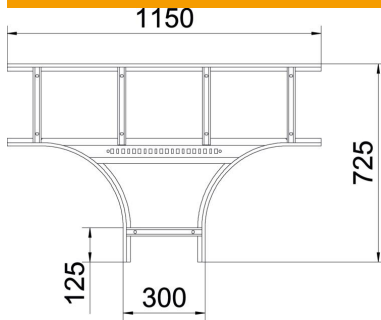

Width	300 mm
Height	110 mm
Dimension B	300 mm
Dimension R	300 mm

## Technical data

Version of the rungs	Profile unperforated
Side rail version	Flat profile
Connector version	Without connectors
Type	Exit symmetrical
Maintain electrical functions	no
Rustproof steel, pickled	no
Wide-span version	no
Rail thickness	2 mm