

MEM Deck valve anti-clockwise closing hot - Brushed Dark Platinum

MEM

20 000 783 Product version from 3/10/2014

- hole diameter 32 mm
- rosette 60 x 60 mm
- with hot marking
- WRAS



	Brushed Dark Platinum	20 000 783-99
	Chrome	20 000 783-00
	Brushed Platinum	20 000 783-06
	Platinum	20 000 783-08
	Dark Chrome	20 000 783-19
	Brushed Light Gold (PVD)	20 000 783-27
	Brushed Durabronze (23kt Gold)	20 000 783-28
	Brushed Dark Brass (PVD)	20 000 783-39
	Brushed Bronze (PVD)	20 000 783-42
	Brushed Dark Bronze (PVD)	20 000 783-43
	Brushed Champagne (22kt Gold)	20 000 783-46
	Champagne (22kt Gold)	20 000 783-47

20 000 783 Product version from 3/10/2014

mm [inches]

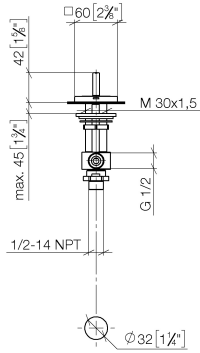

Flow rate chart

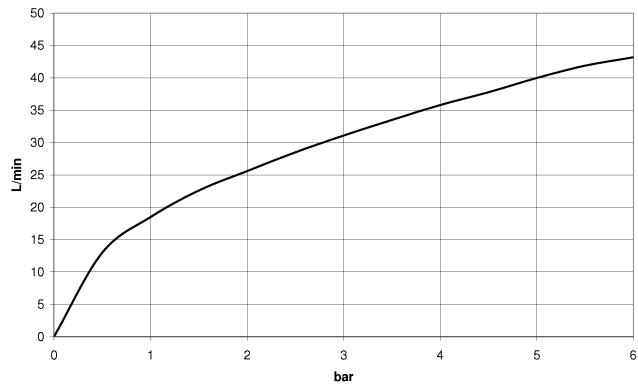

Codes & Standards

ASME A112.18.1

cUPC

Scottish Water
Byelaws

UK Water Supply
Regulations



MEM Deck valve anti-clockwise closing hot - Brushed Dark Platinum

MEM

20 000 783 Product version from 3/10/2014

Certificates and sustainability

IAPMO_4976	WRAS_2103	EPD-DOR-20230287 -IBA1-EN Environmental.prod uct-declarat
------------	-----------	--

20 000 783 Product version from 3/10/2014

Parts for other finishes can be found here: [Chrome](#)

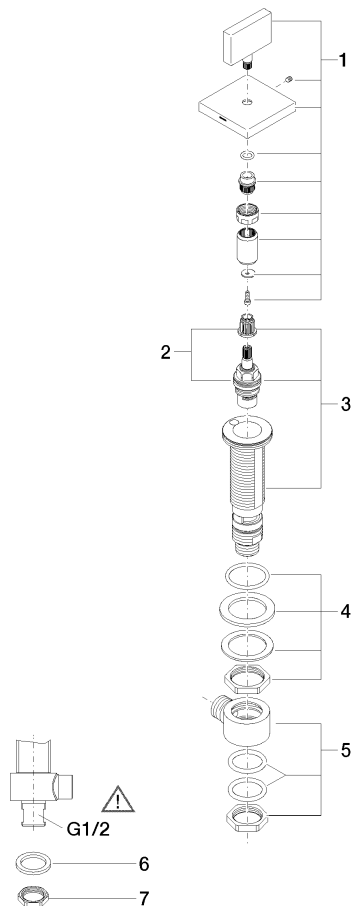

Spare parts list

No.	Item Number	Name	Quantity used	Delivery time
4	04 23 10 032 78 90	Mounting with seals M30 x 1,5 -	1.00	14
5	04 17 11 023 10 90	Connection Distributor, complete 1/2" -	1.00	14
6	09 30 11 059 90	Disc -	1.00	14
1	90 20 78 002 05-99	Handle for side valve Hot 60 x 75 x 60 mm - Brushed Dark Platinum	1.00	40
7	09 23 10 012 90	Mounting Nut SW 24 1/2" -	1.00	14
2	90 90 03 132 00 90	Head part anti-clockwise closing extended, 7mm 1/2" -	1.00	14
3	04 17 11 058 32 90	Side piece anti-clockwise closing, 1/2" -	1.00	14