

Product data sheet Spirotech

Product name

SpiroTrap -22mm -Hor

Product properties

A brass dirt separator with a 22 mm - 2" horizontal connection

- Very small particles, from 5 μm (= 0.005 mm) are separated and removed
- Dirt can be drained while the system is in operation
- No shut-off valves or bypass required
- Constant low pressure drop
- Maintenance only takes a few seconds and is not a dirty job compared to a filter solution
- Applicable with 50/50 Ethylene Glycol / Water (Volume)
- No unnecessary downtime
- Horizontal connections
- Connection diameters from 22 mm to 2" (G2)

Article number

AE022

Product image



Product dimensions

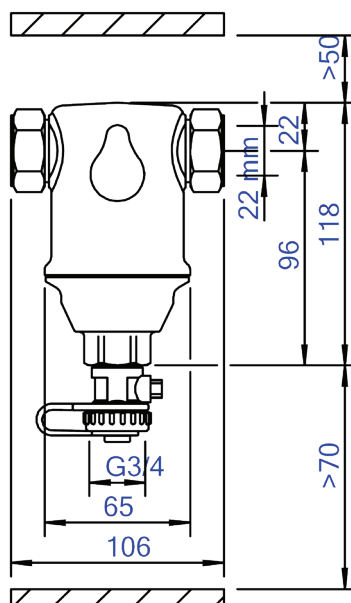

Product data sheet Spirotech

ETIM product data

Housing material	Brass
With drain valve	Yes
Housing material quality	Other
Backwash filter	No
Max. operating pressure	10 bar
Variable flow direction	Yes
With insulation	No
Separator type	Dirt
Connection	Compression ring
Model	Horizontal
Nominal diameter	Other
Max. glycol mixture	50 %
Suitable for heating	Yes
Suitable for cooling	Yes

Outer pipe diameter	22 mm
Construction length	106 mm
Article compression class	PN 10
Surface protection	Untreated
Suitable for open system	No
Suitable for solar	No
With dismountable filter	No
Filter volume	0.18 l
Magnet operating principle	No
Cleaning possible during operation	Yes
Material of connection	Brass
Inlet/outlet offset distance	0 mm
Material quality connection	Other
Operating principle	Other

Disclaimer

This product sheet has been compiled with the greatest possible care. Nevertheless, it may contain errors or omissions. For the most current and correct information we refer you to our website.

