

Product data sheet Spirotech

Product name

SpiroTrap -DN65 -Weld

Product properties

A steel dirt separator for standard flow rate (1.5 m/s) with a DN50 - DN150 weld connection

- Very small particles, from 5 μm (= 0.005 mm) are separated and removed
- Dirt can be drained while the system is in operation
- No shut-off valves or bypass required
- Applicable with 50/50 Ethylene Glycol / Water (Volume)
- Constant low pressure drop
- Maintenance only takes a few seconds
- No unnecessary downtime
- Weld connection
- Connection diameters from DN50 to DN 150, larger connection diameters on request

Article number

BE065L

Product image



Product dimensions

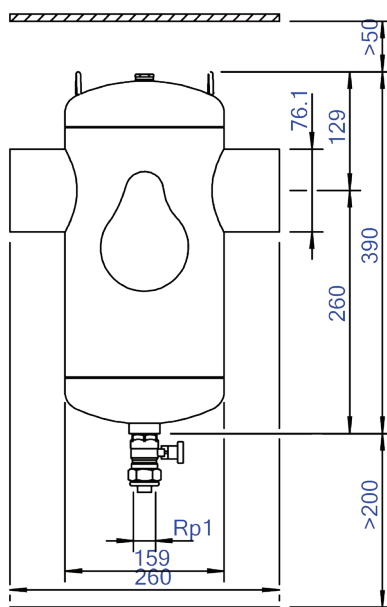

Product data sheet Spirotech

ETIM product data

Housing material	Steel	Article compression class	PN 10
With drain valve	Yes	Surface protection	Lacquered
Housing material quality	St 37 (1.0254)	Suitable for open system	No
Backwash filter	No	Suitable for closed system	Yes
Max. operating pressure	10 bar	Suitable for solar	No
Variable flow direction	Yes	With dismountable filter	No
With insulation	No	Filter volume	5 l
Separator type	Dirt	Magnet operating principle	No
Connection	Welded end	With automatic de-aerator	No
Model	Horizontal	With integrated replenishment automat	No
Nominal diameter	DN 65	With couplers	No
Max. glycol mixture	50 %	Cleaning possible during operation	Yes
Suitable for heating	Yes	Material of connection	Steel
Suitable for cooling	Yes	Inlet/outlet offset distance	0 mm
Construction length	260 mm	Flange standard	Other

Disclaimer

This product sheet has been compiled with the greatest possible care. Nevertheless, it may contain errors or omissions. For the most current and correct information we refer you to our website

