

## Data Sheet | Item Number: 893-129

Tap-off module; for flat cable; 2-pole; with cable connection on the output side; light gray

<https://www.wago.com/893-129>



Color: ■ light gray

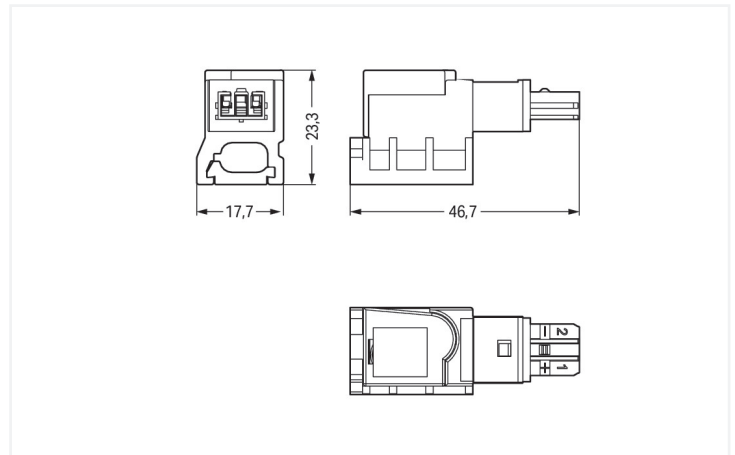

Dimensions in mm

### Tap-off module WINSTA® IDC F coding

The WINSTA® IDC tap-off module F coding supports fast, reliable installation. Our pluggable installation connectors with spring pressure connection technology function entirely without screw connections. They allow resource-efficient, error-free installation in a large number of applications. For greater protection in electrical installations, the pluggable installation connector is provided with mechanical protection against mismatching. The pluggable installation connector is protected in accordance with protection type IP20 (When mated: IP2xC (These compact connectors are not designed for use in open, easily accessible areas!)). This means that users' fingers will never come into contact with live elements. The standardised KNX interface represents a manufacturer-independent communication protocol for intelligently networking state-of-the-art home and building system technologies. The grey WINSTA® IDC pluggable installation connectors in F coding support applications in the low-voltage domain.

WINSTA® IDC solutions for your electrical installation – protected against mismatching and maintenance-free

The WINSTA® Pluggable Connection System allows pluggable electrical installation. This saves time, lowers costs, and reduces the need for servicing. Now you can also lower installation expenses without compromising safety and quality: with marking eliminates the need for servicing and prevents unnecessary downtime.

- effective protection against mismatching
- products perfectly tailored to your requirements guarantee safe use
- with F coding for the use in supplying power
- flexible installation to save space
- rapid, structured electrical installation

### Electrical data

Rated per	IEC/EN 60664-1		
Overvoltage category	III	III	II
Pollution degree	3	2	2
Nominal voltage	50 V	-	-
Rated impulse withstand voltage	0.8 kV	-	-
Rated current	3 A	-	-

### General information

Note on contact resistance	approx. 1 mΩ of contact resistance approx. 0.25 mΩ contact transition plug/ socket
----------------------------	--

## Connection Data

Total number of potentials	2	<b>Connection 1</b>	
		Connection technology	IDC connection
		Actuation type	Operating tool
		Pole number	2

## Physical data

Width	17.7 mm / 0.697 inches
Height	23.3 mm / 0.917 inches
Depth	46.7 mm / 1.839 inches

## Mechanical data

Technology	KNX
Coding	F
Variable coding	No
Marking	1+ 2-
Potential marking	1+ 2-
Retention force of a plug-in connection	When locked: > 80 N
Number of mating cycles	200
Protection type	IP20; When mated: IP2xC (These compact connectors are not designed for use in open, easily accessible areas!)
Suitable	for flat cable 2 x 1.5 mm <sup>2</sup>

## Plug-in connection

Mismating protection	Yes
Note on mismating protection	All <i>WINSTA</i> ® components are 100% protected against mismating when: a.) plugging different numbers of poles b.) plugging while rotated 180 c.) plugging while laterally staggered d.) plugging one pole

## Material data

Note (material data)	<a href="#">Information on material specifications can be found here</a>
Color	light gray
Insulation material (main housing)	Polyamide (PA66)
Flammability class per UL94	V0
Contact material	Copper or copper alloy; surface-treated
Contact Plating	Tin
Fire load	0 MJ
Weight	15.6 g

## Environmental requirements

Processing temperature	-5 ... +40 °C
Continuous operating temperature	-35 ... +85 °C
Note on continuous operating temperature	Cable for temperatures ≤ 70 °C (including halogen-free) Flat cable for temperatures -15 °C to ≤ 70 °C (including halogen-free) Insulating parts for temperatures ≤ 105 °C

**Commercial data**

PU (SPU)	50 pcs
Packaging type	Box
Country of origin	CH
GTIN	4050821471721
Customs tariff number	85366990990

**Product Classification**

UNSPSC	39121421
eCl@ss 10.0	27-44-06-01
eCl@ss 9.0	27-44-06-01
ETIM 9.0	EC002588
ETIM 10.0	EC002588
ECCN	NO US CLASSIFICATION

**Environmental Product Compliance**

RoHS Compliance Status	Compliant, No Exemption
------------------------	-------------------------

**Downloads**

**Environmental Product Compliance**

<b>Compliance Search</b>	
Environmental Product Compliance 893-129	<a href="#">↓</a>

**Documentation**

<b>Bid Text</b>			
893-129	19.02.2019	xml 2.96 KB	<a href="#">↓</a>
893-129	09.01.2015	doc 23.50 KB	<a href="#">↓</a>

**CAD/CAE-Data**

<b>CAE data</b>	
EPLAN Data Portal 893-129	<a href="#">↓</a>
WSCAD Universe 893-129	<a href="#">↓</a>

## 1 Compatible Products

### 1.1 System counterpart

#### 1.1.1 Male connector/plug



**Item No.: 893-1032**

Plug; with strain relief housing; 2-pole;  
Cod. F; light gray

## 1.2 Optional Accessories

### 1.2.1 Cables and connectors

#### 1.2.1.1 Flat cable



**Item No.: 897-122**

Flat cable; Dca; 2 x 1.5 mm<sup>2</sup>; halogen-free;  
2 buses; 50 V; 1,50 mm<sup>2</sup>; light gray



**Item No.: 897-121**

Flat cable; Eca; 2 x 1.5 mm<sup>2</sup>; PVC; 2 buses;  
50 V; 1,50 mm<sup>2</sup>; light gray

## Installation Notes

### Conductor termination

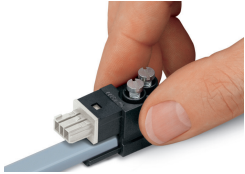

The IDC module can only be mounted if the two codings match each other.

Should the IDC module jam during mounting, turn the module by 180° and remount it, flush with the base.



Tighten the screws to connect the flat cable.

Observe 1 Nm of tightening torque!

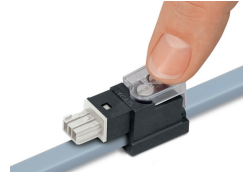

Snap the transparent protective cover onto the module.

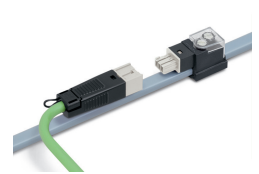

Connect the cable assembly to the module.