

Deck valve anti-clockwise closing hot - Brushed Dark Platinum

SERIES SPECIFIC

20 000 741 Product version from 4/1/2023



- hole diameter 32 mm
- handle Ø 60mm
- without rosette
- with hot marking
- WRAS

	Brushed Dark Platinum	20 000 741-99
	Chrome	20 000 741-00
	Brushed Platinum	20 000 741-06
	Dark Chrome	20 000 741-19
	Brushed Light Gold (PVD)	20 000 741-27
	Brushed Durabronze (23kt Gold)	20 000 741-28
	Brushed Gold (PVD)	20 000 741-37
	Brushed Bronze (PVD)	20 000 741-42
	Brushed Champagne (22kt Gold)	20 000 741-46
	Champagne (22kt Gold)	20 000 741-47

20 000 741 Product version from 4/1/2023

mm [inches]

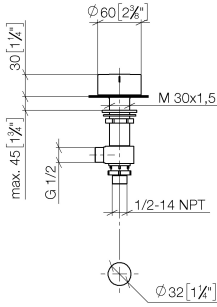

Flow rate chart

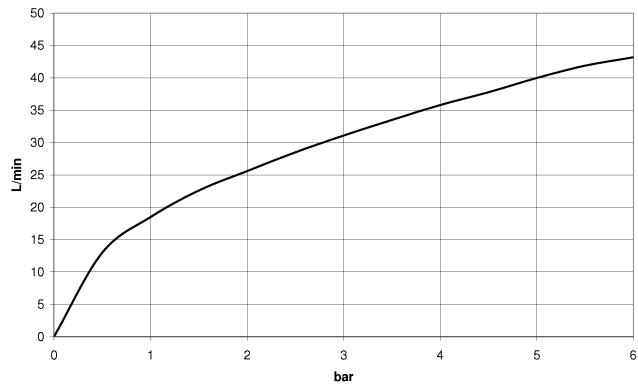

Codes & Standards

ASME A112.18.1	cUPC	DIN 4109	ISO 3822
Scottish Water Byelaws	UK Water Supply Regulations	Ü-Zeichen	



Deck valve anti-clockwise closing hot - Brushed Dark Platinum

SERIES SPECIFIC

20 000 741 Product version from 4/1/2023

Certificates and sustainability

IAPMO_4976

LGA_28

WRAS_2103

EPD-DOR-20230287
-IBA1-EN
Environmental.prod
uct-declarat

20 000 741 Product version from 4/1/2023

Parts for other finishes can be found here: [Chrome](#)

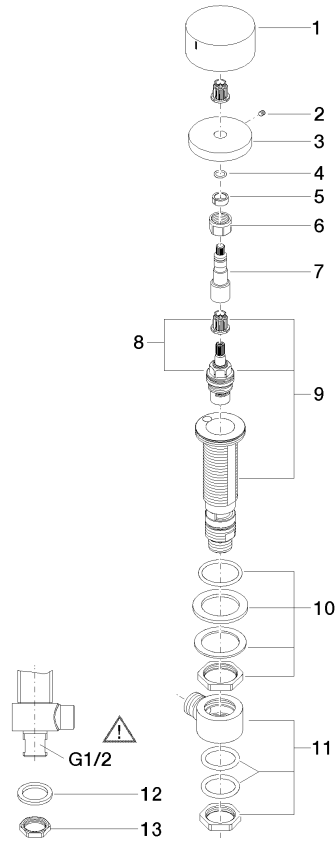

Spare parts list

No.	Item Number	Name	Quantity used	Delivery time
8	90 90 03 132 00 90	Head part anti-clockwise closing extended, 7mm 1/2" -	1.00	14
2	90 31 11 007 00 90	Mounting Threaded pin with hexagon socket M4 x 6 mm	1.00	14
4	90 14 10 060 00 90	O-Ring 8,0 x 1,5 mm -	1.00	14
7	09 29 06 107-00	Extension Spindle extension Ø 16,5 x 55,5 mm - Chrome	1.00	20
5	90 14 15 020 03 90	Support ring -	1.00	14
12	09 30 11 059 90	Disc -	1.00	14
10	04 23 10 032 78 90	Mounting with seals M30 x 1,5 -	1.00	14
1	09 20 74 006-99	Handle Hot Ø 60 x 29 mm - Brushed Dark Platinum	1.00	40
11	04 17 11 023 10 90	Connection Distributor, complete 1/2" -	1.00	14
9	04 17 11 058 32 90	Side piece anti-clockwise closing, 1/2" -	1.00	14
6	90 23 30 023 00 90	Cap nut -	1.00	14
13	09 23 10 012 90	Mounting Nut SW 24 1/2" -	1.00	14
3	09 27 74 003-99	Rosette Ø 50 x 9,5 mm - Brushed Dark Platinum	1.00	40