

Product End of Life Instructions

**Altivar Process ATV930, Variable speed drive, 90kW, 380 to 480V,
3 phases, IP21**

Altivar Process ATV900





Potential disassembly risks

The information provided in this document assumes that the product is completely de-energized and uninstalled (refer to the instructions provided in the appropriate product manuals).

Dismantling/disassembling the product may entail hazards caused by, for example, sharp edges, chemical aggression or ejected parts.

▲ WARNING

HAZARD DUE TO INSUFFICIENT PROTECTION

- Implement all safety measures required by the applicable regulations and by the processes used to dismantle/disassemble and dispose of the product.
- Use all necessary personal protective equipment such as gloves and goggles.

Failure to follow these instructions can result in death or serious injury.

End of Life Instructions

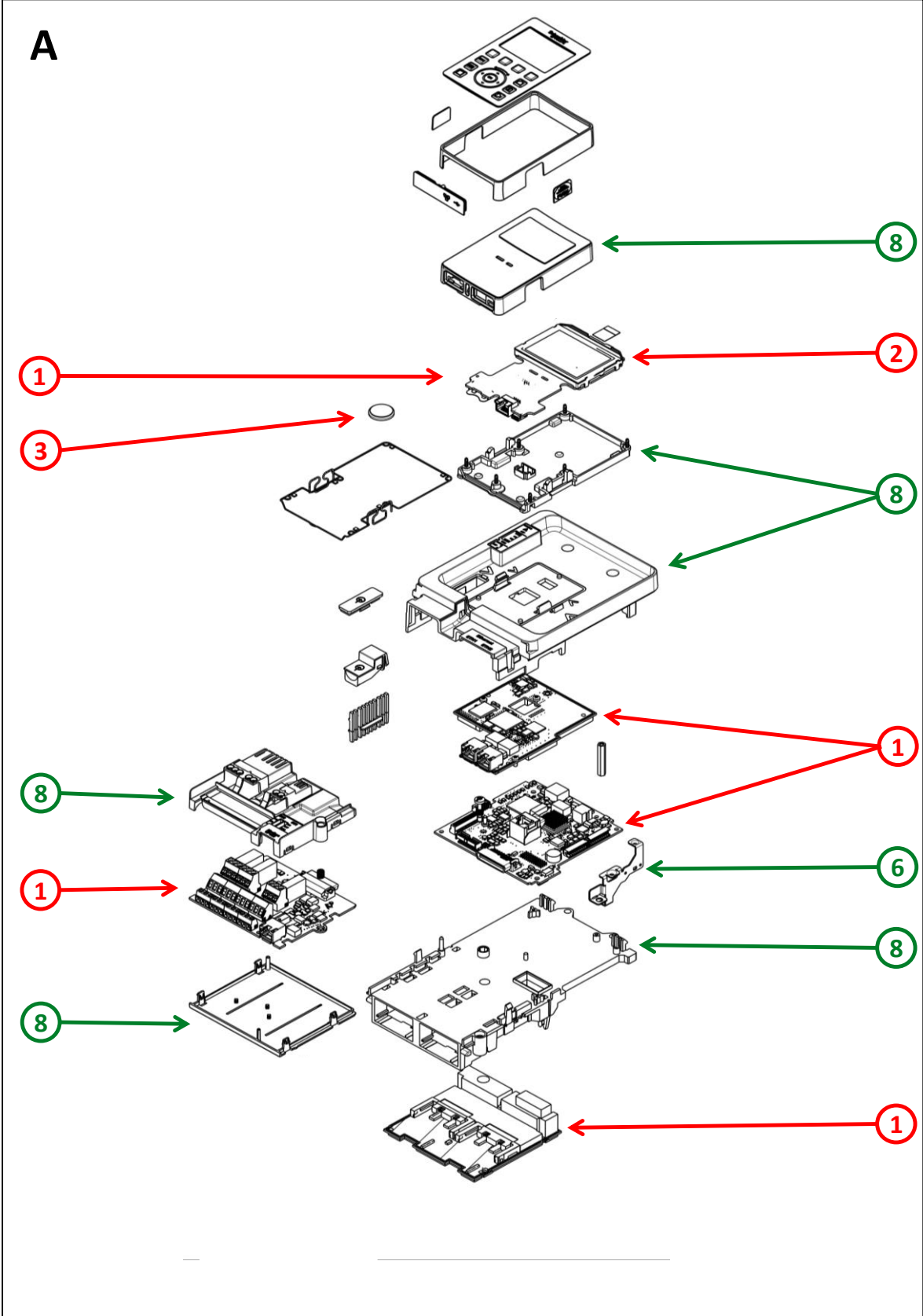

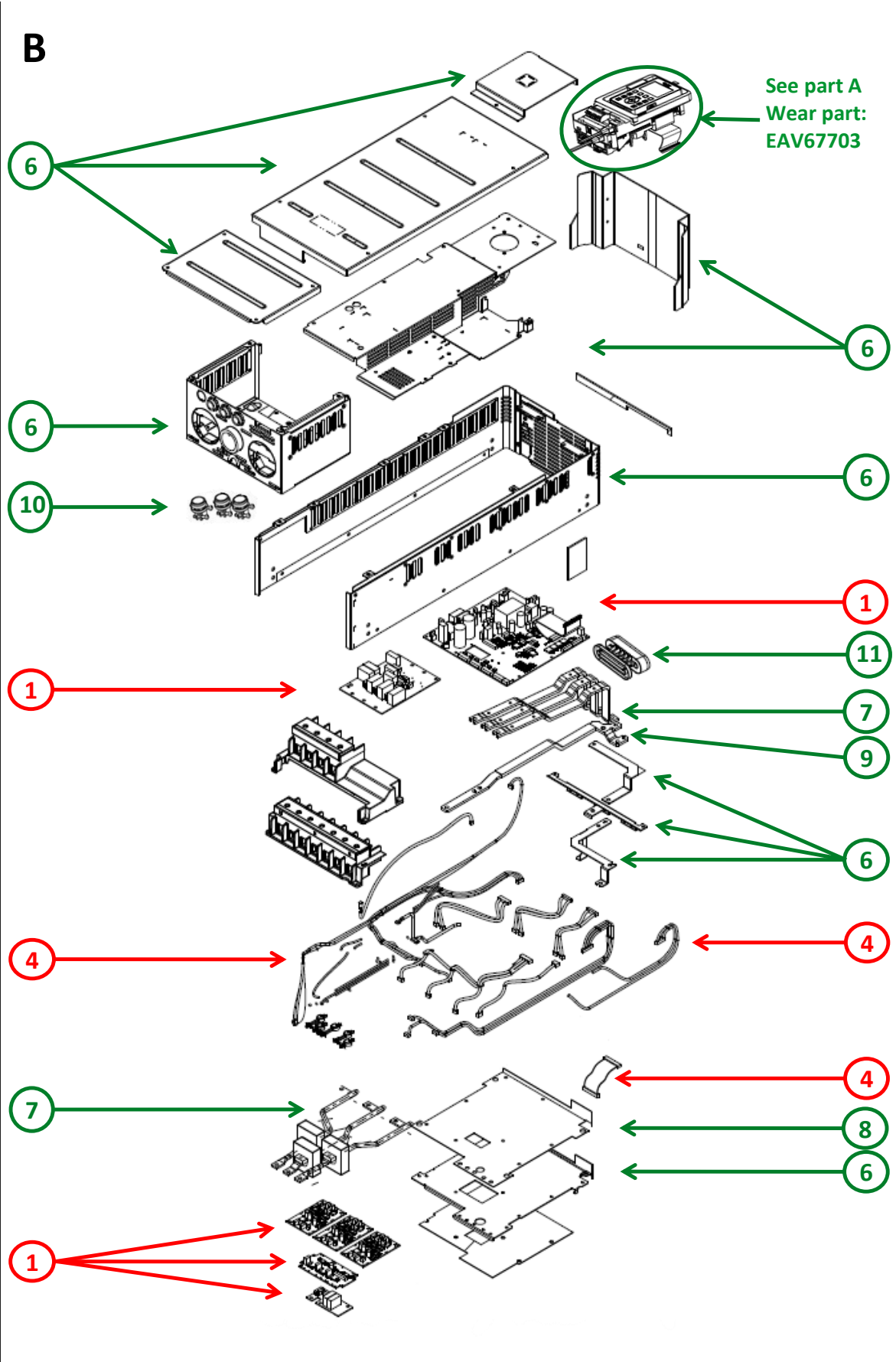

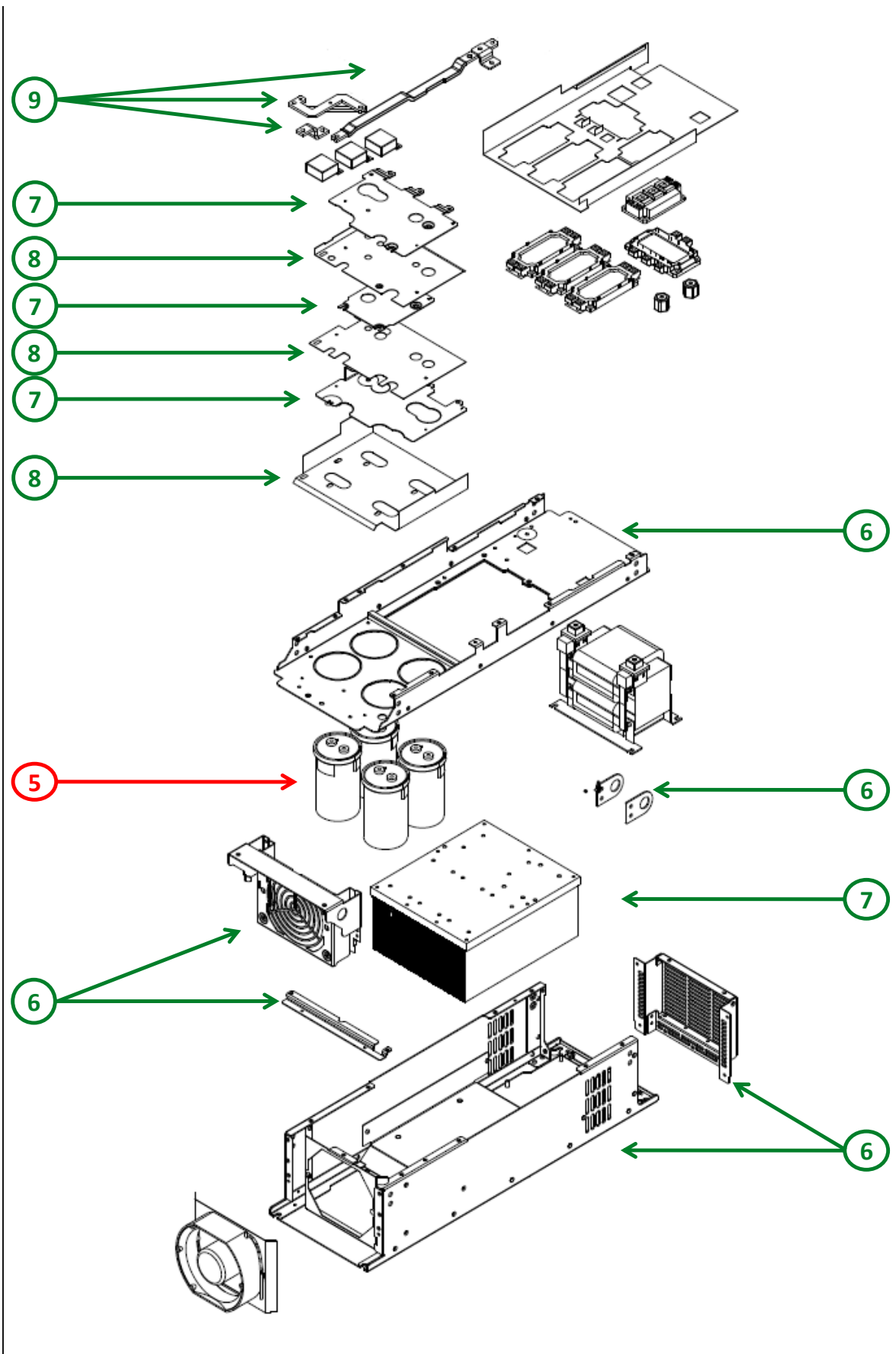

Recommendation	Number on drawing	Component / Material	Weight (in g)	Comment
To be depolluted	1	Electronic Board (Power and Communication) > 10cm ²	3653	
To be depolluted	2	LCD (surface > 100cm ²) and all those back-lighted with gas discharge lamps	26	
To be depolluted	3	Battery	3	Lithium content: 0,07 g
To be depolluted	4	Cable (high current)	705	
To be depolluted	5	Electrolyte capacitors which size: height > 25 mm, diameter > 25 mm or	3200	
To be dismantled	6	Steel	25326	Covers - Front Panel - Housings - Grounding - Supports - Chassis -
To be dismantled	7	Aluminium	10937	Links - Heatsink
To be dismantled	8	PC, ABS-PC, PA, PA6, HDPE, SAN with or without additive, PP+EPDM and PP	348	Insulation sheets - Back Housing - ADV Facade - Control Housing - Relay Cover Control Chassis
To be dismantled	9	Copper	61	Links
To be dismantled	10	Zinc	974	Cable Gland
To be dismantled	11	Ferrite	95	Ferrite Bead
Other			13172	

Product description

Manufacturer identification	Schneider Electric Industries SAS
Brand name	Schneider Electric
Product function	The main function of the Altivar Process product range is the speed control and variation of a synchronous or asynchronous electric motor for fluid management and industrial applications.
Product reference	ATV930D90N4
Description of the range	This range consists of products Altivar Process ATV900 designed for industrial processes in the following market segments: oil and gas, mining, minerals and metals, food and beverage water and wastewater. The rating is from 30 to 90 kW (40 to 125 HP).
Total representative product mass	58,5 kg
Representative product dimensions	922mm x 290mm x 323mm
Accessories	No accessories needed
Date of information release	01/12/2025

Additional information

Legal information	The product family must be disposed according to the legislation of the country. This document is intended for use by end of life recyclers or treatment facilities. It provides the basic information to assure an appropriate end of life treatment for the components and materials of the product.
In case of special transportation: transportation method	No special transportation
Recyclability potential	85% The recyclability rate was calculated from the recycling rates of each material making up the product based on REEECY'LAB tool developed by Ecosystem, for components/materials not covered by the tool, data from the EIME database and the related PSR was taken. If no data was found a conservative assumption was used (0% recyclability).

Schneider Electric Industries SAS

*Country Customer Care Center
<http://www.se.com/contact>*

35, rue Joseph Monier

CS 30323

F- 92500 Rueil Malmaison Cedex

RCS Nanterre 954 503 439

Capital social 928 298 512 €

www.se.com

ENVEOLI2510023_V1

Published by Schneider Electric

© 2023 - Schneider Electric – All rights reserved

2025-12