



## T0(3)-.../E, T0(3)-.../EZ T0(3)-.../E/SVB, T0(3)-.../EA/SVB

	T0...	T3...
	1 x 0.75 - 1.5mm <sup>2</sup> 2 x 0.75 - 1.5mm <sup>2</sup>	1 x 0.75 - 4.0 mm <sup>2</sup> 2 x 0.75 - 4.0 mm <sup>2</sup>
	1 x 1.0 - 2.5 mm <sup>2</sup> 2 x 1.0 - 2.5 mm <sup>2</sup>	1 x 1.0 - 6.0 mm <sup>2</sup> 2 x 1.0 - 6.0 mm <sup>2</sup>
tightening torque	<b>1 Nm</b> (8.85 lb-in) AWG18 - AWG14	<b>1.6 Nm</b> (14.16 lb-in) AWG14 - AWG10 <b>2 Nm</b> (17.7 lb-in)

T0(3)-.../E

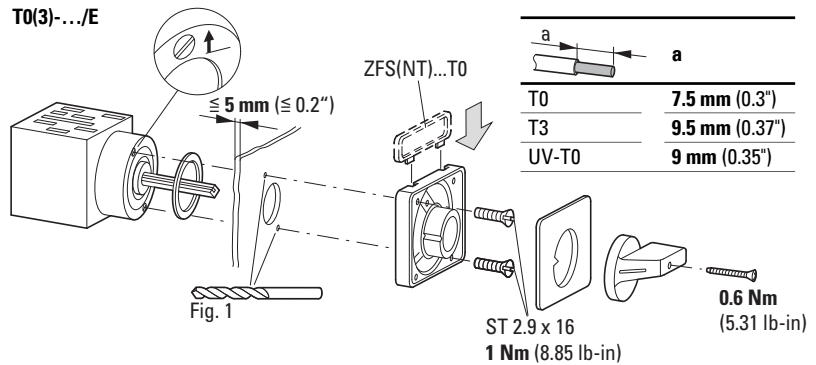

Fig. 1

### UL/CSA:

Suitable For Use As Motor Branch Circuit Disconnecting Means With Suffix SVB. Break All Lines.

Short Circuit Withstand  
10 kA RMS SYM 600 V AC  
Max Fuse T0... - 20 A Class J  
T3... - 40 A Class J

Standard Short Circuit  
5 kA RMS SYM 600 V AC  
Max Fuse T0... - 50 A  
T3... - 40 A  
Max Cir. Bkr. T0... - 50 A  
T3... - 125 A

Switch or enclosure must be padlockable if used as a Motor Branch Circuit Disconnecting means.

T0(3)-.../EZ/OFS  
T0(3)-.../EZ

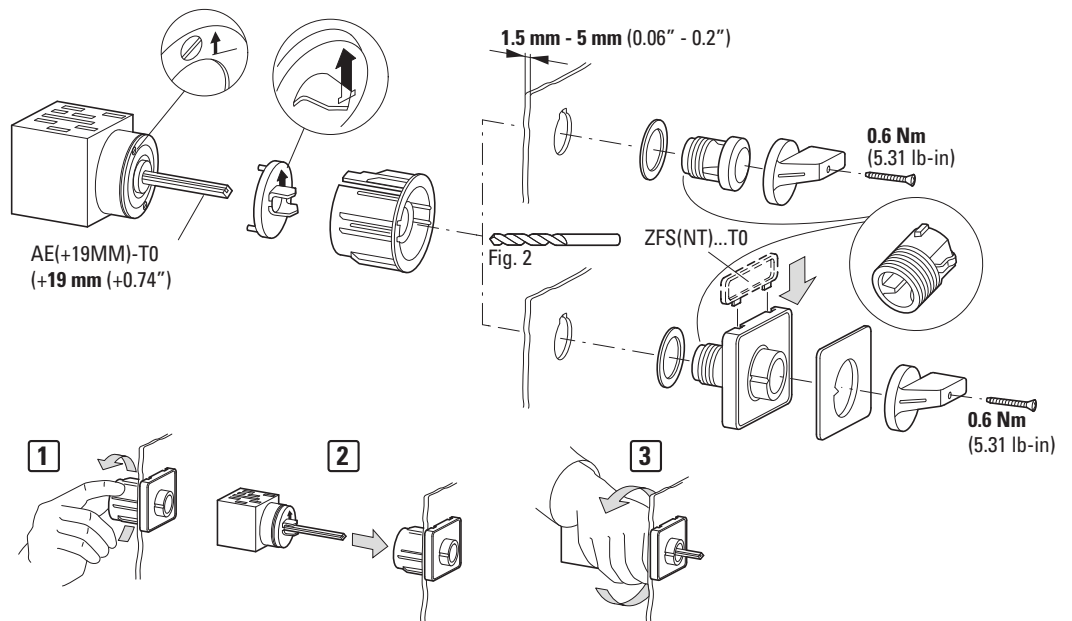

Fig. 1

→ # 1 : 1

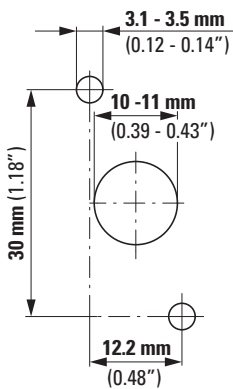
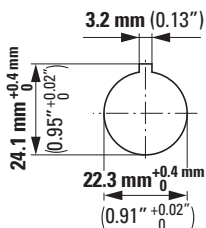
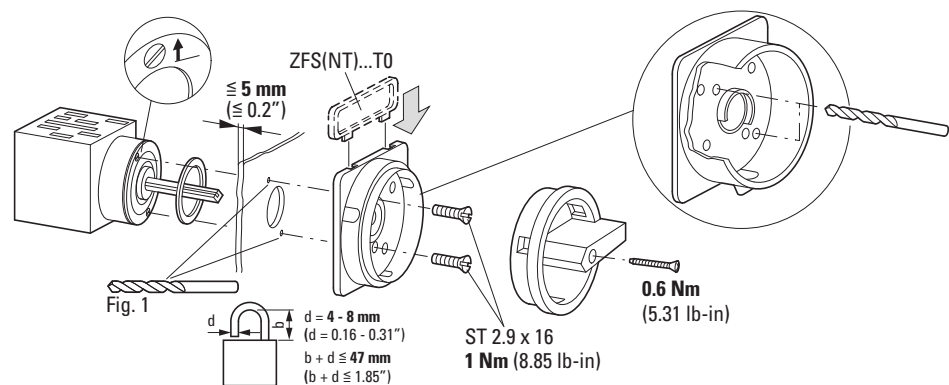

Fig. 2

→ # 1 : 1



T0(3)-.../E/SVB



T0(3)-.../EA/SVB

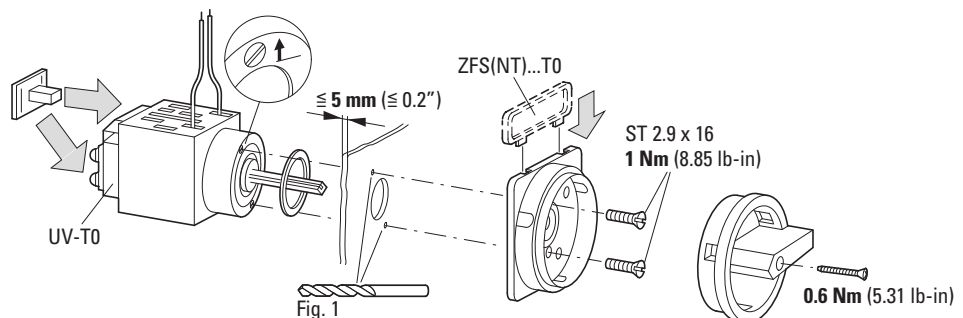

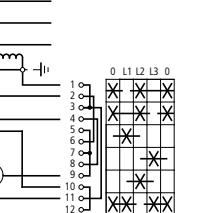
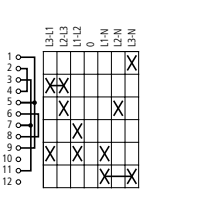
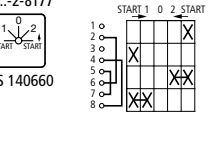
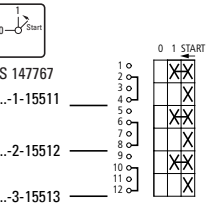
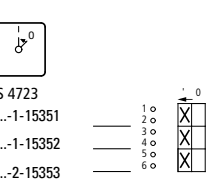
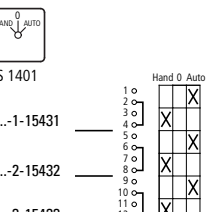
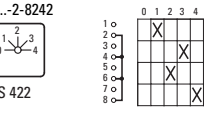
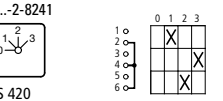
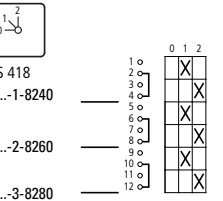
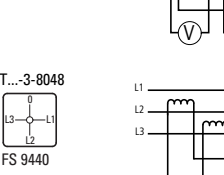
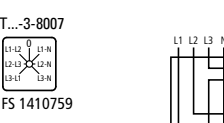
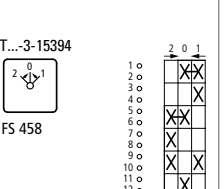
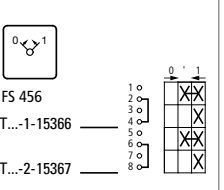
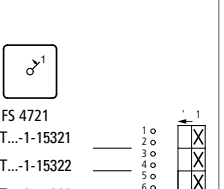
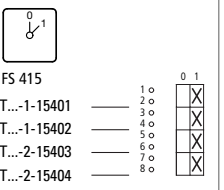
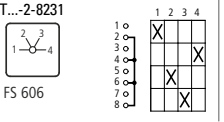
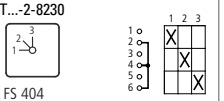
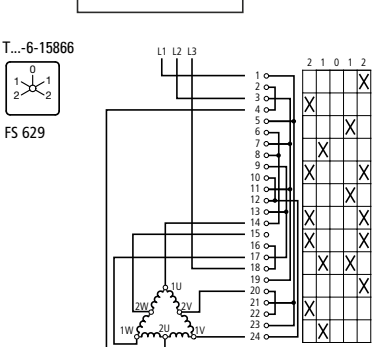
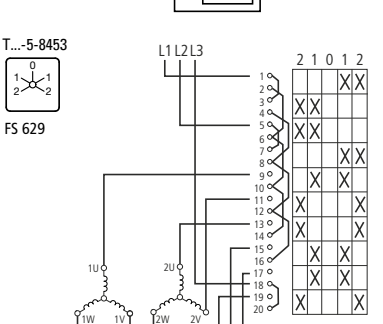
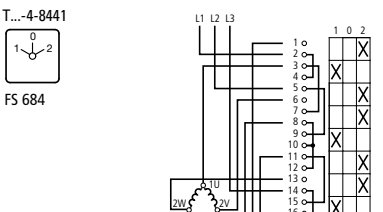
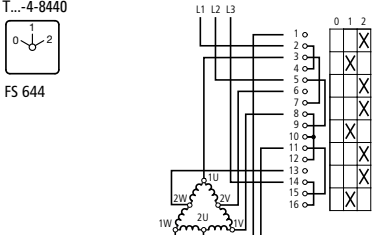
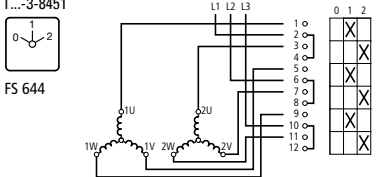
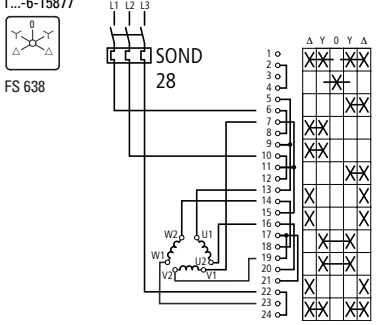
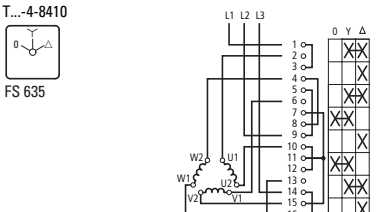
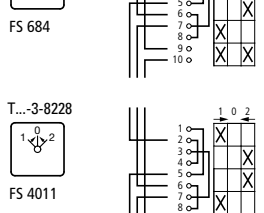
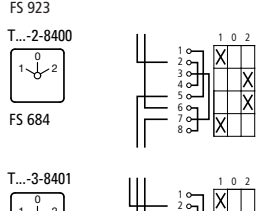
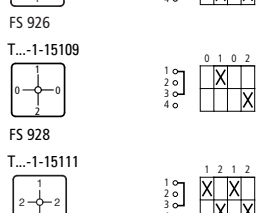
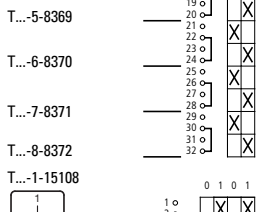
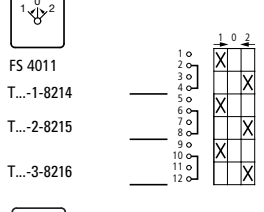
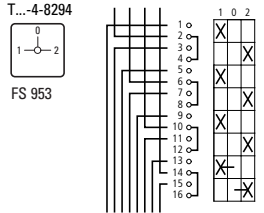
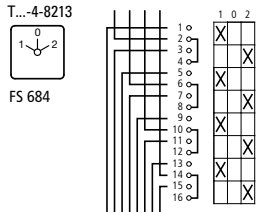
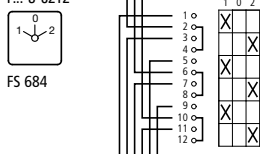
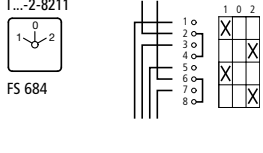
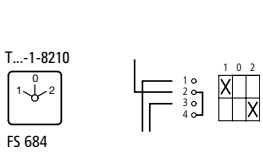
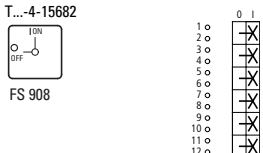
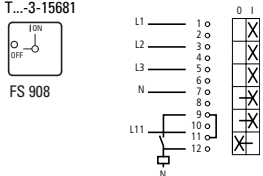
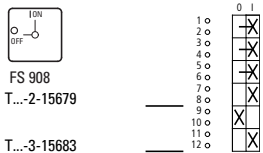
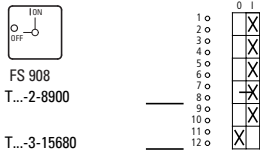
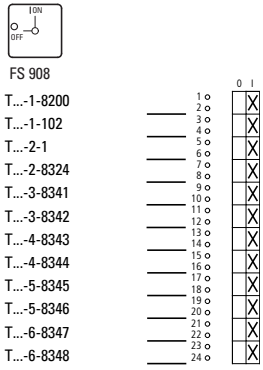

06/21 IL03801020Z