

28 796 710 Product version from 3/13/2017





- rain shower 300 x 240mm
- Rain shower material: metal
- PURE RAIN, max. flow rate 20 l/min (at 3 bar)
- Function from: 12 l/min

**Technical data:**

- quick clearing
- with anti-scale system
- distance between ceiling and lower edge of the shower 165mm
- rosette 78 x 55, as required
- 1/2" connection

**Notes:**

	Chrome	28 796 710-00
	Brushed Platinum	28 796 710-06

**Recommended miscellaneous**



- Concealed wall elbow -** 35 085 970 90
- min. recess depth 90 mm
  - max. recess depth 163 mm

28 796 710 Product version from 3/13/2017

mm [inches]

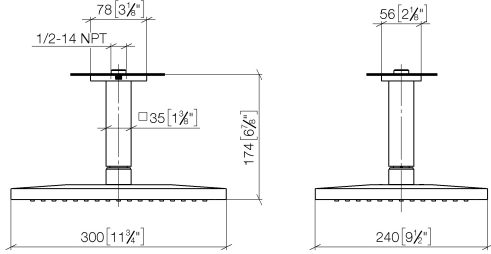

**Flow rate chart**

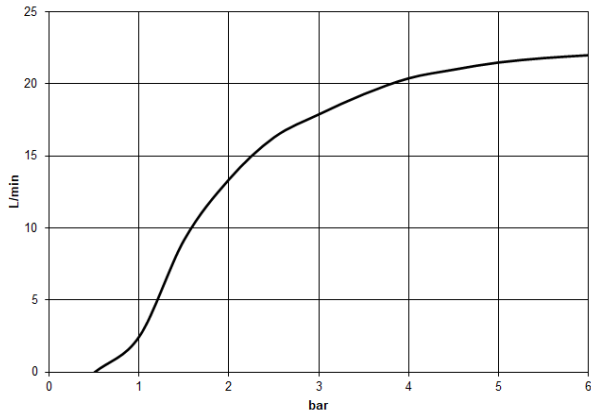

**Codes & Standards**

DIN 4109

ISO 3822

Scottish Water  
Byelaws

UK Water Supply  
Regulations

Ü-Zeichen



## LULU Rainshower with ceiling fixing 300 x 240 mm - Chrome

LULU

28 796 710 Product version from 3/13/2017

### Certificates and sustainability

LGA\_29

LGA\_38

WRAS\_2212

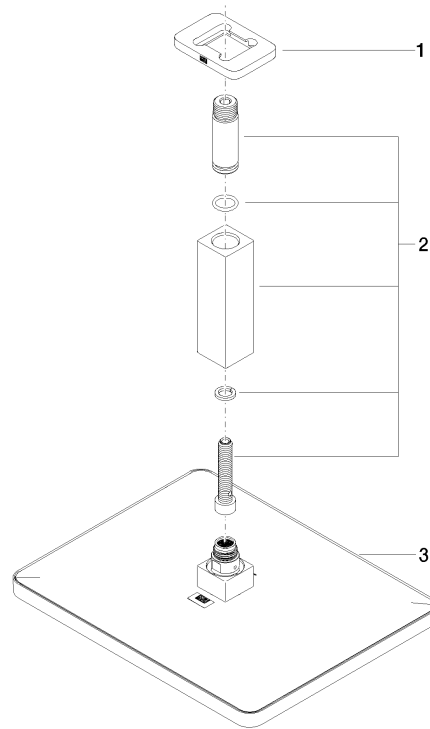

### Spare parts list

No.	Item Number	Name	Quantity used	Delivery time
2	90 11 10 092 00-00	Connection vertical for spray ceiling fixing 35 x 35 x 135 mm - Chrome	1.00	20
3	04 12 05 062 00-00	Rainshower angular G 1/2, 90° 300 x 240 mm - Chrome	1.00	20
1	09 27 71 020-00	Rosette 78 x 55,5 x 9 mm - Chrome	1.00	20