

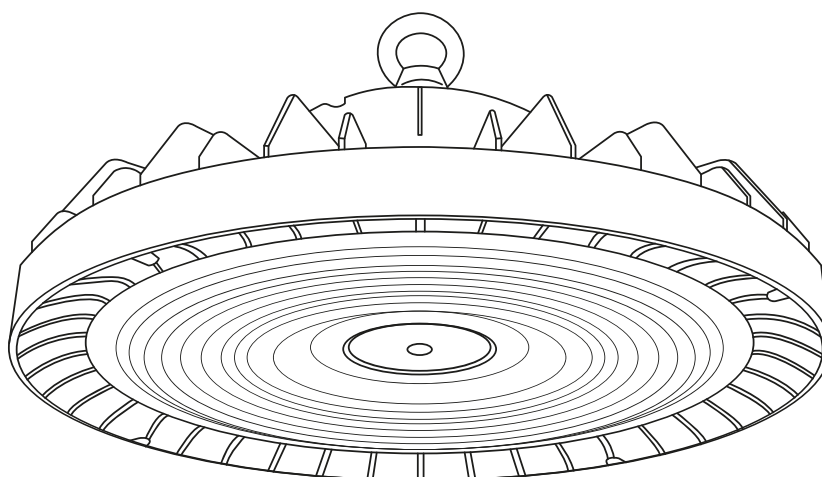

Read these instructions & save for future use

## UFO high bay | 150 watt | 140 Lm/W | 5000K | power/beam adj.



Article number **950-120**

Brand **Tronix Lighting**

Type **Industrial lighting**

Contents of this product **1x 150W high bay 5000K**

Technical datasheet **Digitally available  
on our webshop**



*View instructions and  
technical data also on  
our website*

# TRONIX



## Before first use

Before getting started with this product, it is advisable to check the order completeness and any damage. If this is the case, please contact Tronix Lighting.

## Description

With the help of this high bay you are assured of a large amount of high-quality light and a wide range of light. With the adjustable power and variable beam angle, you always have the perfect amount of light. This makes it suitable not only for the warehouse, storage or workshop, but also for spaces such as shopping malls or exhibition halls.

### Features

- >140 Lm/W High light efficiency;
- Dipswitch for setting: 80W, 100W, 120W, 150W;
- Beam angle adjustable by simply turning the lens into: 60°, 80°, 100°;
- 50,000 burning hours, 5 years warranty.

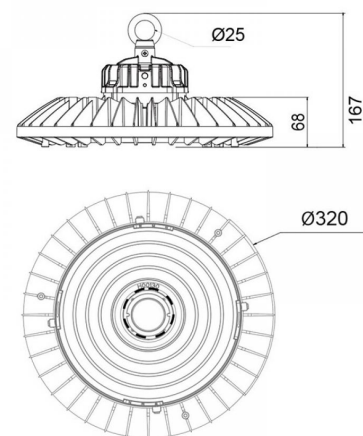

## Installation

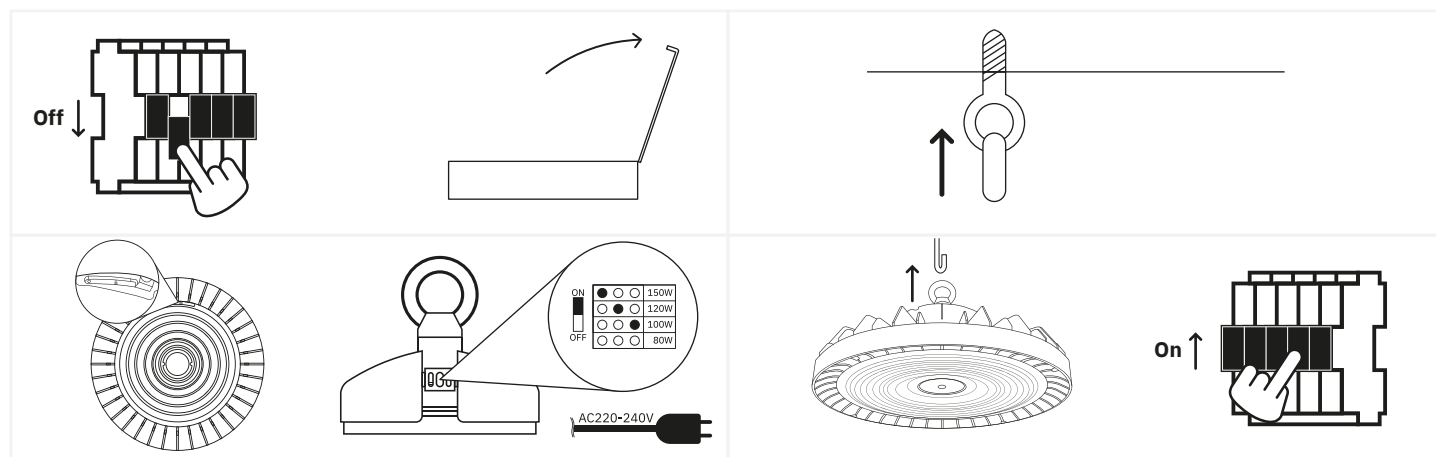

1. Turn off the power and remove the product and associated parts from the packaging...;
2. Attach the hook or other element to the ceiling;
3. Adjust the lens of the high bay lamp, select the maximum wattage, then connect the necessary wiring;
4. Hang the high bay and check the complete installation. Should it be in order, the mains power can be reactivated.



## Safety

Safety is a top priority at Tronix Lighting. Therefore, we heartily recommend that you follow the following steps closely:

- Keep this manual carefully for future reference;
- Choose a qualified electrician while installing, maintaining or inspecting this product;
- Never look directly into a light source to avoid possible damage to the eye;
- Always ensure that the relevant power group is on non-active when the product is connected;
- Use only recommended combinations (LED drivers, controllers or dimmers) to avoid injury or damage to the product.

## Technical problems and repair

Should a product not work properly after installation, or if the product exhibits problems over time, it is advisable to check the following elements:

- Check the wiring and installation of your product;
- Check for the presence of interfering elements such as dust, water or other electronics;
- If possible, try disconnecting the product and testing it in another location to rule out a problem at the location;
- Should you be dealing with a WIFI-based product, check and reset your router's settings.

Should the product still not work after testing, it is recommended to send it in for inspection and/or repair. To do so, please contact Tronix Lighting using nearby details and proof of purchase (packing slip).



CARE



SHARE



CONNECT

### Supplier:

Tronix Lighting B.V

Vluchtoord 41  
5406 XP Uden, Netherlands

+31 (0)413 330 380  
sales@tronixlighting.com

## Terms and symbols (as relevant to product)



The **CE mark** indicates that this product complies with EU regulations on safety, health and environmental protection;



The **WEEE symbol** stands for "Waste Electrical and Electronic Equipment Regulation," a directive on the collection, recycling and recovery of electronic waste;



The **Class I symbol** indicates that this product is protected by means of the additional ground cable. This cable is identified by the yellow/green jacket and is attached to this product.

- This product has an **IP42 rating**. This means that the housing can withstand solid objects larger than 1 mm and will not experience any damage as long as no drops remain on the fixture for an extended period of time.