

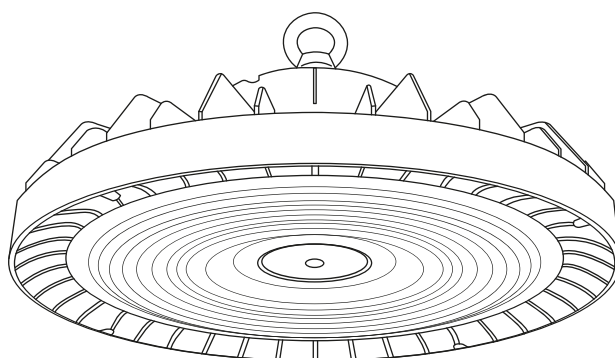

Read these instructions & save for future use

## UFO high bay | 150 watt | 190 Lm/W | 5000K | 90°



Article number **950-111**

Brand **Tronix Lighting**

Type **Industrial lighting**

Contents of this product **1x 150W high bay 5000K**

Technical datasheet **Digitally available  
on our webshop**



*View instructions and  
technical data also on  
our website*

# TRONIX



## Before first use

Before getting started with this product, it is advisable to check the order completeness and any damage. If this is the case, please contact Tronix Lighting.

## Description

Using this high bay, you are assured of a large amount of high-quality light. This means that this high bay is not only suitable for the warehouse, storage or workshop, but also for spaces like shopping malls or exhibition halls.

### Features

- Standard equipped with a 90° lens;
- Optionally equipped with a 120° reflector (see related products);
- Very high luminous flux efficiency 190 Lm/W;
- Due to high luminous flux (19,000 lumens) ideal for warehouses or other high spaces.

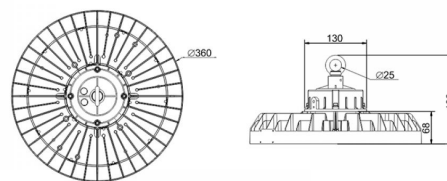

## Installation

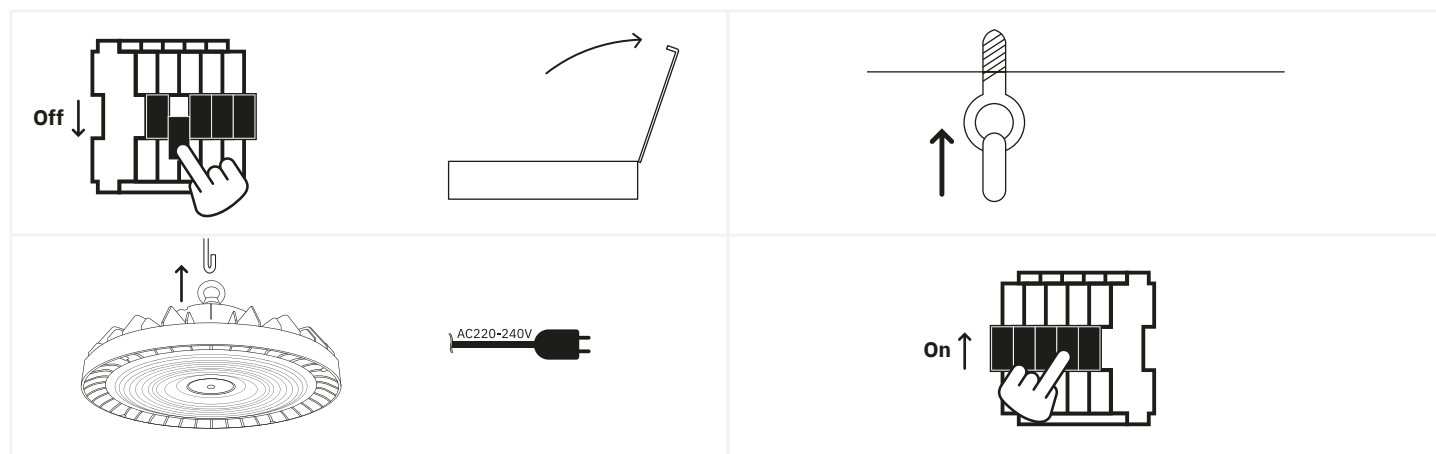

1. Turn off the power and remove the product and associated parts from the packaging...;
2. Attach the hook or other hanging element to the ceiling;
3. Hang the high bay, attach the additional accessories (optional) and then connect the necessary wiring;
4. Check the complete installation. Should it be in order, the mains power can be reactivated.



## Safety

Safety is a top priority at Tronix Lighting. Therefore, we heartily recommend that you follow the following steps closely:

- Keep this manual carefully for future reference;
- Choose a qualified electrician while installing, maintaining or inspecting this product;
- Never look directly into a light source to avoid possible damage to the eye;
- Always ensure that the relevant power group is on non-active when the product is connected;
- Use only recommended combinations (LED drivers, controllers or dimmers) to avoid injury or damage to the product.

## Technical problems and repair

Should a product not work properly after installation, or if the product exhibits problems over time, it is advisable to check the following elements:

- Check the wiring and installation of your product;
- Check for the presence of interfering elements such as dust, water or other electronics;
- If possible, try disconnecting the product and testing it in another location to rule out a problem at the location;
- Should you be dealing with a WIFI-based product, check and reset your router's settings.

Should the product still not work after testing, it is recommended to send it in for inspection and/or repair. To do so, please contact Tronix Lighting using nearby details and proof of purchase (packing slip).



CARE



SHARE



CONNECT

### Supplier:

Tronix Lighting B.V

Vluchtoord 41  
5406 XP Uden, Netherlands

+31 (0)413 330 380  
sales@tronixlighting.com

## Terms and symbols (as relevant to product)



The **CE mark** indicates that this product complies with EU regulations on safety, health and environmental protection;



The **WEEE symbol** stands for "Waste Electrical and Electronic Equipment Regulation," a directive on the collection, recycling and recovery of electronic waste;



The **Class I symbol** indicates that this product is protected by means of the additional ground cable. This cable is identified by the yellow/green jacket and is attached to this product.

- This product has an **IP65 rating**. This means the housing is touch-safe, fully protected from dust and spray-proof (12.5 L/min) regardless of angle.