

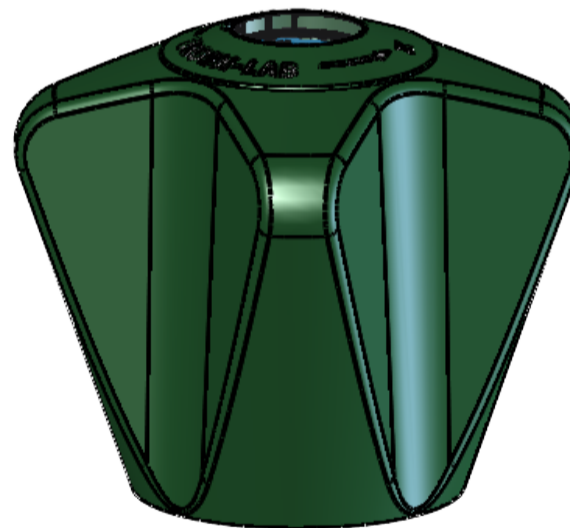

Metal handle



MEDIA CODE XX FOR 2.0 TECHNICAL GASES

Media	Media description	Media code XX
CA	Compressed air	21
N <sub>2</sub>	Nitrogen	23
CO <sub>2</sub>	Carbon dioxide	24
Ar	Argon	25
He	Helium	26
RA	Regulated air	42

MEDIA CODE XX FOR VACUUM

Media	Media description	Media code XX
V	Vacuum Low	28
VF	Vacuum Fine	29
VH	Vacuum High	30

MEDIA CODE XX FOR BURNING GAS FITTINGS

Media	Media description	Media code XX
G	Natural gas	09
LPG	Propane/butane (liquefied gasses)	11
C <sub>4</sub> H <sub>10</sub>	Butane	13
C <sub>3</sub> H <sub>8</sub>	Propane	15
C <sub>2</sub> H <sub>2</sub>	Acetylene	17
H <sub>2</sub>	Hydrogen	19
CH <sub>4</sub>	Methane	45

MEDIA CODE XX FOR SPECIAL WATER ONE MEDIA FITTING

Media	Media description	Media code XX
WDI	Distilled water	03
WDC	Demineralized water	36

MEDIA CODE XX FOR WATER ONE MEDIA FITTING \*Model shown for WPC

Media	Media description	Media code XX
WPC	Water potable cold	01
WPH	Water potable hot	02
WCF	Water coolant, feed	05
WCR	Water coolant, return	06
WNC	Water non-potable, cold	07
WNH	Water non-potable, hot	08
WRC	River water cold	33

Description: , , Spare part, metal handle, ,									
						Media: Water			
						Comments: EN13792:2002			
						Drawing type: Spare part drawing			Weight: 0,159 Kg
Rev.		Pos.	Date	TM No.	Design by	Drawn by:	Change:		
						Designed by: SJE		Released on TM No. 8479	Date: 17/02/21
<b>BROEN-LAB</b>						Format: A3	Drawing No.: 1916014910XX		
This drawing is our property and cannot be given to a third party, copied or otherwise used without our permission. BROEN-LAB A/S.									