

ONETRACK RECESSED BOX FIX-POINT BLACK 9000/BRU-B 9200754



Features

- OneTrack accessory, fix-point for surface mounting, Polycarbonate body, steel springs Max load: 50N. Fixing thickness: 1-30mm. Black.

Product Overview

Product name	ONETRACK RECESSED BOX FIX-POINT BLACK 9000/BRU-B
Technology	Accessory
General application	Museums & Galleries, Office
ETIM Class	EC000101
Housing colour	Black
Warranty	5 years

ONETRACK RECESSED BOX FIX-POINT BLACK 9000/BRU-B 9200754

Technical drawings

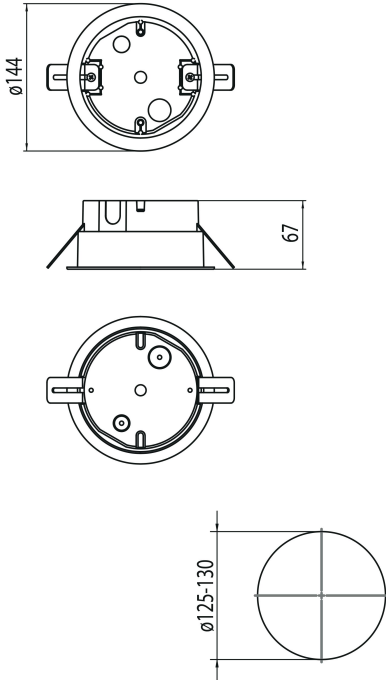

Data table

GENERAL DATA

Product name	ONETRACK RECESSED BOX FIX-POINT BLACK 9000/BRU-B
Technology	Accessory
General application	Museums & Galleries, Office
ETIM Class	EC000101
Warranty	5 years

ELECTRICAL DATA

Control gear required	No
-----------------------	----

ONETRACK RECESSED BOX FIX-POINT BLACK 9000/BRU-B 9200754

PHYSICAL DATA

Housing colour	Black
Nominal Product Height (mm)	67
Nominal Product Diameter (mm)	144
Weight (kg)	0.14

PACKAGING

Single packaging type	Mix(80% carton, 20% plastic)
Packaging single length / height (cm)	13.0
Packaging single width (cm)	6.0
Packaging single depth (cm)	13.0
Units per outer package	1
Packaging outer length / height (cm)	13.0
Packaging outer width (cm)	6.0
Packaging outer depth (cm)	13.0

SAFETY DATA

Special purpose lamp	No
Dry applications use only	No
Suitable for household illumination	No