

## 3PKG-200420BP: Double Backplate elbow female short model Gas 20x1/2"x20

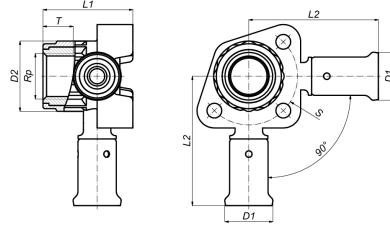

### Commercial information

The PVDF press fittings for gas differ in only one significant technical aspect compared to press fittings for sanitary and heating applications. The fittings have a special O-ring that is made from the HNBR and is resistant to gas. To make this difference visible, every pressure sleeve has a yellow band. The fittings for gas should never be used for sanitary applications or heating applications. Similarly, fittings for gas should only be used in combination with the yellow HENCO multilayer pipe for gas. The Henco system for gas is only permitted in countries where a gas quality mark has been granted.

PVDF offers the user a unique combination of properties:

- Highly resistant to pressure and temperature
- Excellent mechanical strength
- Extreme flexibility: bending up to 10° is possible
- Highly resistant to chemicals and corrosion
- Embedding is possible without extra protection

#### Certificates

GASTEC, TSU, ROST

#### Applications

Natural gas

#### Solutions

Building installations, Industry, Oil & gas, Utility, Shipbuilding

## Technical characteristics

Housing material	Polyvinylidene fluoride (PVDF)	Outer pipe diameter connection	20 Millimetre
Surface protection	Untreated	Outer pipe diameter connection 1	20 Millimetre
Shape	Right-angled	Length of connection 1	60 Millimetre
System-specific	Yes	Working length connection 1	33 Millimetre
Nominal diameter connection 2	1/2 inch (15)	Length of connection 2	44 Millimetre
Connection	Press sleeve	Working length connection 2	30 Millimetre
Thread size tap connection	1/2 inch	Length from wall plate	40 Millimetre
KIWA certified	No	Length of connection 3	60 Millimetre
Gastec QA	Yes	Working length connection 3	33 Millimetre
Contour code	TH	Medium temperature (continuous)	-20 60 Degrees celsius
DVGW quality mark for gas	No	Max. operating pressure at 20 °C	16 Bar
DVGW quality mark for water	No	Zeta value	25.9
KIWA certified	No		
Gastec QA mark	Yes		
KOMO certified	No		
Type approval according to BBR/EKS	No		

## Related products