

L	29.8	41.0	51.9	62.5	73.3	83.9
C	10.0	20.0	30.0	40.0	50.0	60.0
D	14.1	16.9	17.7	17.2	18.7	20.7
E	8.1	10.1	11.7	11.2	12.7	14.7
F	7.6	7.9	7.3	8.0	7.5	7.4

Onderdelen - Parts - Teile

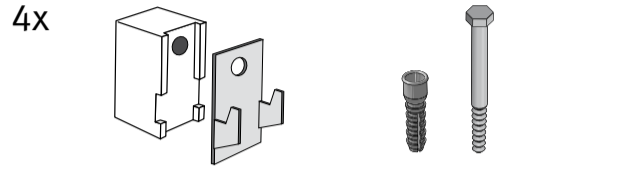

Optie - option

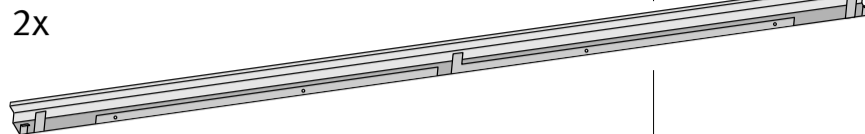
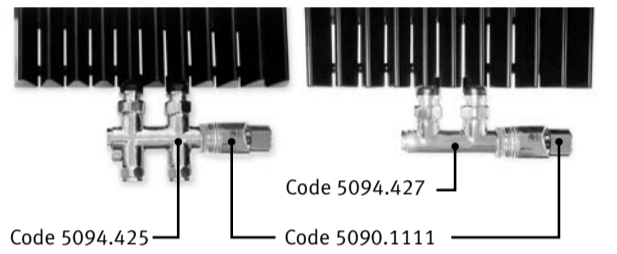
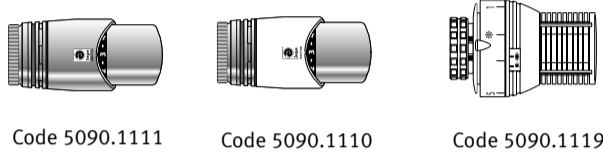

Standaard
Standard

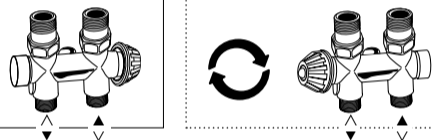

Klemkoppelingen voor ventielen: zie Jaga prijslijst.
Raccords bicônes pour vanes: voir liste des prix Jaga.
Klemringverschraubungen für Ventile: siehe Jaga Preisliste.
Sleeve couplings for valves: see Jaga price list.

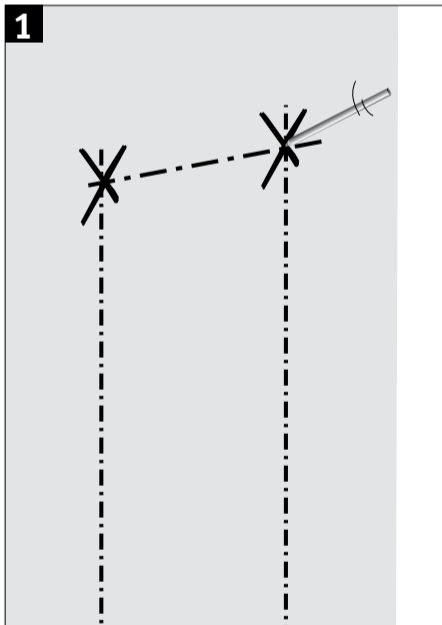

Plaatsing CV-leidingen aansluiting 1-8
Positionnement des tuyaux de CC
raccordement 1-8
Positionierung ZH-Leitungen Anschluß 1-8
Placement of CH tubes connection 1-8

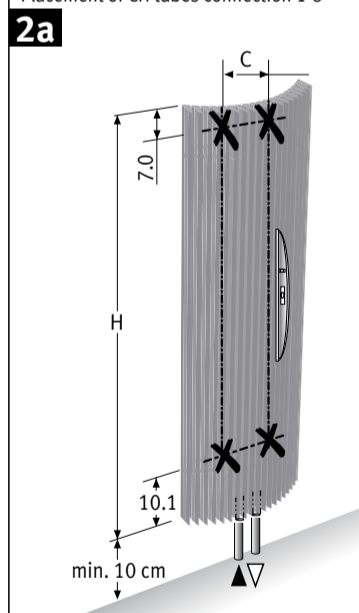

Plaatsing CV-leidingen aansluiting 4-5
Positionnement des tuyaux de CC
raccordement 4-5
Positionierung ZH-Leitungen Anschluß 4-5
placement of CH-tubes connection 4-5

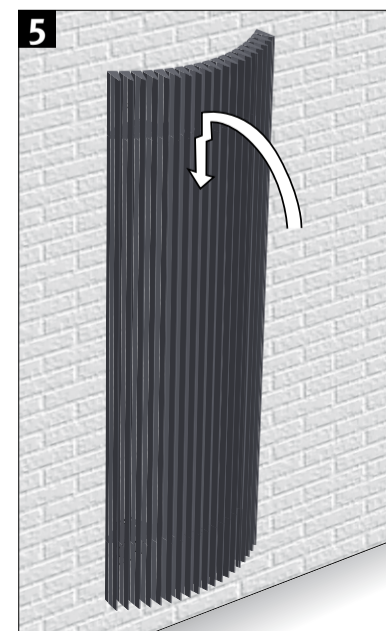
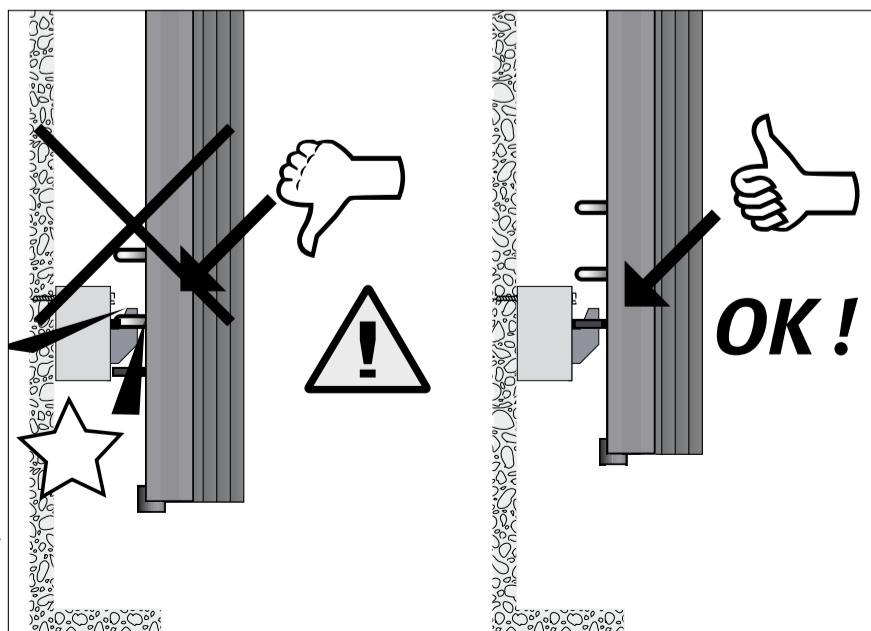
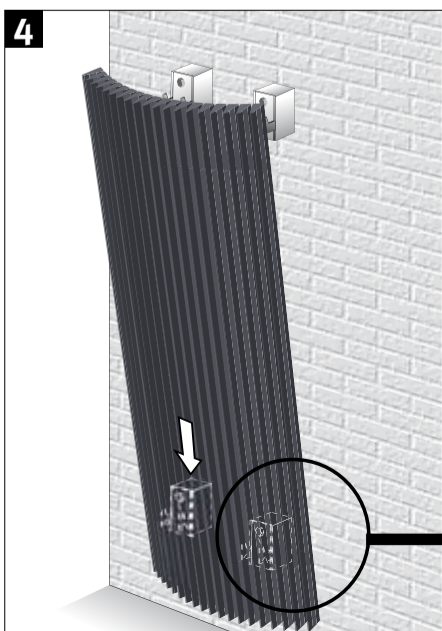
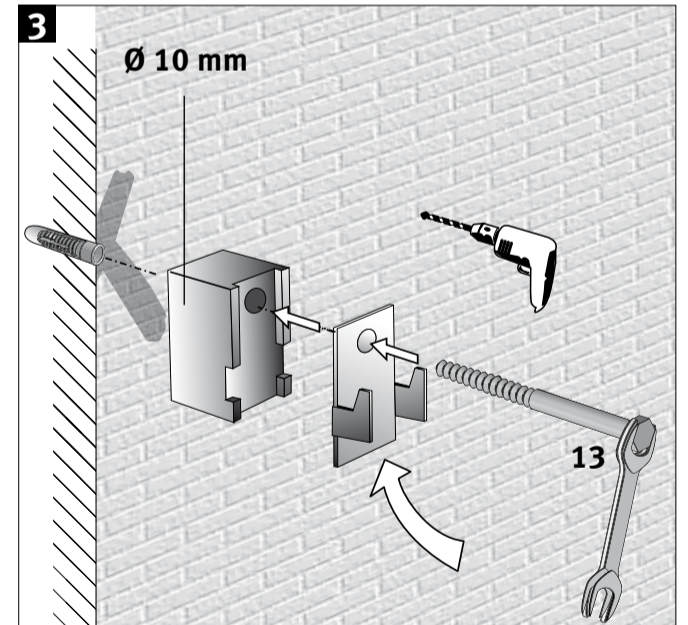
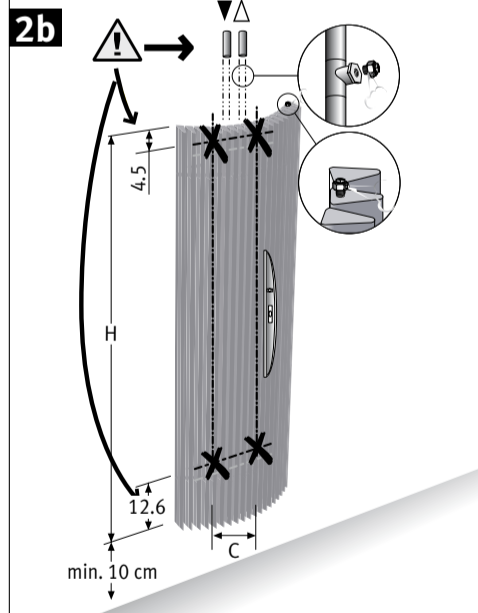

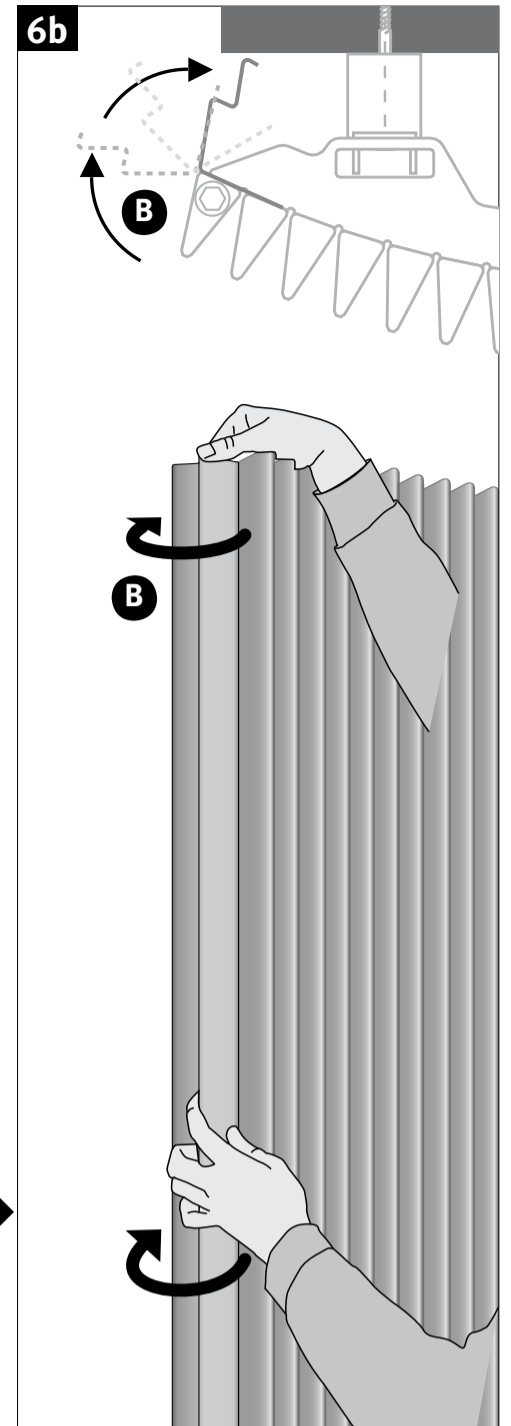
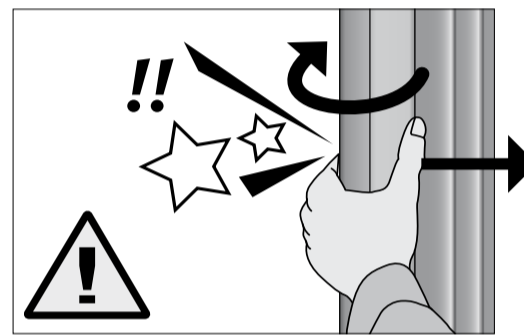
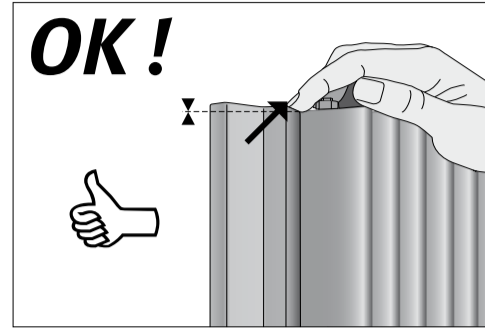
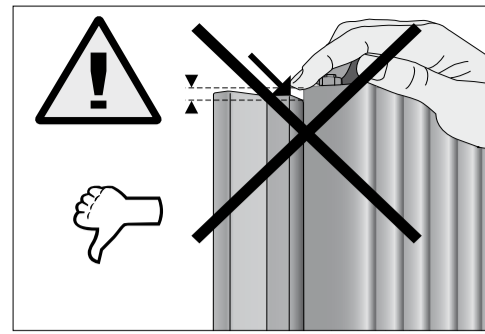
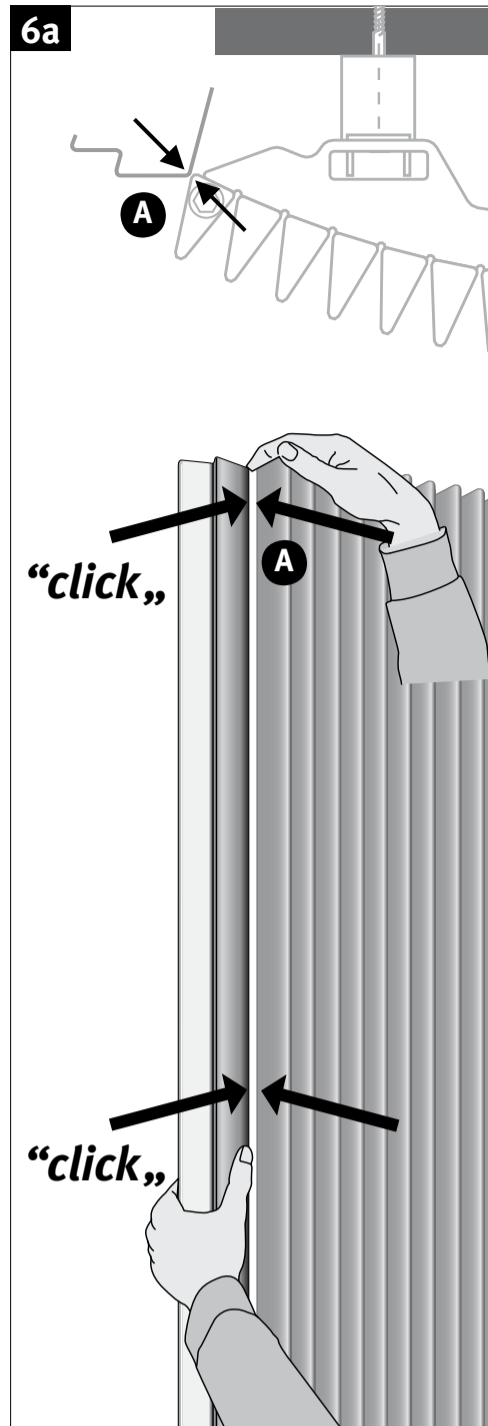
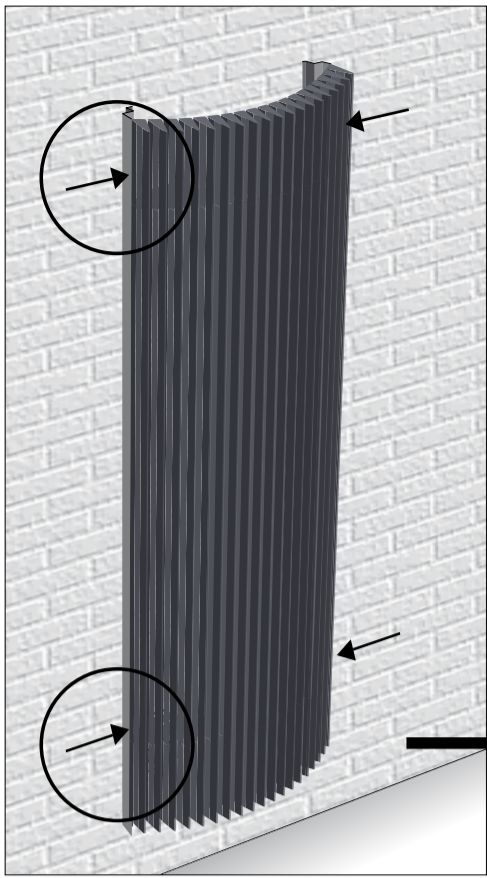

Aansluiting / Connection / Anschluß

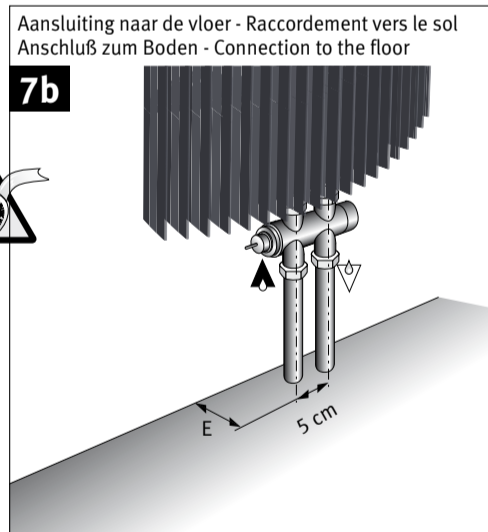
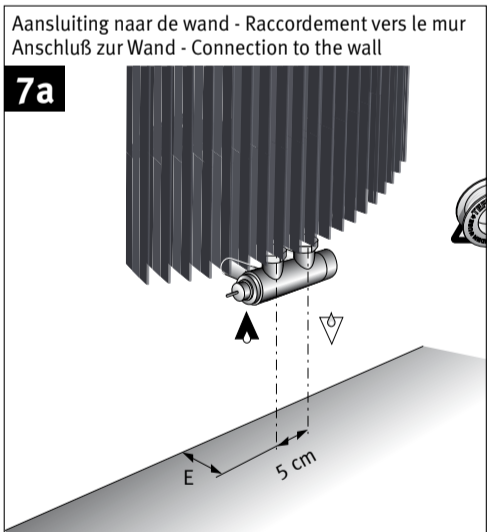

Eenpijp-tweepijpaansluiting / Raccordement monotube-bitube Einrohr-Zweirohranschluß / One pipe-two pipe connection

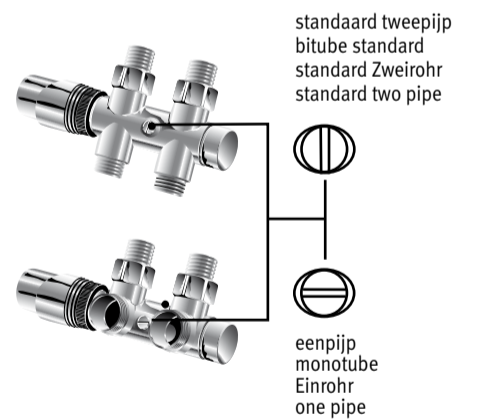
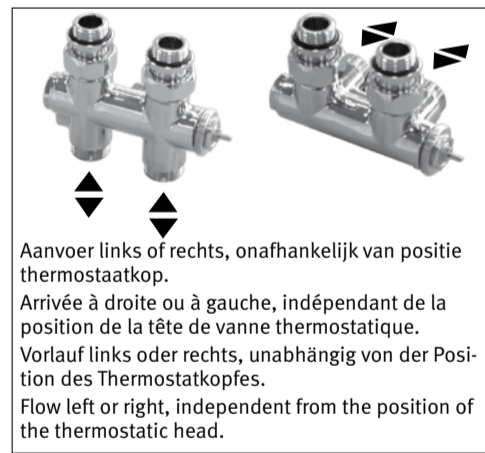

L	E
30.0	8.1
41.0	10.1
52.0	11.7
63.0	11.2
74.0	12.7
85.0	14.7