

**Safe Operation**

1. Check the rating label for voltage and frequency before connecting this luminaire to the electrical supply.
2. Ensure that the mains supply is switched off when working on this luminaire, whether installing or carrying out any other servicing.
3. Do not mount luminaire on or close to readily flammable materials.
4. Where use in more onerous situations is required, e.g. In part-completed buildings before "drying-out" is completed, or areas where ambient temperatures are outside the normal temperature range, then consult our Sales Office.
5. Ensure the fixing is adequate for the luminaire weight.

**Servicing and Disposal**

1. At commissioning and handing over of installation ensure that a copy of these instructions is presented to the authority responsible for the operation and maintenance of the luminaries.
2. Servicing, e.g. cleaning, must only be carried out after the electricity supply has been switched off. It must not be assumed that luminaries with lamps not lit are switched off-always check before servicing.
3. Cleaning should be carried out at regular intervals to ensure that dirt does not accumulate to an extent that will impair the thermal safety or optical performance of the luminaire. Regular cleaning will also ensure that the optical performance of the luminaries is maintained.
4. Avoid touching the LED strip. To clean - Blow surface with either dry air or nitrogen gas.
5. At the end of life the luminaire is classed as WEEE under directive 2012/19/EU and should be disposed of in accordance with local legislation.

Note: The LEDs are non-replaceable.

**Luminaire Cleaning**

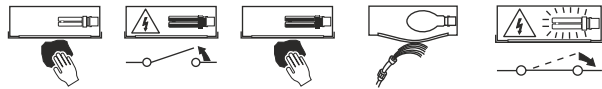

**End of Life and Components Disposal**

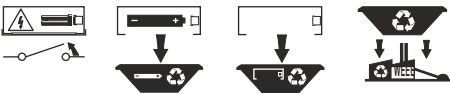

# i-P65 Plus CG-S



- Product luminaires comply with EN60598 and are suitable for use in normal interior and exterior conditions.
- For Polycarbonate variants - This luminaire has an ambient temperature range of -20°C to 30°C.
- For Aluminium variants - This luminaire has an ambient temperature range of -20°C to 40°C

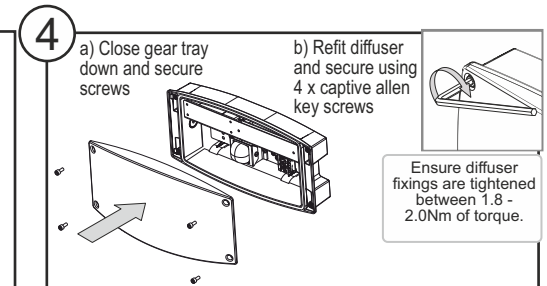
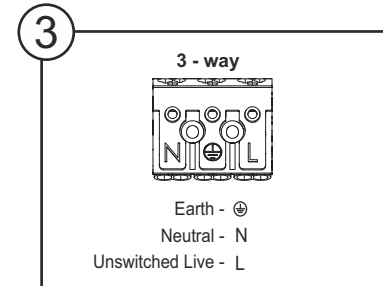
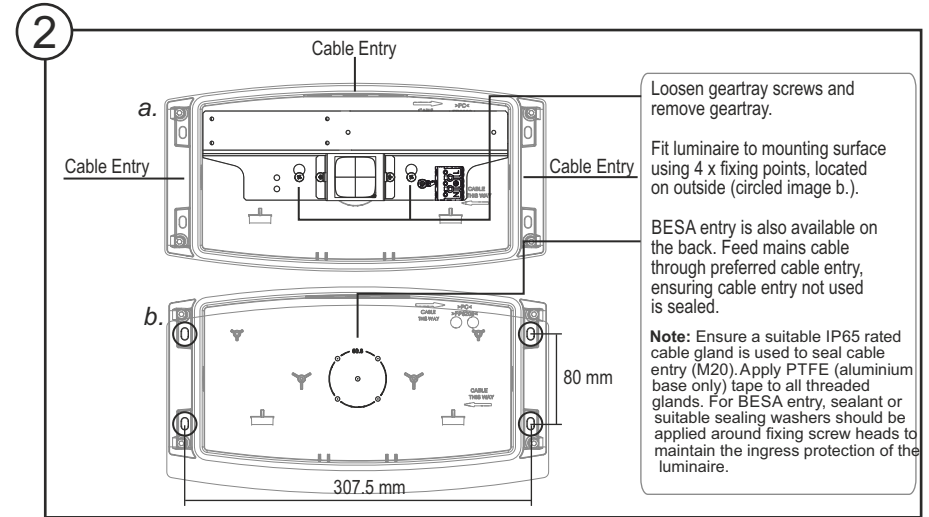
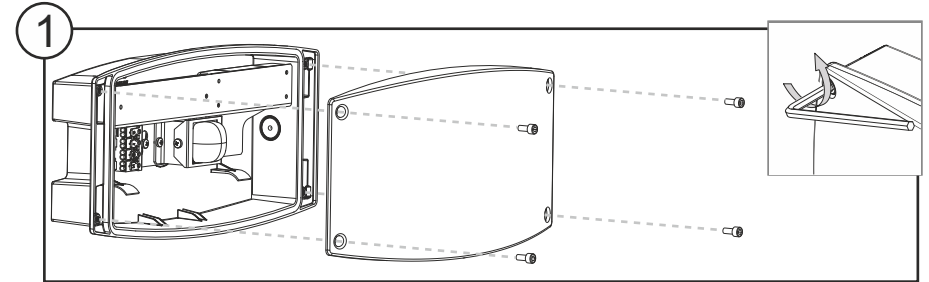

**Safety Notes**

- The luminaire shall only be used for its intended purpose and in an indamaged and perfect condition!
- Only genuine Eaton spare parts may be used for replacement and repair!
- When working on the emergency luminaire first the system must be blocked, battery operation must be interrupted and mains must be cut off. Enclosed indication label on the emergency luminaire:

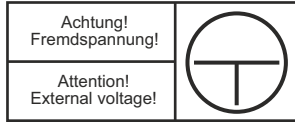

- Prior to its initial operation, the luminaire will have to be checked in accordance with the instructions as per section 'Installation'!
- Carry out the marking of the emergency luminaire: Assign the circuit, the luminaire no. and ID no. and enter them.
- The manual log book shall be performed in compliance with the national regulations. It is not applicable by automatical log book!
- Any foreign matter shall be removed from the luminaire prior to its initial operation!
- Observe the national safety rules and regulations for prevention of accidents as well as the safety instructions included in these operating instructions marked with ⚠!

**Conformity to standards**

Conforms to: EN 60 598-1, EN 60 598-2-22 and DIN EN 1838.  
 Developed, manufactured and tested in accordance with DIN EN ISO 9001.

**Technical Data**

Input voltage: 220-240 V AC, 50/60 Hz, 176 V - 275 V DC  
 Enclosure material: Die-cast Aluminium/Polycarbonate Housing/  
 Clear polycarbonate  
 White  
 Colour of enclosure:  
 Luminous flux  $\phi_{l_e}/\phi_{l_{Nenn}}$  at the  
 end of rated operating time: 100%  
 Supply terminals: 3 x 2 x 2.5 mm<sup>2</sup>  
 Insulation class: I  
 Degree of protection acc. to EN 60529: IP 65  
 Lamp: COB LED 6.4 W  
 Admissible amb. temperature: -20 °C...+40 °C (Aluminium housing)  
 -20 °C...+30 °C (Polycarbonate housing)  
 Current consumption battery operation: 40 mA  
 Connection power mains operation: 15.6 VA/9.3 W  
 (apparent power/active power)

	Die-cast Housing Weight (Kg)	Plastic Housing Weight (Kg)	Lumen Output
High Bay Version (H)	1.85 kg	1.75 kg	590 lm
Mid Bay Version (L)	1.85 kg	1.75 kg	770 lm

**Brief description / Scope of application**

Luminaire for emergency lighting acc. EN 60598-2-22 and EN 1838, designed for operation exclusively with EATON CEAG central battery systems in accordance with DIN EN 50172, DIN VDE 0100-560 and DIN VDE V 0108-100-1 with CG-S technology.

**Installation / Operation**



For the mounting and operation of electrical apparatus, the respective national safety regulations as well as the general rules of engineering will have to be observed!

**Mounting**

Find the detailed description on the front page.

**Addressing / Single luminaire monitoring**

Special LED-Converter with integrated monitoring module for individual monitoring of luminaires (monitoring of the supply and automatic detection of faulty supply of the LED-module) with 20 addresses. Before fitting the luminaire, the individual luminaires will have to be performed. To do so, the desired address (1-20) is set on the address switch by means of a suitable screw driver (arrowhead to no.). If the luminaire should not be monitored, the code 2/2 has to be selected.

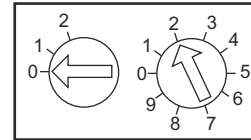

Adressschalter 1 address switch 1	Adressschalter 2 address switch 2	Leuchtenadresse Luminaire address
0	0	Initialisierung / Initiation
2	2	Überwachung aus / Monitoring off
0	1	1
0	2	2
.....	.....	.....
1	1	11
.....	.....	.....
2	0	

**Initialisation**

If the supply module needs to be replaced, it must first be re-initialised. To achieve this, switch the address switch to 0|0. The initialisation will begin 5 s after establishing voltage. This will be displayed via a flashing sequence (interval 1 sec. 100%; 1 sec. 50%). After the flashing sequence has stopped set the required address or for the unmonitored modules set to the address 2 | 2.

**Inspection/Maintenance/Repair**

Observe the valid regulations for the inspection, maintenance and repair of electrical equipment!  
 In case of returns you needs a RMA - number from us. For further information see [www.ceag.de](http://www.ceag.de)!

**Disposal / Recycling**

When disposing of faulty equipment, observe the valid regulations for recycling and disposal. Plastic parts are marked with the appropriate symbols.