

## Walraven Swivel Beam Clamp Model P

(K2030)

for clamping on beam flange

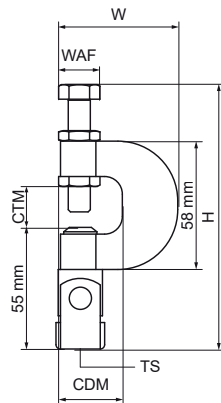

### Features & benefits

- multidirectional clamp
- for suspension on pitched flanges without welding or drilling
- up to flange thickness 17 mm
- according to VdS-regulations an additional safety strap should be used when supporting pipes above DN65
- articulation to 45° sideways, 90° forwards
- safety strap is obliged with VdS applications 1 and 4
- material: steel
- zinc plated
- with VdS-approval - certificate number G 4020003



Product Number	Maximum Clamping Thickness	Maximum Clamping Depth	Total Height	Total Width	Total Depth	Thread Size	Width Across Flats	Maximum Allowed Load Faz	Approvals
<i>Reference Letter</i>	CTM	CDM	H	W	DtT	TS	WAF	Fa,z	
<i>Unit description</i>	mm	mm	mm	mm	mm		mm	N	
6078010	17	27	168	53	28	M10	17	2,500	FM, VdS