

VVSK-T26M26: T-piece for supply for manifold Ø26

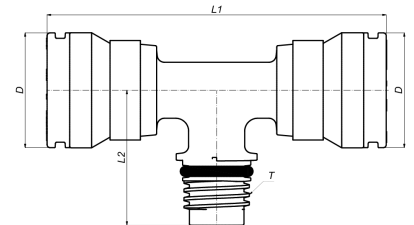

Commercial information

Synthetic T-piece for manifold, male, with 2x SK connectors

Basic unit dimensions

Height	40 mm
Length	117 mm
Width	67 mm
Net weight	0.101 kg

Certificates

QB (CSTBat), ETA, KIWA, ÖVGW Wasser, SINTEF, SITAC, KOMO, STF, GOST-R, TSU, EMI

Applications

Potable water, Heating, Cooling, Sanitary

Solutions

Building installations, Industry, Utility

Technical characteristics

Material connection 1	Polyvinylidene fluoride (PVDF)	Angle	90 Degrees
Surface protection connection 1	Untreated	Outer pipe diameter connection 1	26 Millimetre
Surface treatment connection 1	Untreated	Outer pipe diameter connection 3	26 Millimetre
Material connection 2	Polyvinylidene fluoride (PVDF)	Wrench width	0 Millimetre
Surface protection connection 2	Untreated	Max. operating pressure at 20 °C	10 Bar
Surface treatment connection 2	Untreated	Wrench width union nut	0 Millimetre
Material connection 3	Polyvinylidene fluoride (PVDF)	Medium temperature (continuous)	-10 70 Degrees celsius
Surface treatment connection 3	Untreated	Standard Dimension Ratio (SDR)	0
Model	T-piece		
Swept entry type (with inner radius)	✗		
Reducing	✗		
System specific	✓		
Connection 1	Insert (push-fitting)		
Contour code connection 1	Other		
Connection 2	Internal thread cylindrical BSPP-G (ISO 228-1)		
Contour code connection 2	Other		
Connection 3	Insert (push-fitting)		
Contour code connection 3	Other		
Flange standard	Other		
Material sealing	Ethylene-propylene diene monomer rubber (EPDM)		
Main colour fitting	White		
High tensile strength	✗		
Ring stiffness class	Other		
With sealing rings/gaskets	✓		
With drain valve	✗		
With de-aerator	✗		
With thermal insulation	✗		
With buffer stud	✗		
Capped	✗		
FM quality mark	✗		
LPCB quality mark	✗		
ULC quality mark	✗		
UL quality mark	✗		
DIN-CERTCO certificate	✗		
VdS quality mark	✗		
With approval for TÜV	✗		
DVGW quality mark for gas	✗		
DVGW quality mark for water	✓		
KIWA certified	✓		
Gastec QA mark	✗		
KOMO certified	✓		
Type approval according to BBR/EKS	✗		