

Product data sheet Spirotech

Product name

SpiroCombi MB3 -2" -Magnet -Uni

Product properties

A brass (microbubble) deaerator and dirt separator with a magnet and a 22 mm - 2" universal connection

- Combined separation system - removes circulating air and microbubbles effectively
- Very small particles, from 5 μm (= 0.005 mm), are separated and removed
- Including a magnet for extra protection and high efficient removal of magnetite
- Dirt can be discharged while the system is in operation
- No shut-off valves or bypass required
- Applicable with 50/50 Ethylene Glycol / Water (Volume)
- Improve cost control and energy efficiency
- Constant low pressure drop
- Connection diameters from 22 mm to 2" (G2)
- Exceptional guarantee

Article number

UC200WJ

Product image



Product dimensions

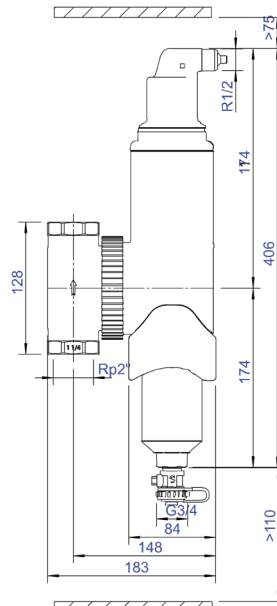

Product data sheet Spirotech

ETIM product data

| | |
|-------------------------------------------|---------------------|
| Housing material | Brass |
| With drain valve | Yes |
| Housing material quality | Other |
| Backwash filter | No |
| Medium temperature (continuous) | 0 - 110 °C |
| Max. operating pressure | 10 bar |
| KVS value [m ³ /h] at ΔP 1 bar | 30.2 |
| Variable flow direction | Yes |
| With insulation | No |
| Separator type | Air/dirt |
| Connection | Compression ring |
| Model | Horizontal/vertical |
| Nominal diameter | 2 inch (50) |
| Max. glycol mixture | 50 % |
| Suitable for heating | Yes |
| Suitable for cooling | Yes |
| Construction length | 128 mm |

| | |
|------------------------------------|---------------------------|
| Article compression class | PN 10 |
| Surface protection | Untreated |
| Suitable for open system | No |
| Suitable for closed system | Yes |
| Suitable for solar | No |
| With dismountable filter | No |
| Filter volume | 1.61 l |
| Magnet operating principle | Yes |
| With automatic de-aerator | Yes |
| Cleaning possible during operation | Yes |
| With couplers | Yes |
| Inlet/outlet offset distance | 0 mm |
| Material of connection | Brass |
| Material quality connection | Other |
| Flow-through capacity | 0 - 7.5 m ³ /h |
| Magnet location | External |

Disclaimer

This product sheet has been compiled with the greatest possible care. Nevertheless, it may contain errors or omissions. For the most current and correct information we refer you to our website

