

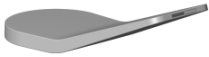





Handle Lever 49 x 30 x 110 mm - Matte Black

SPARE PARTS

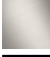
90 20 84 020 00

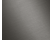

	Matte Black	90 20 84 020 00-33
	Chrome	90 20 84 020 00-00
	Brushed Platinum	90 20 84 020 00-06
	Dark Chrome	90 20 84 020 00-19
	Brushed Light Gold (PVD)	90 20 84 020 00-27
	Brushed Chrome	90 20 84 020 00-93
	Brushed Dark Platinum	90 20 84 020 00-99



Handle Lever 49 x 30 x 110 mm - Matte Black

SPARE PARTS

90 20 84 020 00



Handle Lever 49 x 30 x 110 mm - Matte Black

SPARE PARTS

90 20 84 020 00

90 20 84 020 00

Parts for other finishes can be found here: [Chrome](#)

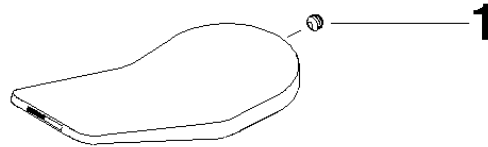

Spare parts list

No.	Item Number	Name	Quantity used	Delivery time
1	90 31 11 030 00 90	Mounting Threaded pin with hexagon socket with cup point M5 x 5 mm -	1.00	14