

SpaceLogic Sensors

SLXPMS Replacement PM Module



Product Description

The SLXPMS Replacement PM (Particulate Matter) Module is designed to provide a smooth field replacement experience. The module is compatible with all Schneider Electric SLA and SLP PM sensors for quick and easy replacement. No need to install an entirely new PM sensing device, just insert a new module into the existing unit and resume operation.

The replacement module is based on the laser-scatter measurement principle. This technology, combined with high-quality and long-lasting components, enables precise measurement by the module from its first operation throughout the lifetime of the device.

The module provides highly precise measurement for different particulate sizes, including PM1, PM2.5, PM4 and PM10.

At 41 x 41 x 12 mm³, the small size of this module also contributes to an easy replacement experience in the field.

Available Products

Model Number	Description
SLXPMS	Replaceable Module, PM

Safety Information

Important Information

Read these instructions carefully and look at the equipment to become familiar with the device before trying to install, operate, service or maintain it. The following special message may appear throughout this bulletin or on the equipment to warn of potential hazards or to call attention to information that clarifies or simplifies a procedure.

NOTICE

NOTICE is used to address practices not related to physical injury.

⚠ WARNING

WARNING indicates a hazardous situation which, if not avoided **could result in death or serious injury**.

Please Note

Electrical equipment should be installed, operated, serviced and maintained only by qualified personnel. No responsibility is assumed by Schneider Electric for any consequences arising out of the use of this material.

A qualified person is one who has the skills and knowledge related to the construction, installation and operation of electrical equipment and has received safety training to recognize and avoid the hazards involved.

Safety Precautions

⚠ WARNING



HAZARD OF ELECTRIC SHOCK, EXPLOSION OR ARC FLASH

- Apply appropriate personal protective equipment (PPE) and follow safe electrical work practices. See NFPA 70E or CSA Z462.
- This equipment must only be installed and serviced by qualified electrical personnel.
- Turn off all power supplying this equipment before working on or inside equipment.
- Always use a properly rated voltage sensing device to confirm power is off.
- Replace all devices, doors and covers before turning on power to this equipment.

Failure to follow these instructions can result in death, serious injury or equipment damage.

This product is intended for use in HVAC and building environmental control applications.

It is not intended for direct medical monitoring of patients.

Read and understand these instructions before installing this product.

The installer is responsible for all applicable codes.

If this product is used in a manner not specified by the manufacturer, the protection provided by the product may be impaired. No responsibility is assumed by the manufacturer for any consequences arising out of the use of this material.

USA: +1 888-444-1311
 Europe: +46 10 478 2000
 Asia: +65 6484 7877
www.schneider-electric.com

Life Is On

Schneider
Electric

Installation

NOTICE

SHORT CIRCUIT

- Disconnect power to the unit before making modifications.
- Failure to follow these instructions can result in equipment damage.**

1. Disconnect power to the unit.
2. Remove the SLA or SLP device faceplate.
3. Remove the PM module from the bracket by releasing the latch while lifting the corner of the module. Before the module releases from the bracket, make sure to hold the bracket in place to avoid disconnecting the adapter board from the main PCBA. Disconnect the harness from the adapter board.

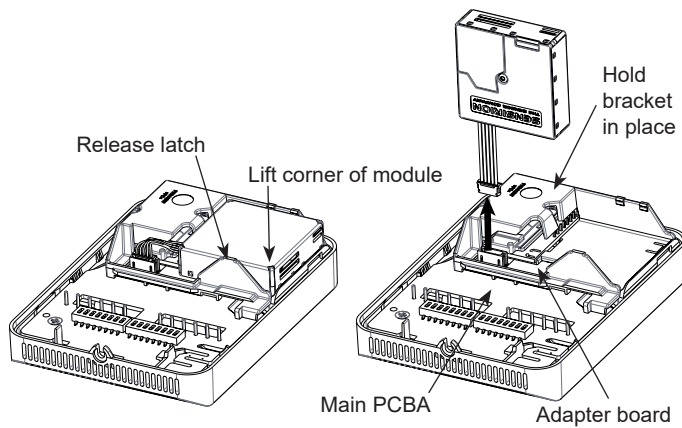

4. Disconnect the harness from the PM module.

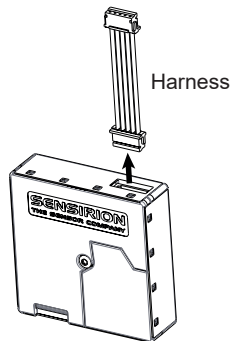

5. Connect the harness to the new module and ensure that the connectors are aligned. Use the guide to ensure the harness is plugged in the correct way.

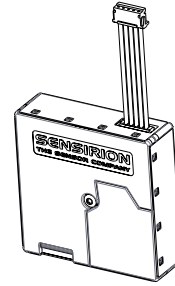

6. Connect the harness to the adapter board using the guide. Tuck the harness under the bracket. Then slide and snap the PM module into the bracket.

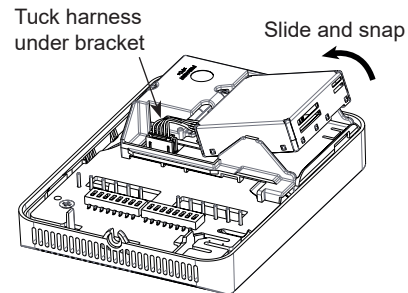

7. Make sure the adapter board is still connected to the main PCBA. Press down on the PM module to ensure connection.

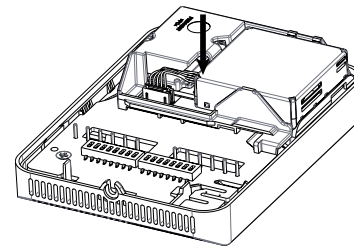

8. Replace the faceplate. Note that the unit is equipped with a CO2 sensor. The CO2 button bracket may require some minor adjustment if it is preventing the user from closing the unit. The bracket should be properly placed before trying to replace the faceplate.

Reconnect power.

Installation (cont.)

9. During boot-up, check the LED located on the left side of the unit:
 - a. If the LED only blinks once, the new module is connected correctly.
 - b. If the LED blinks 5 times, disconnect power, remove faceplate and check the connection between the adapter board and the PCBA (Step 6); then complete Steps 7 and 8 again.

