

BH-22C BRASS SWING CHECK VALVE



The Shurjoint Model BH-22C swing check valve is designed for grooved inlet and outlet connections, featuring a brass body with spring-loaded clapper with rubber seat rated 250 psi (17 bar) working water pressure. The valve body, end piece and clapper are made of brass castings per ASTM A-584 copper alloy C85700. For installation Shurjoint's copper system, use Model C307 transition coupling.

For pressure rating, listing, and approval information, refer to data sheet or visit SHURJOINT website www.shurjoint.com for details or contact your SHURJOINT representatives.

material specification

- **Body & End Piece:**
Brass casting to ASTM B-587-87 Copper Alloy UNS C85700.
- **Clapper:**
Bronze casting to ASTM B-587-87 Copper Alloy UNS C85700.
- **Clapper encapsulation:**
EPDM.
- **Clapper pin / Nut / Washer:**
Brass ASTM B16 C36000.
- **Spring:**
Stainless steel Type 304.
- **Plug:**
Brass ASTM B16 C36000.

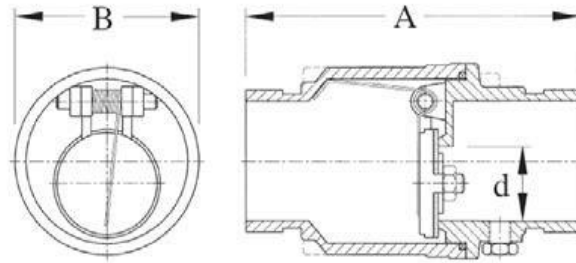

Model BH-22C Bronze Swing Check Valve

Nominal Size	Pipe O.D.	Max. Working Pressure (CWP)*	Dimensions			Weight
			A	B	d	
in	in	PSI	in	in	in	lbs
mm	mm	Bar	mm	mm	mm	kg
2	2.375	250	5.70	3.25	1.38	3.5
50	60.3	17	145	83	35	1.6
2½	2.875	250	6.50	4.21	1.88	6.8
65	73.0	17	165	107	48	3.1
3	3.500	250	7.64	4.88	2.44	9.9
80	88.9	17	194	124	62	4.5
4	4.500	250	7.95	5.59	3.31	11.9
100	114.3	17	202	142	84	5.4

* Working pressure is based on connection with roll- or cut-grooved standard wall carbon steel pipe.

General note

- Maximum Working Pressure (CWP) listed is the maximum cold water pressure for general piping services tested to ASTM F1476 and or AWWA C606 methods. Figures listed are based on roll- or cut-grooved standard wall carbon steel pipe. For other pipe schedules or pipe materials, contact Shurjoint for additional information.
- Max. End Load is calculated based on the maximum working pressure (CWP).
- Listed and or Approved Pressures are pressure ratings for fire protection systems, tested and approved by various approval bodies. Please always refer to the latest approval data posted on the Shurjoint website.
- Field Joint Test: For one time only, the system may be tested hydrostatically at 1½ times the maximum working pressure listed (AWWA C606 5.2.3).
- Warning: Piping systems must always be depressurized and drained before attempting disassembly and or removal of any components.
- The 10 Year Limited Warranty applies to manufacturing defects only and does not cover severe service/temperature applications or wear parts.
- Shurjoint reserves the right to change specifications, designs and or standard without notice and without incurring any obligations.