

Sounder-Strobe-Combination AXL05

Loud signalling device with 32 different signals and a 5-Joule strobe light

- ▶ AC and DC versions
- ▶ High volume up to 110 dB(A)
- ▶ Low current consumption
- ▶ Choice of 32 different signal tones
- ▶ Strobe light 5 Joule
- ▶ Robust and reliable

Application

The combination consists of a loud, compact signalling device with good directivity and a 5-Joule strobe light. The optical and acoustic signals can be controlled separately from each other. The IP 65 housing qualifies the device for use both indoors and outdoors.

Design

The housing consists of Polycarbonate (self-extinguishing according to UL 94VO). The sounders are equipped with 32 different tones and are therefore suitable for universal use.

The signal tone is selected with a five-position DIP switch. All versions are designed for a two-stage alarm.

Stage control in the DC version is effected with a three-wire connection or by reversing polarity externally.

The AC version needs a three-wire cable for the two-stage alarm. The strobe light is controlled via a separate connection terminal.

Signalling device with good directivity and a strobe light

for use indoors and outdoors.



AXL05

DC Input - second stage with third wire -
Line integrity: monitor via reverse polarity

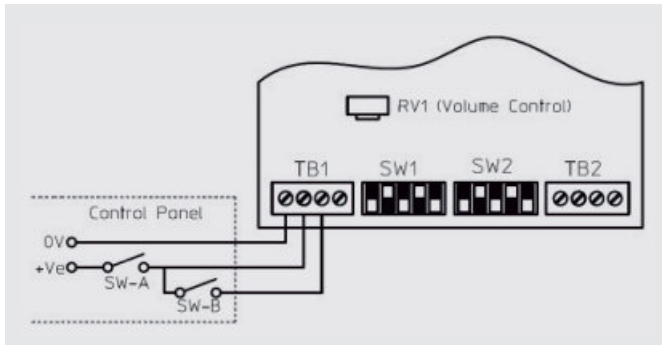

DC Input - second stage by supply reversal -
Line integrity: monitor via threshold (applied voltage ≤ 1 V)

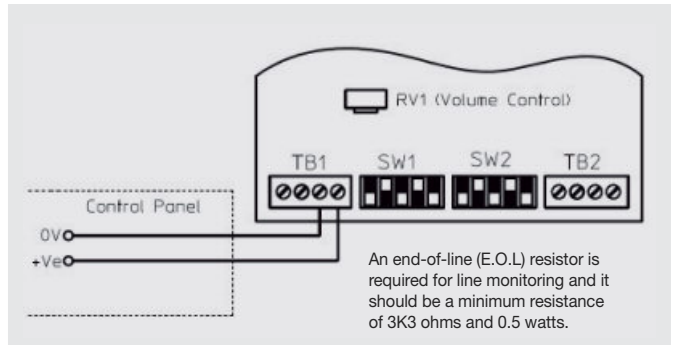

AC Input

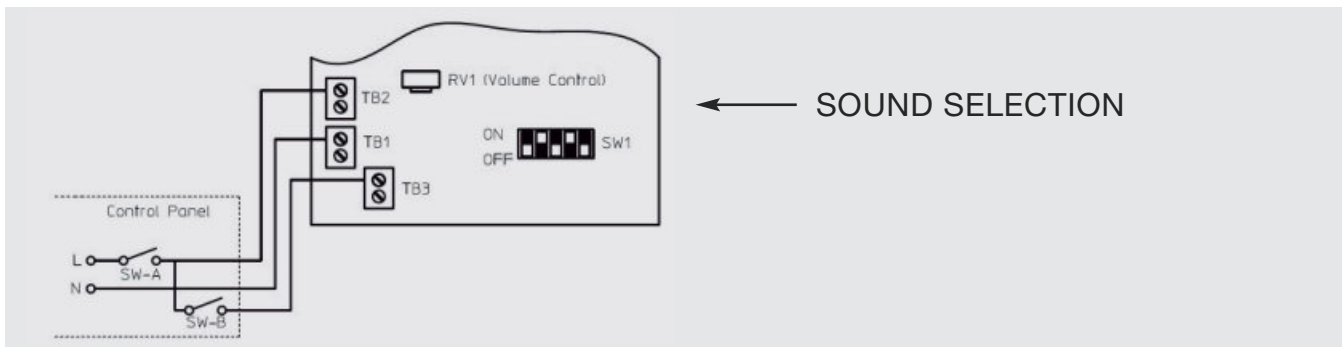

System connection

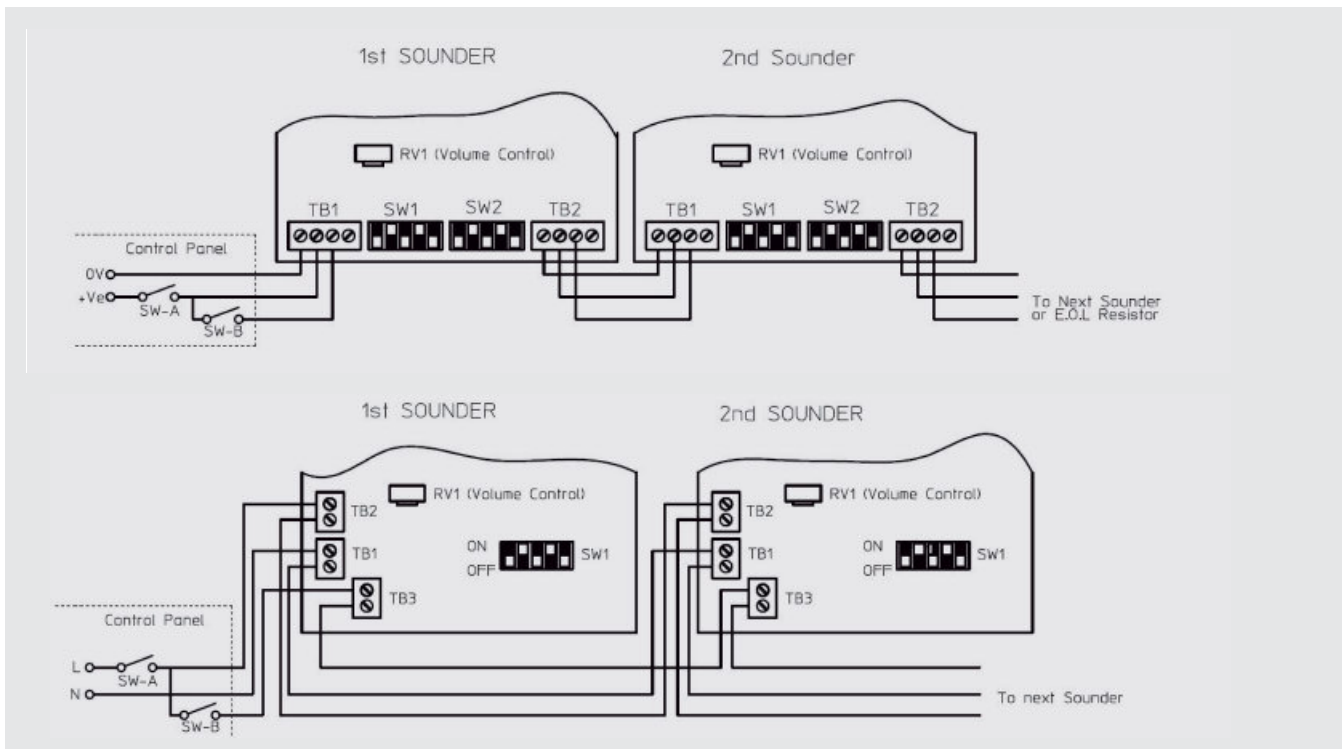

Wiring details for AXL units

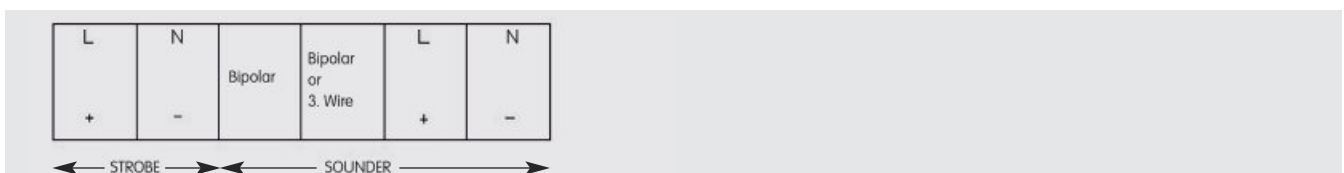

Technical specifications

Housing	Polycarbonate
Colour	Red, similar to RAL 2002
Cap	Polycarbonate
Protection degree	IP 65 (IEC 60529)
Cable gland	M20
Volume	approx. 110 dB(A) (Regarding volume specifications, please see the chapter "Technical Informations".)
Flash energy	5 Joule
Signals	32 different signal tones, see tone diagrams
Temperature range	-25 °C to +55 °C
Weight	approx. 1.0 kg

Dimens.	
A	169
B	153
C	134
D	128
E	9.5
F	Ø 8
G	57.5
H	88

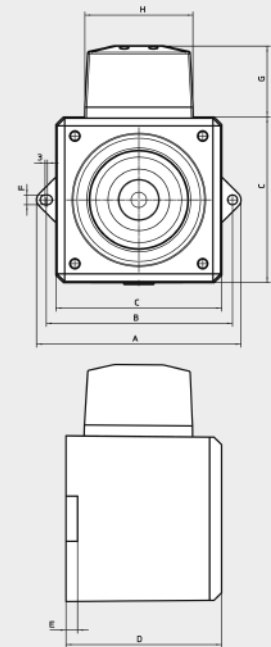

First and Second Sound	Frequency /Hz	Rept. rate	Switch 1 2 3 4 5	Special Application
1 Alternate two-tone	800 - 1000	0.5	1 1 1 1 1	Fire Alarms
2 Alternate two-tone	2500 - 3100	0.5	0 1 1 1 1	Security Alarms
3 Alternate fast two-tone	800 - 1000	0.25	1 0 1 1 1	Increased urgency
4 Alternate fast two-tone	2500 - 3100	0.25	0 0 1 1 1	Security deterrent
5 Alternate two-tone	440 - 554	0.4/0.1	1 1 0 1 1	AFNOR, France
6 Alternate two-tone	430 - 470	1.0	0 1 0 1 1	
7 Alternate v. fast two-tone	800 - 1000	0.13	1 0 0 1 1	
8 Alternate v. fast two-tone	2500 - 3200	0.07	0 0 0 1 1	
9 Alternate two-tone	440 - 554	2.0	1 1 1 0 1	Turn-out, Sweden
10 Continuous tone	700	-	0 1 1 0 1	All-clear, Sweden
11 Continuous tone	1000	-	1 0 1 0 1	
12 Continuous tone	1000	-	0 0 1 0 1	
13 Continuous tone	2300	-	1 1 0 0 1	
14 Continuous tone	440	-	0 1 0 0 1	
15 Interrupted tone	1000	2.0	1 0 0 0 1	
16 Interrupted tone	420	1.25	0 0 0 0 1	AS2220, Australia
17 Interrupted tone	1000	0.5	1 1 1 1 0	
18 Interrupted tone	2500	0.25	0 1 1 1 0	
19 Interrupted tone	2500	0.5	1 0 1 1 0	
20 Interrupted tone	700	6/12	0 0 1 1 0	Pre-vital mess, Sweden
21 Interrupted tone	1000	1.0	1 1 0 1 0	
22 Interrupted tone	700	4.0	0 1 0 1 0	Air-raid, Sweden
23 Interrupted tone	700	0.25	1 0 0 1 0	Local warning, Sweden
24 Interrupted tone	720	0.7/0.3	0 0 0 1 0	Industrial alarm, Germany
25 Int. fast rising volume	1400	0.25	1 1 1 0 0	
26 Fast siren	250 - 1200	0.085	0 1 1 0 0	
27 Rising constant, fall	1000	10/40/10	1 0 1 0 0	Industrial alarm, Germany
28 ISO 8201 Evacuation	800 - 1000	as std	0 0 1 0 0	Int. evacuation alarm
29 Fast whoop	500 - 1000	0.15	1 1 0 0 0	
30 Slow whoop	500 - 1200	4.5	0 1 0 0 0	Evacuation, The Netherlands
31 Reverse sweep	1200 - 500	1	1 0 0 0 0	Evacuation, Germany
32 Siren	500 - 1200	3.0	0 0 0 0 0	

Switch settings: ON = 1 und OFF = 0

PFEER Signals acc. UKOOA:

Alarm	Signal 15 Interrupted tone 1000 Hz
PAPA	Signal 31 Reverse Sweep 1200-500 Hz
Toxic gas	Signal 11 Continuous tone 1000 Hz

* The full article number is made up by appending the colour code for the coloured cap to the article numbers given below.

transp.	01
red	02
amber	03
green	04
blue	05

Order information

Type	Name	Rated voltage V	Operating voltage range V	Current consumption A	Volume dB(A)	Art. no.*
AXL05	Sounder-Strobe-Combination	230 VAC	198 – 242 V	0.15	approx. 110	225 107
AXL05	Sounder-Strobe-Combination	24 VDC	10 – 35 V	0.25	approx. 110	225 113

Subject to change without notice · Printout 10/11



FHF Funke + Huster Fernsig GmbH · P.O. Box 14 01 66 · D-45441 Mülheim an der Ruhr · Gewerbeallee 15-19 · D-45478 Mülheim an der Ruhr
Telephone +49-208-82 68-0 · Fax +49-208-82 68-286 · <http://www.fhf.de> · e-mail: info@fhf.de