

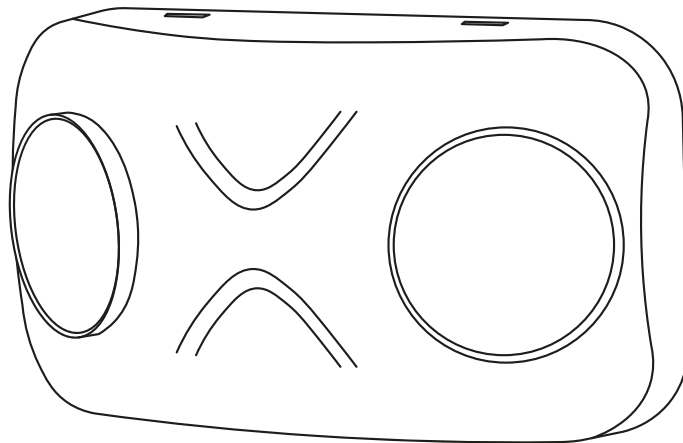

Read these instructions & save for future use

Emergency light | 8W | black | auto test



Article number **600-038**

Brand **Tronix Lighting**

Type **Emergency lighting**

Contents of this product **1x 8W emergency light**

Technical datasheet **Digitally available
on our webshop**



*View instructions and
technical data also on
our website*

TRONIX



Before first use

Before getting started with this product, it is advisable to check the order completeness and any damage. If this is the case, please contact Tronix Lighting.

Description

Emergency lighting is incredibly important for any building, commercial building or office. These fixtures are not only very functional, but are also designed with a focus on visibility and optimal operation.

This set also features an auto test. This automatically periodically tests the light source, both electronic and battery powered.

Features

- Periodic auto test according to international standard IEC62034;
- Four tests: Test after commissioning (battery charging, test and charge), short function (3 seconds focusing on condition), monthly test (3 minutes) and annual test (1 or 3 hours).

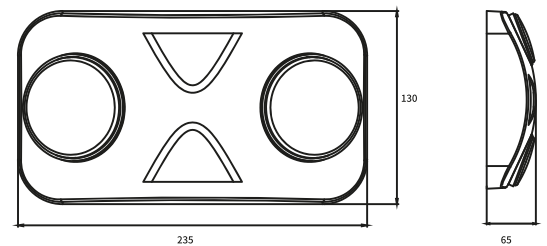

Installation

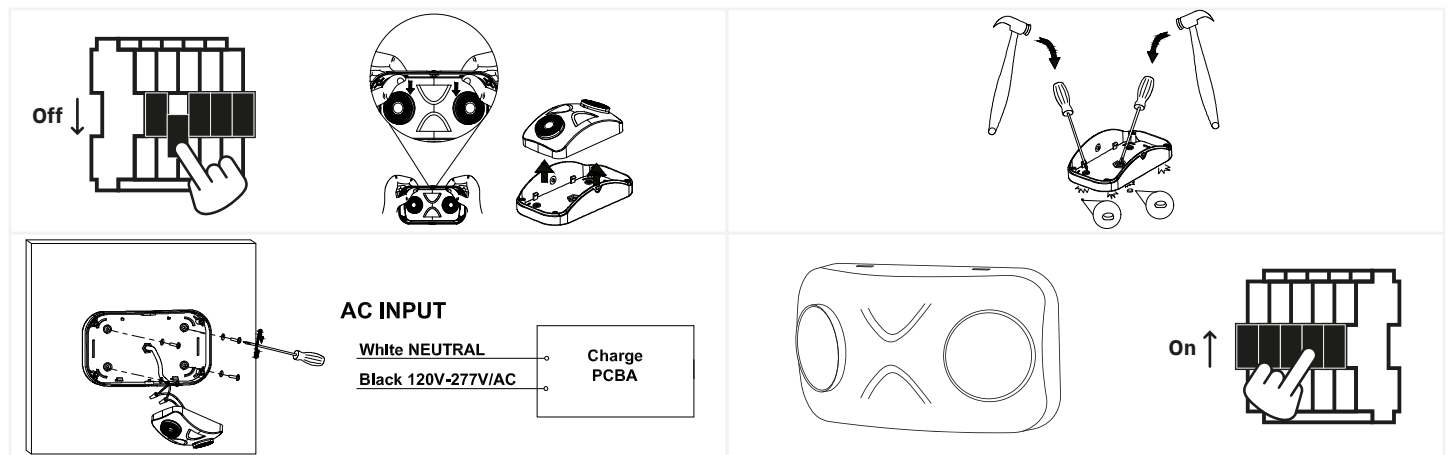

1. Turn off the power and remove the product and associated parts from the packaging. Push the fixture counter-clockwise from the test button to snap the lamp off;
2. Punch four holes in the base plate to attach it to the wall, where you drill holes based on the holes and then use the screws and rubber covers provided;
3. Pull the cable through the plate and reattach the lamp to the fixture (white on neutral). Reattach the lamp itself by pushing it back into the fixture;
4. Check the complete installation. If everything is in order, you can reactivate the power.



Safety

Safety is a top priority at Tronix Lighting. Therefore, we heartily recommend that you follow the following steps closely:

- Keep this manual carefully for future reference;
- Choose a qualified electrician while installing, maintaining or inspecting this product;
- Never look directly into a light source to avoid possible eye damage;
- Ensure that the respective power group is always on non-active when the product is connected;
- Use only recommended combinations (LED drivers, controllers or dimmers) to avoid injury or damage to the product;
- The light source of this light is not replaceable. Because of this, you must replace the entire fixture towards the end of its lifespan and it is not recommended to open it;
- Led indicator codes (4 second pause to pattern): 1 flash: Battery not connected. 2 flashes: Low voltage battery. 3 flashes: circuit board error. 4 flashes: AC/DC fault. 5 flashes: led lamp error.

Technical problems and repair

Should a product not work properly after installation, or if the product exhibits problems over time, it is advisable to check the following elements:

- Check the wiring and installation of your product;
- Check for the presence of interfering elements such as dust, water or other electronics;
- If possible, try disconnecting the product and testing it in another location to rule out a problem at the location;
- Should you be dealing with a WIFI-based product, check and reset your router's settings.

Should the product still not work after testing, it is recommended to send it in for inspection and/or repair. To do so, please contact Tronix Lighting using nearby details and proof of purchase (packing slip).



CARE



SHARE



CONNECT

Supplier:

Tronix Lighting B.V

Vluchtoord 41
5406 XP Uden, Netherlands

+31 (0)413 330 380
sales@tronixlighting.com

Terms and symbols (as relevant to product)



The **CE mark** indicates that this product complies with EU regulations on safety, health and environmental protection;



The **WEEE symbol** stands for "Waste Electrical and Electronic Equipment Regulation," a directive on the collection, recycling and recovery of electronic waste;



The **Class II symbol** indicates that this product is double insulated;

- The product is rated **IP20**. This means that the product is resistant to the penetration of solid objects >12.5 mm and is not resistant to water or moisture.