







TARA Single-lever mixer - Brushed Dark Platinum

TARA

33 815 888 Product version from 5/31/2010 to 10/27/2020



- 236mm projection
- pivotable spout 360°
- air-enriched flow
- height of mixer 400 mm
- height up to aerator 230 mm
- hole diameter 35 mm
- max. flow 7 l/min at 3 bar flow pressure
- lead-free
- WRAS
- This product can help a building meet the requirements of Green Building Rating Systems, e.g. LEED®, BREEAM®, DGNB

| | | |
|---|--------------------------------|---------------|
|  | Brushed Dark Platinum | 33 815 888-99 |
|  | Chrome | 33 815 888-00 |
|  | Brushed Platinum | 33 815 888-06 |
|  | Platinum | 33 815 888-08 |
|  | Durabronze (23kt Gold) | 33 815 888-09 |
|  | Dark Chrome | 33 815 888-19 |
|  | Brushed Durabronze (23kt Gold) | 33 815 888-28 |
|  | Matte Black | 33 815 888-33 |
|  | Brushed Dark Brass (PVD) | 33 815 888-39 |
|  | Brushed Bronze (PVD) | 33 815 888-42 |
|  | Brushed Dark Bronze (PVD) | 33 815 888-43 |
|  | Brushed Champagne (22kt Gold) | 33 815 888-46 |
|  | Champagne (22kt Gold) | 33 815 888-47 |
|  | Brushed Chrome | 33 815 888-93 |

Recommended miscellaneous

Dispenser with rosette - Brushed Dark Platinum 82 444 970-99



Recommended miscellaneous

Strainer waste with control handle - Brushed Dark Platinum 10 710 970-99



33 815 888 Product version from 5/31/2010 to 10/27/2020

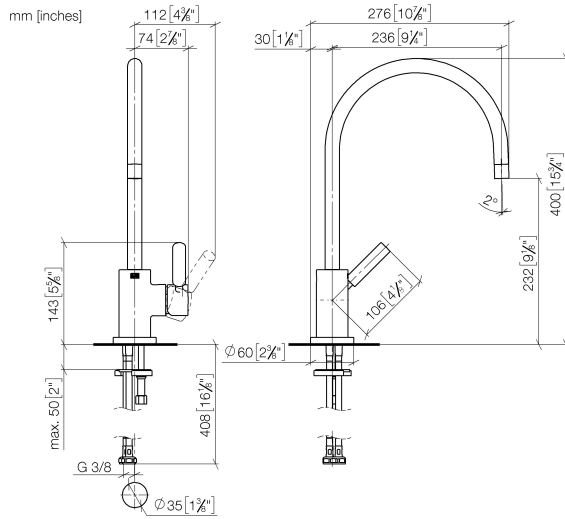

Flow rate chart

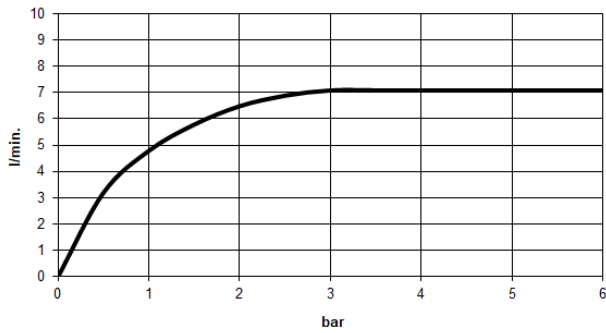

Codes & Standards

| | | | |
|---------------------------|--------------------------------|-----------------------------|------------|
| DIN 4109 | EN 817 | Executive Order no. 1007 | ISO 3822 |
| Scottish Water Byelaws | UK Water Supply Regulations | Ü-Zeichen | VA-Zeichen |



TARA Single-lever mixer - Brushed Dark Platinum

TARA

33 815 888 Product version from 5/31/2010 to 10/27/2020

Certificates and sustainability

WRAS_2311

GDV_0400

ETA_18

LGA_8

EPD-DOR-20230287
-IBA1-EN
Environmental.prod
uct-declarat

