

TRONIX

ASSEMBLY INSTRUCTIONS FOR CONNECTING THE ROPE LIGHT

Article: 485-090

WARNING!

Make sure the rope light is not connected to any power supply before starting assembly.

ASSEMBLY:

1. Only cut the rope light at the mark. Use a sharp cutting tool and ensure a smooth straight cut!
(Image 1).
2. Press the connector with the sharp, pointed side into the rope light, ensuring that the pins are inserted into the centre of the cores (image 2).
The cores are located off-centre in the rope light (image 3).
The connector must now be in line with the rope light!
You can make the rope light more malleable by heating it with a hair dryer.
3. Apply 3 cm of glue at the end of the rope light and slide the rope light into the connector socket (image 4).
Allow the glue to harden for about 15 minutes before proceeding.

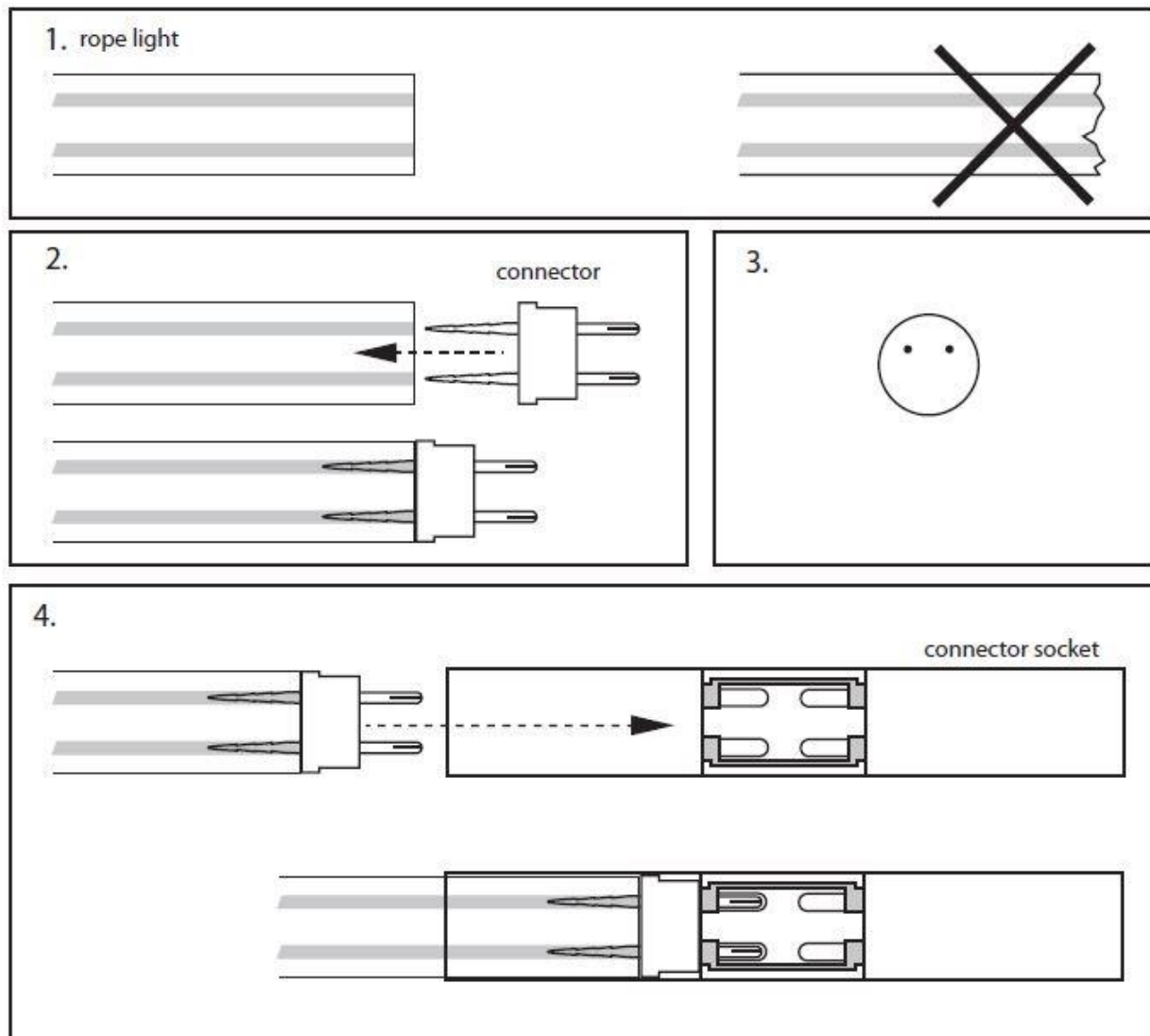

Imported by Tronix Lighting, Uden, The Netherlands

No part of this publication may be reproduced or published by means of photocopy, microfilm, any form of digital storage or in any other way without the prior written permission of the publisher.