

34P-2005: Bend 90° Press swivel adapter with flat sealing 20x3/4"

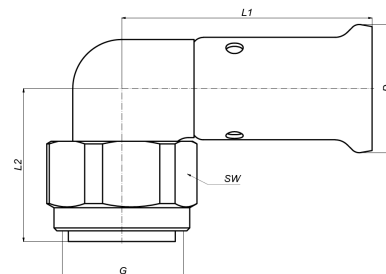

Commercial information

The body of the fitting is made from CW617N brass. These fittings offer great advantages with regard to corrosion and they are also also better for the environment.

- The fitting has a buffer ring that prevents direct galvanic contact between the aluminium of the pipe and the brass of the fitting.
- This excludes the possibility of electrolysis occurring.
- The fitting is equipped with O-rings made from EPDM and RVS pressure sleeves with 3 inspection windows.
- In order to prevent assembly errors, the dimensions and type of press profile which can be pressed are shown on the RVS sleeves

Basic unit dimensions

Height	33 mm
Length	66 mm
Width	52 mm
Net weight	0.118 kg

Certificates

ATG, DVGW Wasser, ETA, KIWA, ÖVGW Wasser, WRAS, KOMO, STF, ÖN EN 21003-2/-3, GOST-R, ITC, TSU, QB (CSTBat), AFNOR, ACS, PZH, DNV-GL, Sans 21003, Kontrol Biro, EMI

Applications

Potable water, Heating, Compressed air, Cooling, Sanitary

Solutions

Building installations, Industry, Utility, Shipbuilding

Technical characteristics

Material connection 1	Brass	Bend radius	20 Millimetre
Material quality connection 1	CuZn40Pb2 (CW617N)	Outer pipe diameter connection 1	20 Millimetre
Surface protection connection 1	Untreated	Length	66.3 Millimetre
Surface treatment connection 1	Untreated	Max. operating pressure at 20 °C	16 Bar
Material connection 2	Brass	Standard Dimension Ratio (SDR)	0
Material quality connection 2	CuZn40Pb2 (CW617N)		
Surface protection connection 2	Untreated		
Surface treatment connection 2	Untreated		
Shape	Bend		
Reducing	✗		
Eccentric	✗		
System specific	✓		
Connection 1	Press sleeve		
Contour code connection 1	TH		
Connection 2	Union nut		
Main colour fitting	Brass		
Material sealing	Ethylene-propylene diene monomer rubber (EPDM)		
With buffer stud	✓		
Self-sealing	✗		
Ring stiffness class	Other		
Capped	✗		
FM quality mark	✗		
LPCB quality mark	✗		
ULC quality mark	✗		
UL quality mark	✗		
VdS quality mark	✗		
KIWA certified	✓		
Gastec QA mark	✗		