

Cepex flush mounted receptacle

Part no. 4246



- screw terminals
- with labelling field
- with safety lock
- two keys
- cannot be dismantled when locked
- on request with identical locks
- with flush mounted installation box
- with identical lock: part no + index G

Technical specifications

Ampere	16 A
Poles	5 p
Voltage	400 V
Clock position	6 h
Hertz	50-60 Hz
Protection type	IP44
Shutter	false
Weight	307 g

Drawing

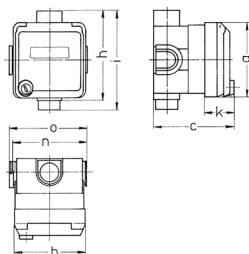

Drawing 1 MB 352	Amp. Poles	16			32		
		3	4	5	3	4	5
Dim. in mm	a	93	93	93	93	93	93
	b	90	90	90	90	90	90
	c	98	98	98	98	98	98
	h	111	111	111	111	111	111
	i	124	124	124	124	124	124
	k	36	36	36	36	36	36
	n	91	91	91	91	91	91
	o	95	95	95	95	95	95
Terminal for cond. cross		1.5	1.5	1.5	2.5	2.5	2.5
section (mm ²) min.-max.		-4	-4	-4	-6	-6	-6