

Walraven Britclips® FC M6 x 9

(J0525)

for flange

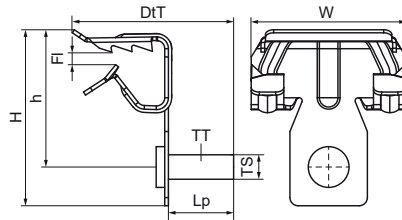

Features & benefits

- for a solid fixing to steel construction without the need for welding or drilling
- with stud bolt M6 x 9 mm for fixing of clamp, conduit junction box, etc.
- material: spring steel (type CS70)
- surface treatment: Delta-Tone 9000 (480 hours)

Product Number	For flange size	Height	Thread Size	Thread Type	Stud Length	Total Height	Total Width	Total Depth	Maximum Allowed Load Faz
<i>Reference Letter</i>	<i>fs</i>	<i>h</i>	<i>TS</i>	<i>TT</i>	<i>Lp</i>	<i>H</i>	<i>W</i>	<i>DtT</i>	<i>Fa,z</i>
<i>Unit description</i>	<i>mm</i>	<i>mm</i>			<i>mm</i>	<i>mm</i>	<i>mm</i>	<i>mm</i>	<i>N</i>
50520604	2 - 4	20	M6	Metric	9	27	28	24	450
50520609	4 - 8	21	M6	Metric	9	39	38	32	450
50520616	8 - 14	30	M6	Metric	9	41	38	32	450
50520620	14 - 20	32	M6	Metric	9	47	38	32	450
50520630	20 - 28		M6	Metric	9	56	38	32	450