

Walraven RapidStrut® Slide Nut with Plastic Tabs (BUP1000)

(H2435)

to connect construction parts to the rail

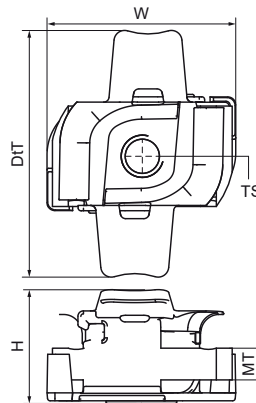

Features & benefits

- slide nut with plastic 'tabs'
- for all types of Walraven RapidStrut® Rail
- for tight fixing of accessories (e.g. connectors) on rail
- with plastic tabs which simplifies inserting and positioning
- material: slide nut made of steel 1.0332; tabs made of PP (polypropylene), green
- product is part of the Walraven Walraven UltraProtect® 1000 system
- suitable for in- and outdoor applications
- stands min. 1,000 hours salt spray test (max. 5% red rust) according to ISO 9227
- M10 & M12 tested for fire safety according to EN 1366-1.
- Tested values in combination with Walraven RapidStrut® Rail 41x41x2.5mm.



Product Number	For Rail Type	Thread Size	Material Thickness	Torque Moment For Installation	Maximum Allowed Load Fax	Maximum Allowed Load Faz	Total Height	Total Width	Total Depth
Reference Letter		TS	MT	T inst.	Fa,x	Fa,z	H	W	DtT
Unit description			mm	Nm	N	N	mm	mm	mm
651868006	41x21, 41x41, 41x51, 41x62, 41x82	M6	5.00	7	950	2,660	21.28	35.7	47.13
651868008	41x21, 41x41, 41x51, 41x62, 41x82	M8	6.00	25	2,200	4,500	21.28	35.7	47.13
651868010	41x21, 41x41, 41x51, 41x62, 41x82	M10	8.00	40	2,550	5,000	21.28	35.7	47.13
651868012	41x21, 41x41, 41x51, 41x62, 41x82	M12	9.00	50	2,950	5,000	21.28	35.7	47.13