

Panel mounted receptacle

Part no. 3334



- screw terminals
- uniform fixing hole spacing
- receptacles are designed for adding an auxiliary contact switch

Technical specifications

| | |
|-----------------------|-----------------|
| Ampere | 32 A |
| Poles | 5 p |
| Voltage | 400 V |
| Clock position | 6 h |
| Hertz | 50-60 Hz |
| Connection technology | Screw terminals |
| Contact | standard |
| Protection type | IP67 |
| Flange | 110x106 mm |
| Fixing hole | 90x90 mm |
| Inclination | 15 ° |
| Weight | 320 g |
| Certifications | VDE |

Drawing

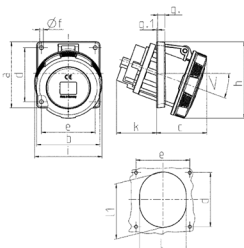

| Drawing | Amp. | 16 | 32 | 63 | 125 |
|--------------------------------------------------|-------|-----|-----|-----|-----|
| 1 MB 580/601 | Poles | 5 | 5 | 4 | 5 |
| Dim. in mm | a | 110 | 110 | 110 | 110 |
| | b | 106 | 106 | 106 | 114 |
| | c | 55 | 59 | 84 | 84 |
| | d | 90 | 90 | 90 | 90 |
| | e | 90 | 90 | 90 | 90 |
| | f | 5.2 | 5.2 | 6.5 | 6.5 |
| | g | 8 | 8 | 12 | 12 |
| | g.1 | 2 | 2 | 2 | 2 |
| | h | 110 | 115 | 128 | 128 |
| | i | 89 | 106 | 113 | 113 |
| | k | 28 | 46 | 64 | 67 |
| | l | 78 | 87 | 92 | 92 |
| | l1 | - | - | 98 | 98 |
| | < | 15° | 15° | 20° | 15° |
| Terminal for cond. cross section (mm²) min.-max. | | 1.5 | 2.5 | 6 | 6 |
| | | -4 | -10 | -20 | -20 |