

Panel mounted receptacle

Part no. 3022



- screw terminals
- highly heat resistant contact carrier
- nickel plated contacts
- uniform fixing hole spacing
- suitable for through wiring
- 20° inclination
- receptacles are designed for adding an auxiliary contact switch

Technical specifications

Ampere	16 A
Poles	7 p
Voltage	400 V
Clock position	6 h
Hertz	50-60 Hz
Connection technology	Screw terminals
Contact	nickel plated contacts
Protection type	IP44
Flange	85x85 mm
Fixing hole	70x70 mm
Inclination	20 °
Weight	222 g

Drawing

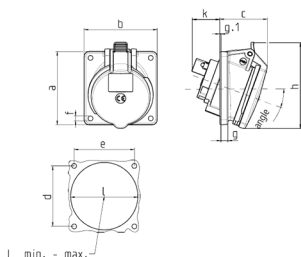

Drawing	Amp.	16	32
1 MB 453	Poles	7	7
Dim. in mm	a	85	85
	b	85	85
	c	57	67
	d	70	70
	e	70	70
	f	5.5	5.5
	g	8	8
	g.1	2	2
	h	101	110
	k	41	49
	l min.	70	78
	l max.	78	78
Terminal for cond. cross		1.5	2.5
section (mm ²) min.-max.		—4	—10