

# Product End of Life Instructions

## Harmony XB7 Selector Switch





## End of Life Instructions

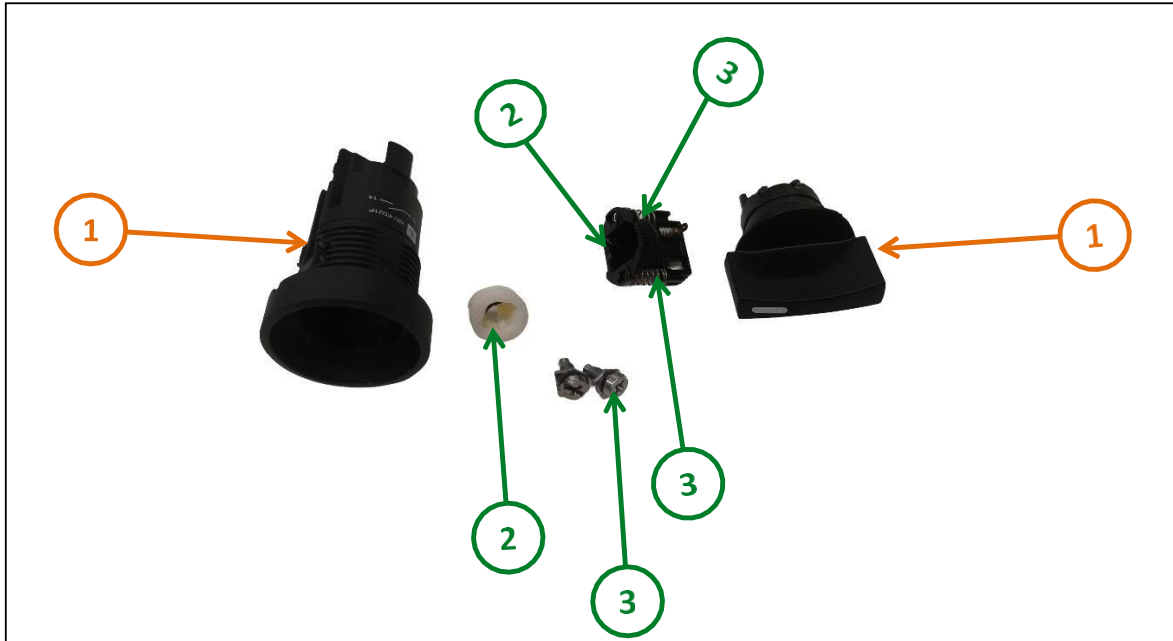

Recommendation	Number on drawing	Component / Material	Weight (in g)	Comment
To be depolluted	1	Top Cap, Bottom Cap, Handle	16.15	Plastic With FR
To be dismantled	2	Spring Adaptor, Fixing Nut	2.47	Plastic Without FR
To be dismantled	3	Bridge, Plate, Terminal, Screw, Spring	7.38	Metal Parts

## Product description

Manufacturer identification	Schneider Electric Industries SAS
Brand name	Schneider Electric
Product function	Selector switch can be rotated right, left, or in the center in order to open or close the electrical contacts.
Product reference	XB7ND33
Additional similar product references	XB7ND21 XB7ND25
Total representative product mass	26 g
Representative product dimensions	H67mm x L29mm x D22mm
Accessories	No accessories needed
Date of information release	10/2023

## Additional information

Legal information	This product family is in the scope of European Union directive 2012/19/EU on Waste Electrical and Electronic Equipment (WEEE). The product family must be disposed according to the legislation of the country. This document is intended for use by end of life recyclers or treatment facilities. It provides the basic information to assure an appropriate end of life treatment for the components and materials of the product.	
In case of special transportation: transportation method	No specific means of transportation are required.	
Recyclability potential	27%	Recyclability rate has been calculated based on REEECY'LAB tool developed by Ecosystem, for components/materials not covered by the tool, data from the "ECO'DEEE recyclability and recoverability calculation method" was taken. If no data was found a conservative assumption was used (0% recyclability).

Schneider Electric Industries SAS

Country Customer Care Center

<http://www.se.com/contact>

35, rue Joseph Monier

CS 30323

F- 92500 Rueil Malmaison Cedex

RCS Nanterre 954 503 439

Capital social 928 298 512 €

[www.se.com](http://www.se.com)

Published by Schneider Electric

ENVEOLI2312032\_V1

© 2023 - Schneider Electric – All rights reserved

10/2023