

# Product End of Life Instructions

## Modbus Glass door panel with number





## End of Life Instructions

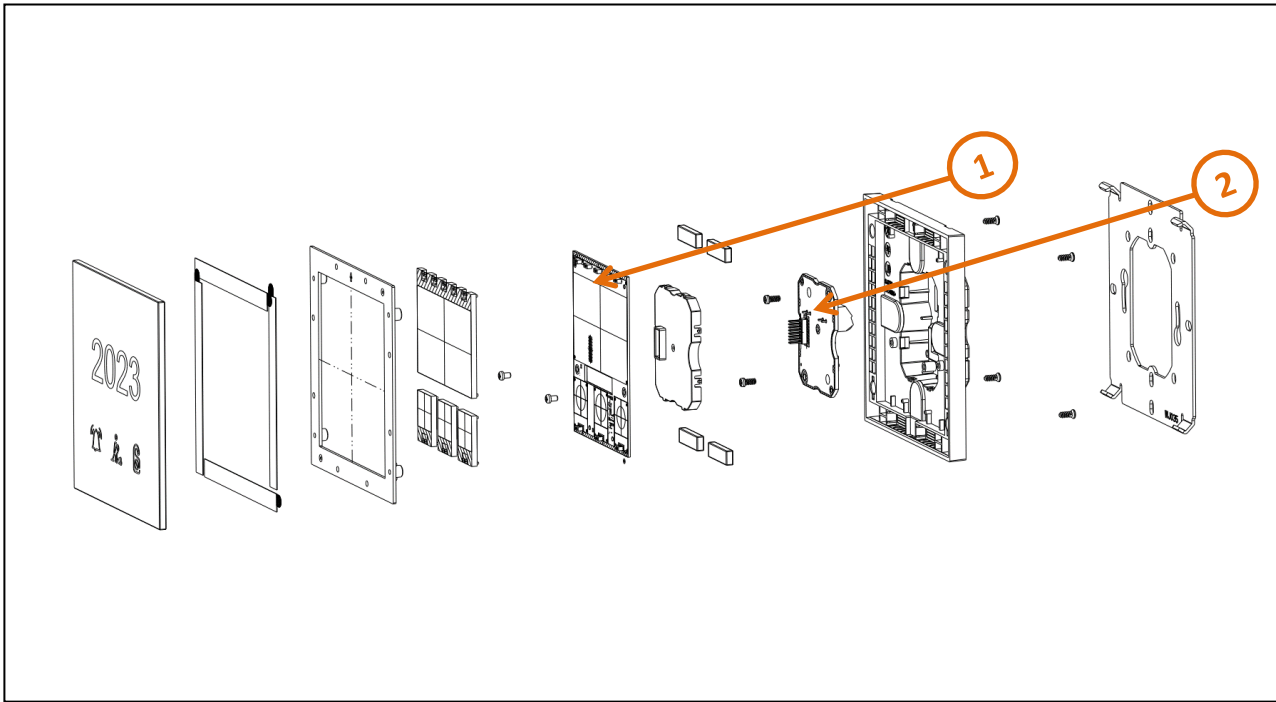

| Recommendation   | Number on drawing | Component / Material                                 | Weight (in g) | Comment                       |
|------------------|-------------------|------------------------------------------------------|---------------|-------------------------------|
| To be depolluted | 1                 | Electronic Board (Communication) > 10cm <sup>2</sup> | 13.01         | Including all soldering parts |
| To be depolluted | 2                 | Electronic Board (Communication) > 10cm <sup>2</sup> | 10.519        | Including all soldering parts |

## Product description

|                                   |                                                                                                                                                                     |
|-----------------------------------|---------------------------------------------------------------------------------------------------------------------------------------------------------------------|
| Manufacturer identification       | Schneider Electric Industries SAS                                                                                                                                   |
| Brand name                        | Schneider Electric                                                                                                                                                  |
| Product function                  | This product is a doorbell for hotel rooms. The bell will ring when pressing bell button in the door panel, except when DND is enabled that the bell will not ring. |
| Product reference                 | SLGM03DP                                                                                                                                                            |
| Total representative product mass | 210.26 g                                                                                                                                                            |
| Representative product dimensions | 95mm x 95mm x 25mm                                                                                                                                                  |
| Accessories                       | No                                                                                                                                                                  |
| Date of information release       | 2023/08/04                                                                                                                                                          |

## Additional information

|                                                          |                                                                                                                                                                                                                                                                                                        |                                                                                                                                                                                                                                                                                                                |
|----------------------------------------------------------|--------------------------------------------------------------------------------------------------------------------------------------------------------------------------------------------------------------------------------------------------------------------------------------------------------|----------------------------------------------------------------------------------------------------------------------------------------------------------------------------------------------------------------------------------------------------------------------------------------------------------------|
| Legal information                                        | The product family must be disposed according to the legislation of the country. This document is intended for use by end of life recyclers or treatment facilities. It provides the basic information to assure an appropriate end of life treatment for the components and materials of the product. |                                                                                                                                                                                                                                                                                                                |
| In case of special transportation: transportation method | No                                                                                                                                                                                                                                                                                                     |                                                                                                                                                                                                                                                                                                                |
| Recyclability potential                                  | 34%                                                                                                                                                                                                                                                                                                    | Recyclability rate has been calculated based on REEECY'LAB tool developed by Ecosystem, for components/materials not covered by the tool, data from the "ECO'DEEEE recyclability and recoverability calculation method" was taken. If no data was found a conservative assumption was used (0% recyclability). |

Schneider Electric Industries SAS  
Country Customer Care Center  
<http://www.schneider-electric.com/contact>  
35, rue Joseph Monier  
CS 30323  
F- 92500 Rueil Malmaison Cedex  
RCS Nanterre 954 503 439  
Capital social 896 313 776 €

[www.se.com](http://www.se.com)

ENVEOLI2308001\_V1

Published by Schneider Electric

© 2023 - Schneider Electric – All rights reserved

2023/08/04