

28 775 980 Product version from 3/13/2017



- rain shower 300 x 240mm
- PURE RAIN, max. flow rate 20 l/min (at 3 bar)
- Function from: 12 l/min
- with anti-scale system

Technical data:

- distance between ceiling and lower edge of the shower 165mm
- rosette 60 x 60, as required
- 1/2" connection

Notes:

| | | |
|---|-------------------------------|---------------|
|  | Chrome | 28 775 980-00 |
|  | Brushed Platinum | 28 775 980-06 |
|  | Platinum | 28 775 980-08 |
|  | Dark Chrome | 28 775 980-19 |
|  | Brushed Light Gold (PVD) | 28 775 980-27 |
|  | Brushed Durabrass (23kt Gold) | 28 775 980-28 |
|  | Matte Black | 28 775 980-33 |
|  | Brushed Gold (PVD) | 28 775 980-37 |
|  | Brushed Dark Brass (PVD) | 28 775 980-39 |
|  | Brushed Bronze (PVD) | 28 775 980-42 |
|  | Brushed Champagne (22kt Gold) | 28 775 980-46 |
|  | Champagne (22kt Gold) | 28 775 980-47 |
|  | Brushed Chrome | 28 775 980-93 |
|  | Brushed Dark Platinum | 28 775 980-99 |

Recommended miscellaneous

- Concealed wall elbow -** 35 085 970 90
- min. recess depth 90 mm
 - max. recess depth 163 mm



28 775 980 Product version from 3/13/2017

mm [inches]

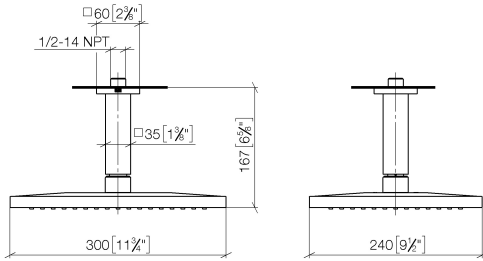

Flow rate chart

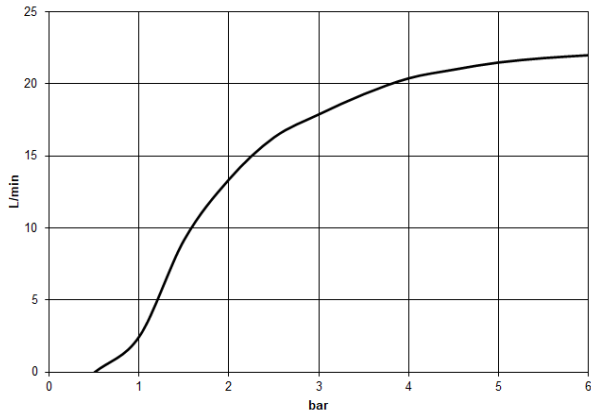

Codes & Standards

DIN 4109

ISO 3822

Scottish Water
Byelaws

UK Water Supply
Regulations

Ü-Zeichen



Rainshower with ceiling fixing 300 x 240 mm - Chrome

SERIES SPECIFIC

28 775 980 Product version from 3/13/2017

Certificates and sustainability

LGA_29

LGA_38

WRAS_2212

28 775 980 Product version from 3/13/2017

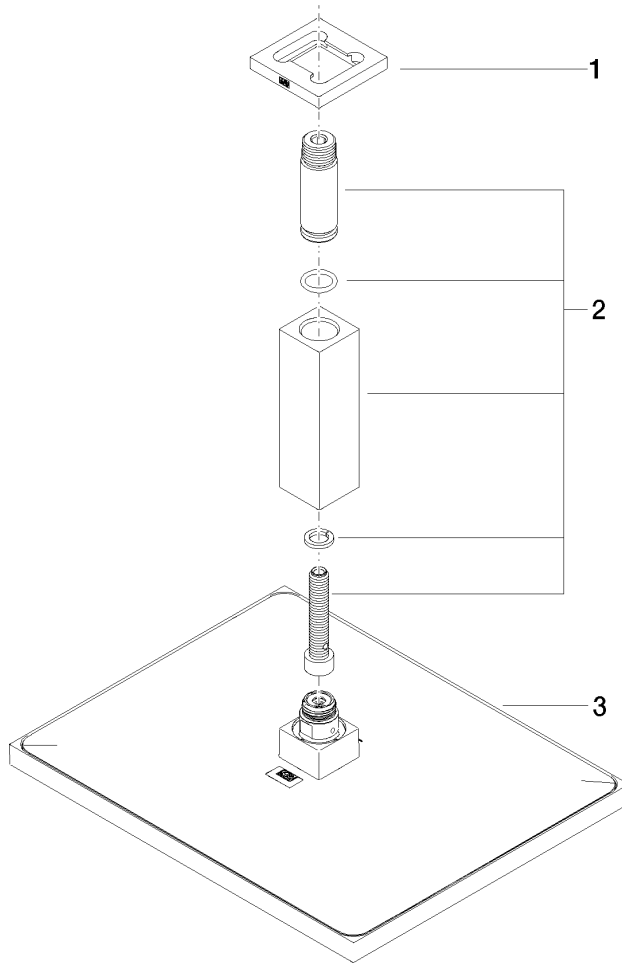

Spare parts list

| No. | Item Number | Name | Quantity used | Delivery time |
|-----|--------------------|--|---------------|---------------|
| 2 | 90 11 10 092 00-00 | Connection vertical for spray ceiling fixing 35 x 35 x 135 mm - Chrome | 1.00 | 20 |
| 1 | 09 27 98 017-00 | Rosette for rain shower Ceiling mounting 60 x 9 x 60 mm - Chrome | 1.00 | 20 |
| 3 | 04 12 05 063 00-00 | Rainshower angular 300 x 240 mm - Chrome | 1.00 | 20 |