

Technische Daten/ Technical Data

KLUDI ZENTA SL
basin mixer
DN 15

Ref.: 483930565

Finishes:
05 chrome

Product description
Manufacturer KLUDI GmbH & Co. KG
Typ: KLUDI ZENTA SL
basin mixer
Ref.: 483930565

basin mixer
3-hole mounted
solid lever, metal
aerator M24 PCA
ceramic headparts 90°
flow rate at 3 bar 5 l/min.
fixed spout
flexible hoses G3/8 DVGW approved
rapid installation set
push open waste G1 1/4
EU taxonomy: max. 6 l/min. -
Substantial Contribution (SC) possible

Produktabbildung/ Product picture



Maßzeichnung/ Dimensional drawing

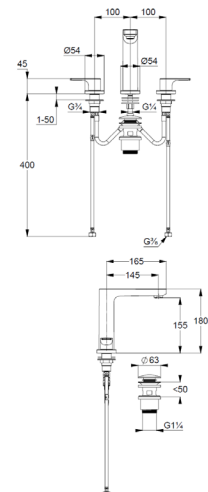

Durchfluss/ Flow rate

